



POLARIS XPEDITION 2024+

## ***TAIL LIGHT***

PLUG & PLAY MULTI-FUNCTION



# INSTRUCTION MANUAL



# RAVEK

**POLARIS XPEDITION 2024+**

**PLUG & PLAY MULTI-FUNCTION TAIL LIGHT**

Part #: 64-905

Fitment: Polaris XPEDITION 2024+

## TOOLS NEEDED:



*Side Cutter Pliers*



*Push Pin Pliers*



*Heat Gun / Lighter*



*Plastic Trim  
Removal Tool*



*Ratchet*



*10mm Deep Well Socket*

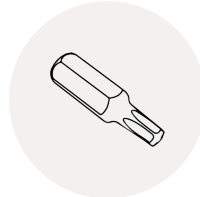

*T-30 Torx*

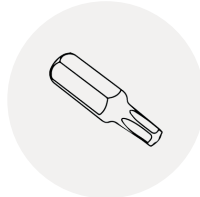

*T-40 Torx*

## PARTS INCLUDED:

- UTV Multi-function Tail Light (1x)
- Main Harness (1x)
- Tail light Harness (2x)
- Tail light Extension Harness (1x)
- Work Light Harness (1x)
- Battery Positive Harness (1x)
- Battery Negative Harness (1x)
- Rocker Switch (1x)
- Zip Tie (10x)
- Adhesive Promotor Wipe (2x)
- Rubbing Alcohol Wipe (2x)
- Heat Shrink (1x)
- Dielectric Grease (1x)

DON'T LIKE INSTRUCTIONS?

VISIT OUR WEBSITE  
TO ACCESS THE  
VIDEO TUTORIAL.



## GENERAL NOTES

- Throughout this process, be sure to keep track of any screws or fasteners you remove as they will be re-installed in the same location.
- Make sure your vehicle is off and key is out of the ignition before starting.
- Dielectric grease is provided, and you can use it for added protection.

1

## PREP THE VEHICLE

i

Remove the tilt windshield lock (if equipped) by removing the two push pins and three 10mm bolts holding the panel, using PUSH PLIERS, RATCHET, and 10MM DEEP WELL SOCKET. Once fasteners have been removed, pull up to remove the cover. [SEE FIGURE 1A]

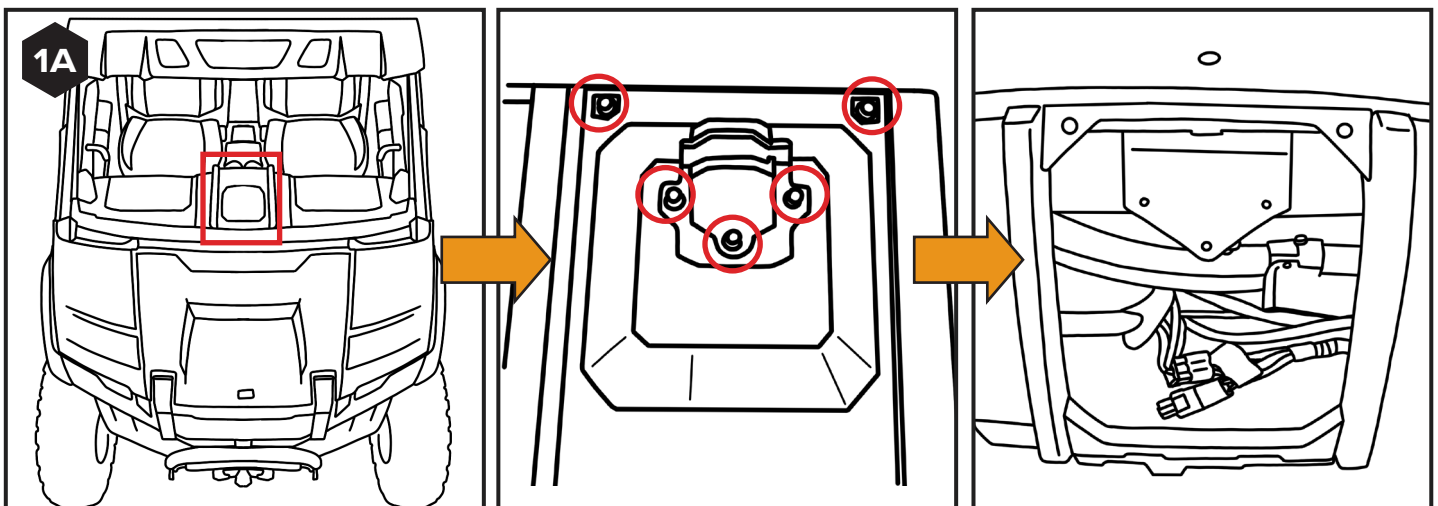



Remove the dash board screws by removing the five screws on the front end of the dash using a T-30 TORX.[SEE FIGURE 1B]

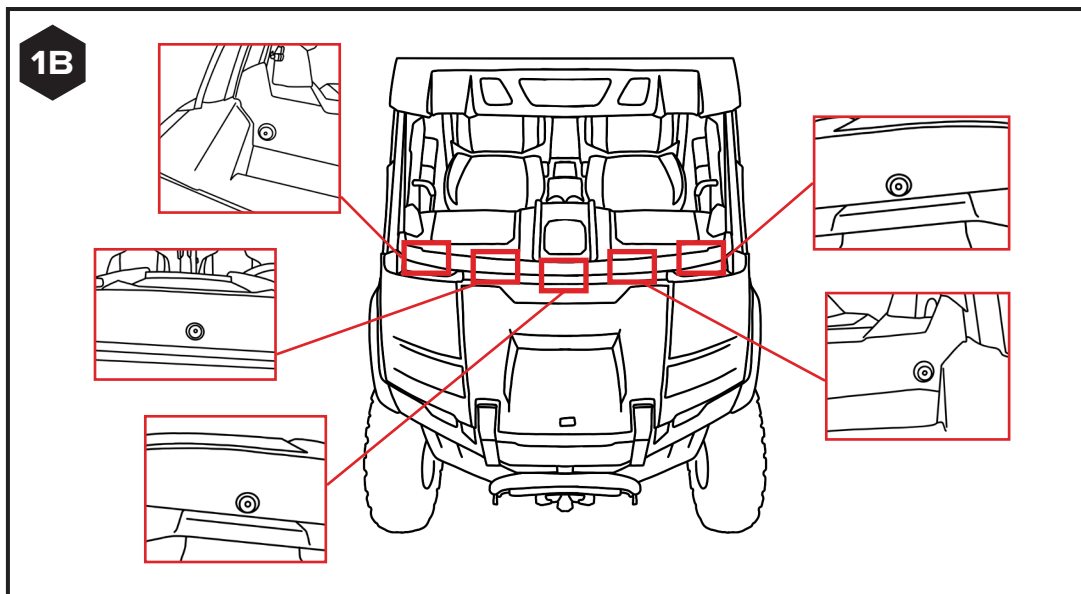

- Remove the vents and clips on the dash by opening your glove box and removing the two push pins on the top using PUSH PIN PLIERS.
- Next, remove the four vent covers by carefully prying the outside portion of them until they fully release.
- Once the vent covers are removed, remove the exposed push pins at the top of where each vent cover was. [SEE FIGURES 1C -1E]

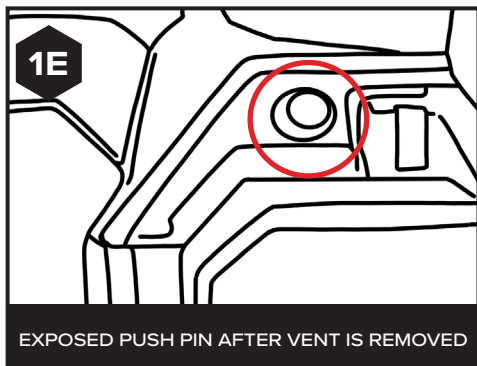
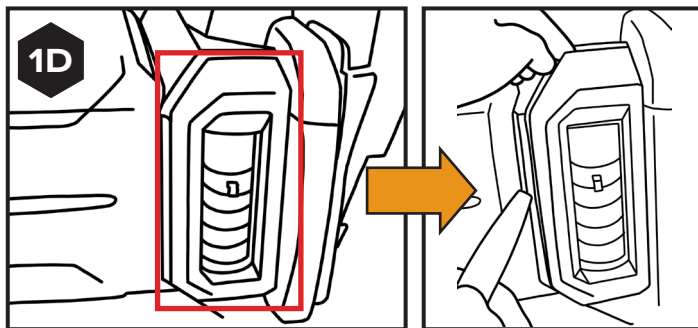
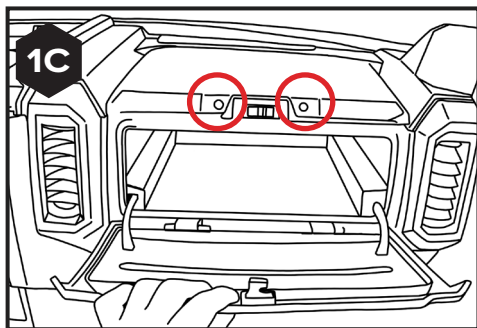

EXPOSED PUSH PIN AFTER VENT IS REMOVED

iv

Remove the door jamb hardware; remove the three push pins by the lower door hinge and the two push pins and one torx screw by the upper door hinge, using PUSH PIN PLIERS and a T-30 TORX. [SEE FIGURES 1F – 1H]

Also, remove the hidden push pin on each side located underneath the upper portion of the door jamb panel using PUSH PIN PLIERS. [SEE FIGURES 1I & 1J]

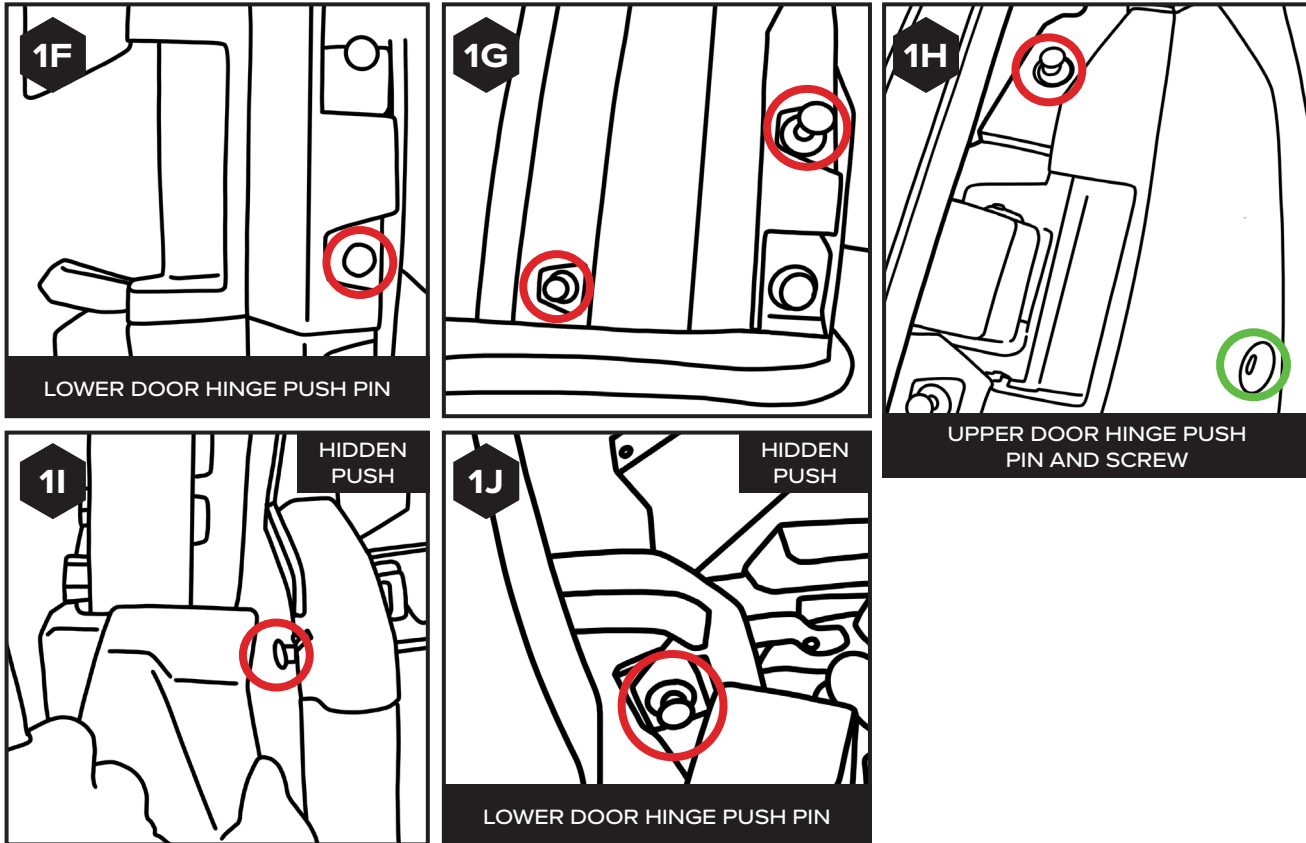

v

Remove the A-pillar cover and windshield shocks (if equipped) by removing the two torx screws and releasing the windshield shock using a SMALL FLATHEAD SCREWDRIVER to release the windshield and T-30 TORX [SEE FIGURE 1K]

**NOTE:** Be sure to carefully release the windshield shocks and support the windshield to avoid it slamming you or someone else.

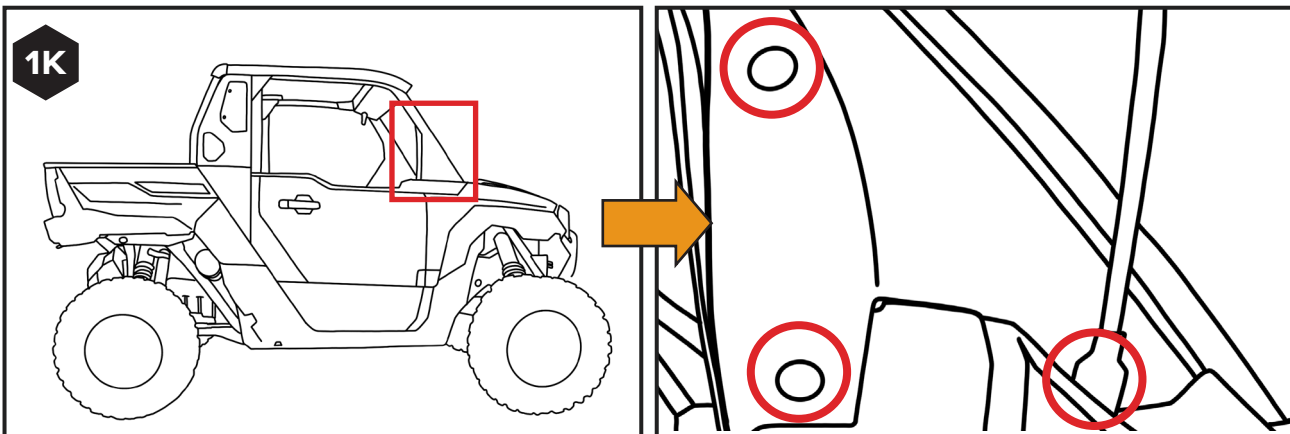

vi

Carefully remove dash and unplug the wiring for the speakers while removing it.

*NOTE: You may want to call a buddy to help you with the removal of the dash.*

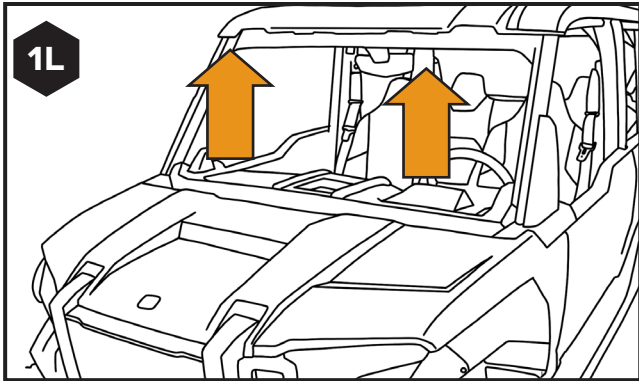

vii

Remove the drivers rear door jam panel by removing the six push pins located in the highlighted area below using PUSH PIN PLIERS. Once all push pins have been removed, carefully slide the panel out. [SEE FIGURES 1M – 1T]

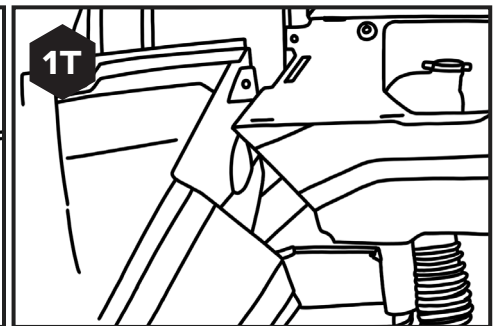
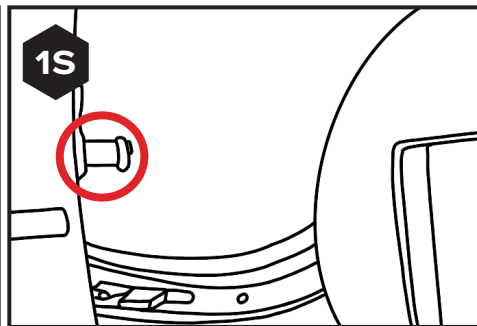
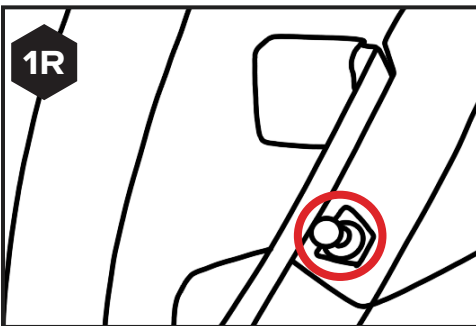
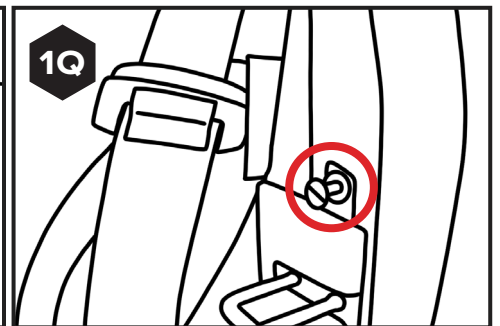
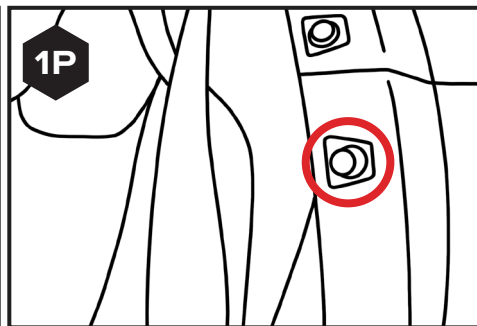
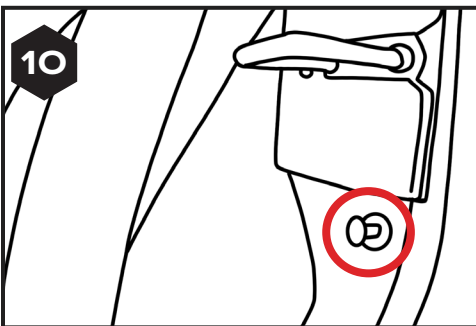
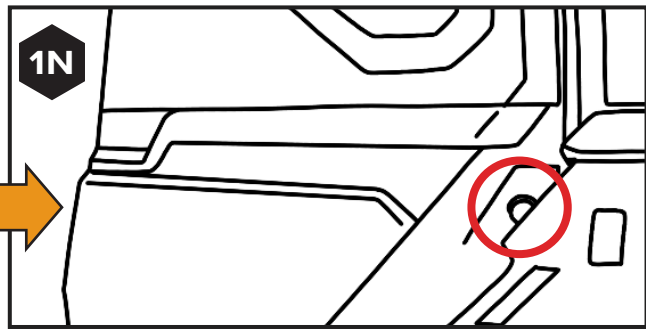
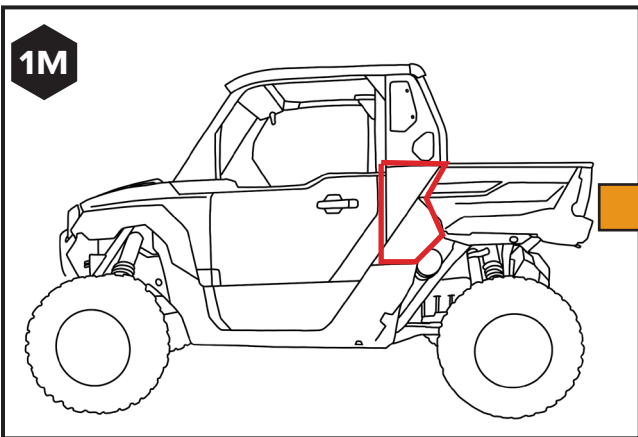

Remove the 6 push pins and 6 torx screws holding the driver's side rocker panel using T-40 TORX and PUSH PIN PLIERS. [SEE FIGURES 1U – 1CC]

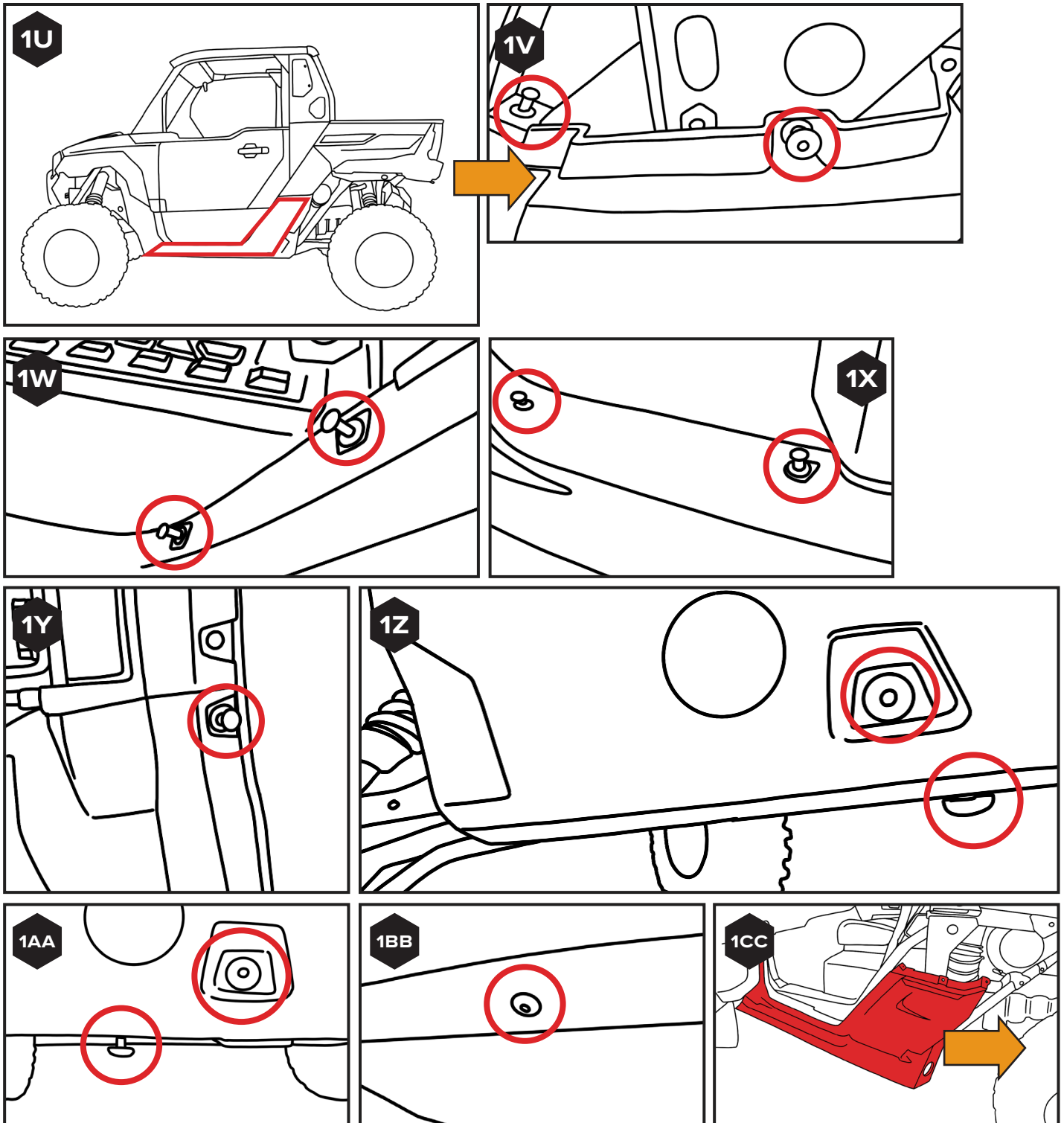



ix

Remove the dead pedal panel by removing the two torx screw using a T-40 TORX. [SEE FIGURE 1DD]

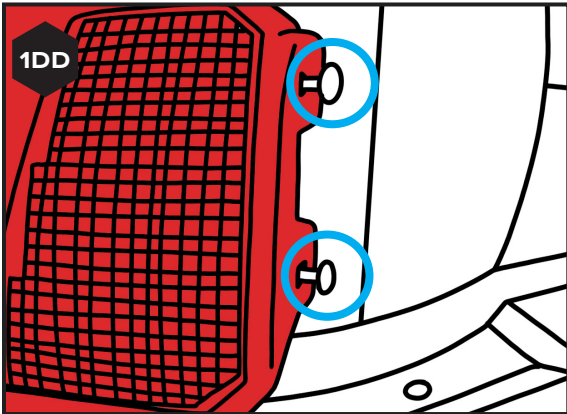

x

Remove the driver's seat using a T-40 TORX to remove the two front seat mount bracket fasteners. Then slide the seat to the forward-most position, tilt seat back, and pull up to fully remove the seat out. [SEE FIGURES 1EE & 1FF]

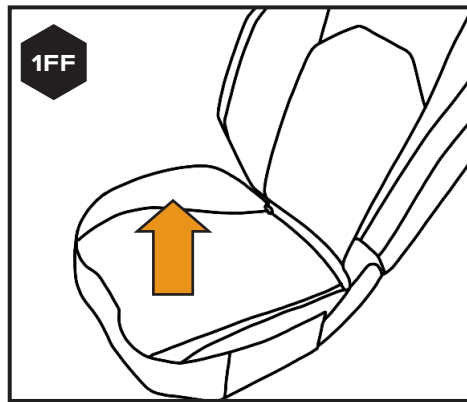
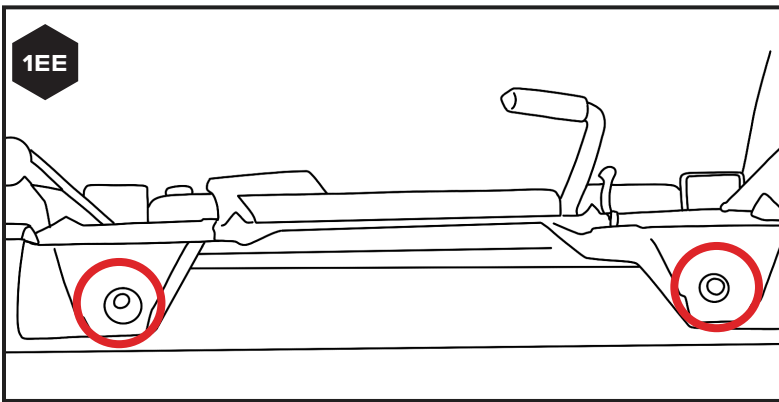

xi

Once the seat is removed, remove the battery access panel by loosening the screw on top of the panel using a FLAT HAED SCREW DRIVER. Then pivot the panel up and forward to remove. [SEE FIGURES 1GG & 1HH]

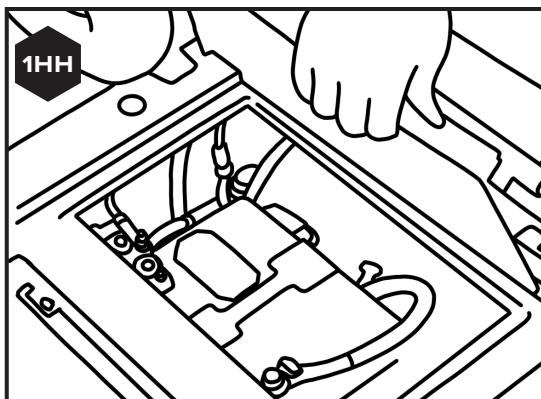
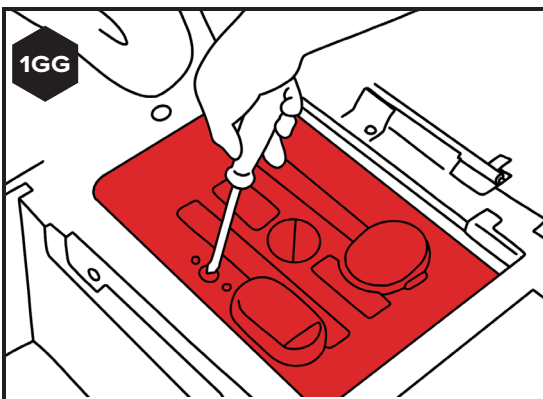



xii

Remove one rocker switch knock out from the rocker switch panel by gently prying it off using a SMALL FLATHEAD SCREWDRIVER. You'll be installing the rocker switch provided in this slot in a future step. [SEE FIGURES 1II & 1JJ]

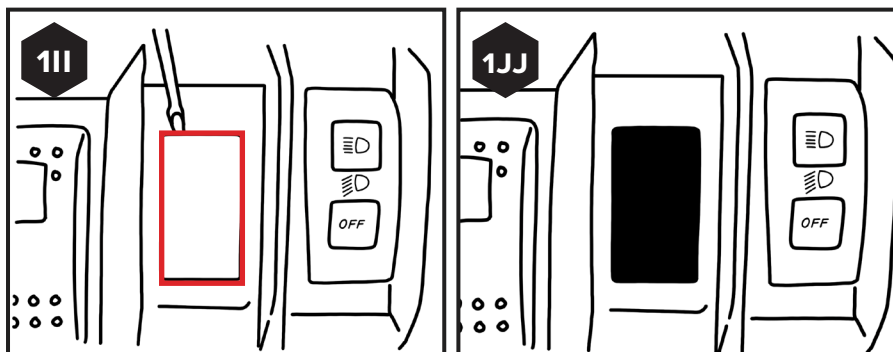

xiii

Open the tailgate and remove the taillight using a T-20 TORX to remove the two screws seen below. Unplug the stock OEM connector from your XPEDITION taillight and remove the taillight. [SEE FIGURES 1KK & 1LL]

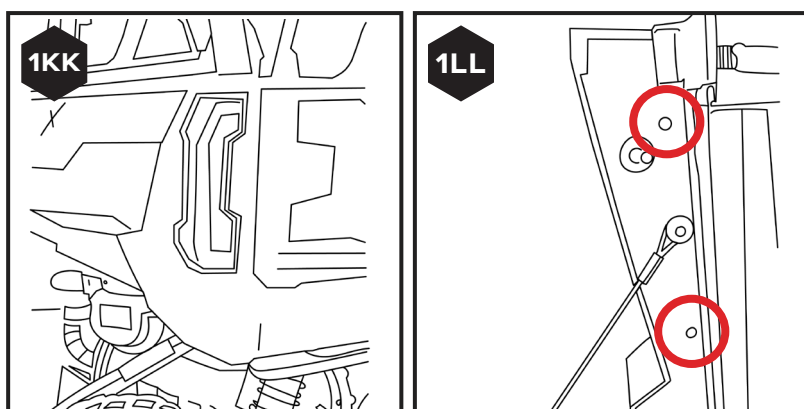

2

## MOUNT LIGHT

i

Wipe your tailgate's surface using one of the rubbing alcohol wipes provided. Let dry.

Wipe the same surface with one of the adhesive promoter wipes provided. Let dry. [SEE FIGURES 2A-2C]

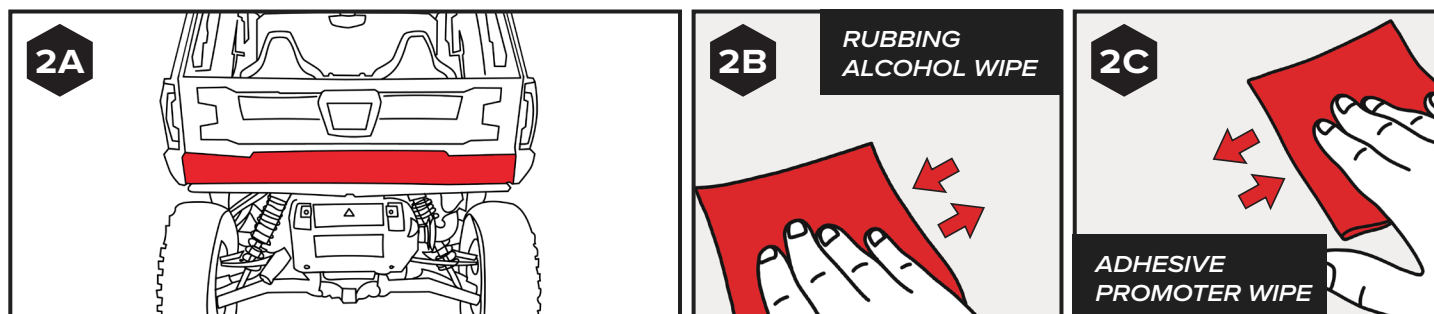



Locate the four mounting clips provided in the kit. [SEE FIGURE 2D]

Clean the back surface of the mounting clips using a rubbing alcohol wipe. Let dry. [SEE FIGURE 2E]

Wipe down the surface of the mounting clips with the adhesive promoter wipe. Let dry. [SEE FIGURE 2F]

Place the double sided tape on to the back surface of the mounting clips and place them on the back of the light. [SEE FIGURE 2D - 2I]

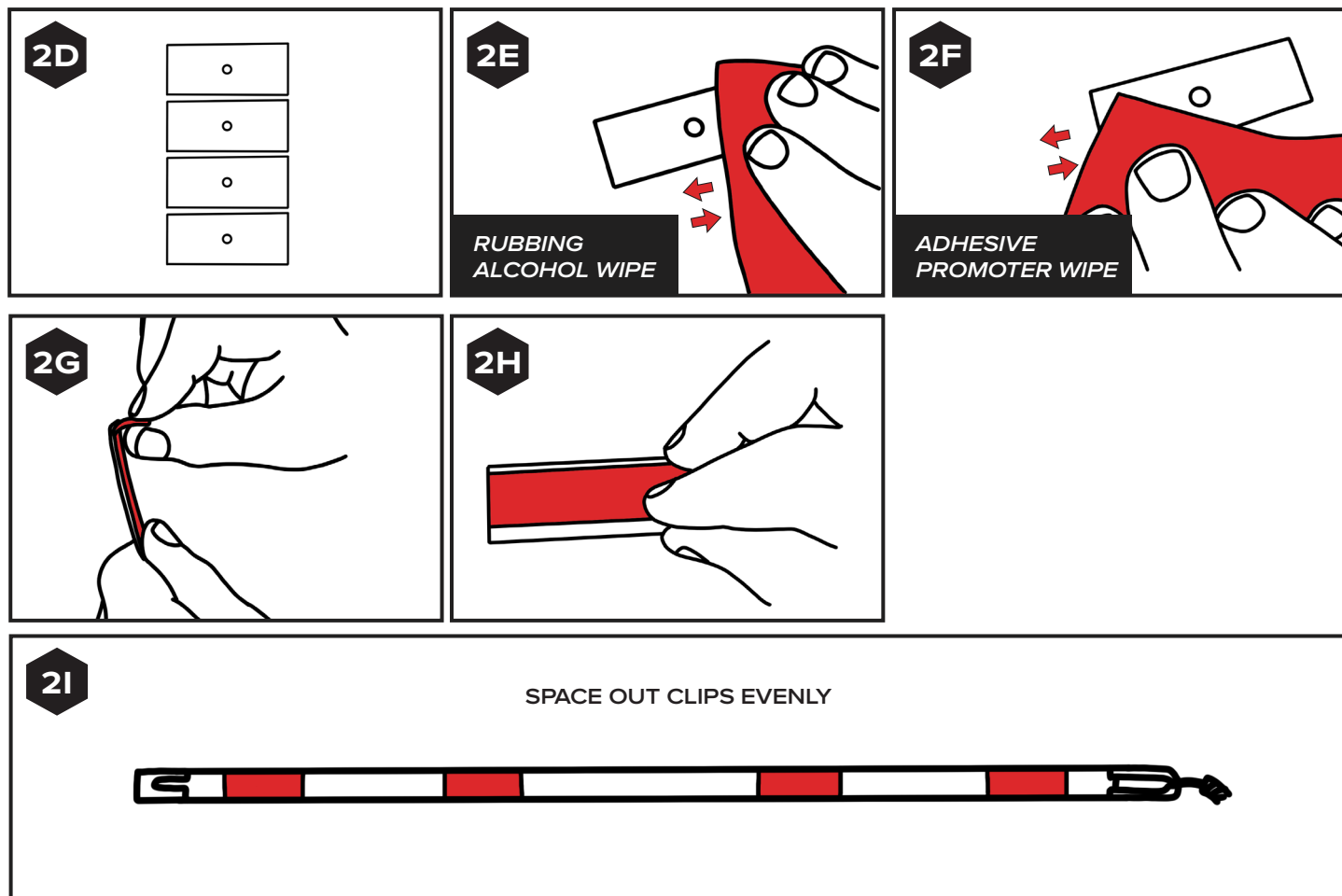

Peel off the double sided tape protective film and stick the light to the clean tailgate surface. [SEE FIGURE 2J]

**NOTE:** Install the light so the RAVEK logos on the end caps are right side up. [SEE FIGURE 2K]

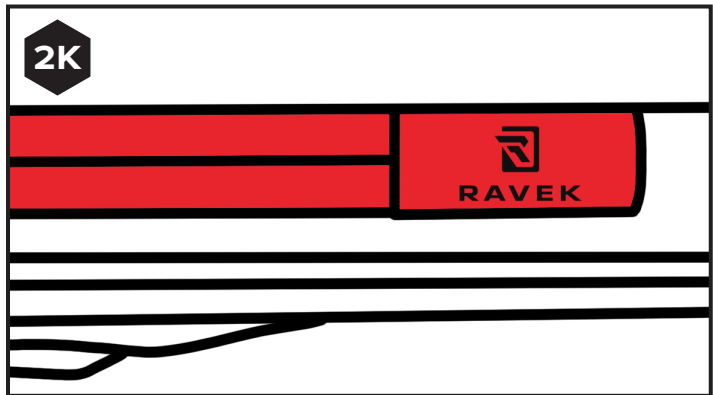
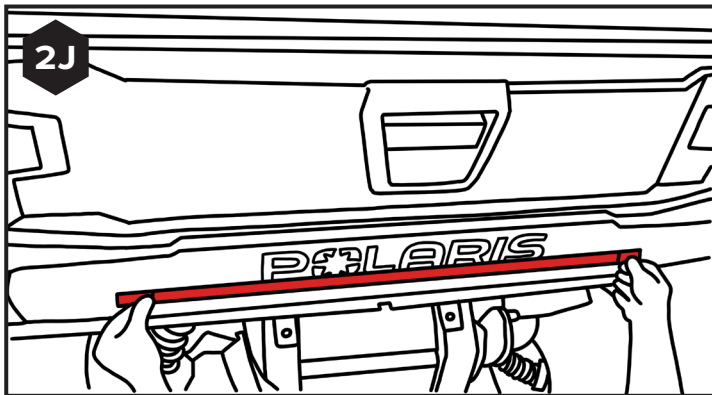

### 3 MAKE YOUR CONNECTIONS



Grab both of your Tail Light Harnesses and plug them in line to your OEM tail light and harness. [SEE FIGURE 3A]

**NOTE:** If additional accessories are plugged into the tail light already, connect the Multi-function Tail Light Harness closest to the OEM tail light.

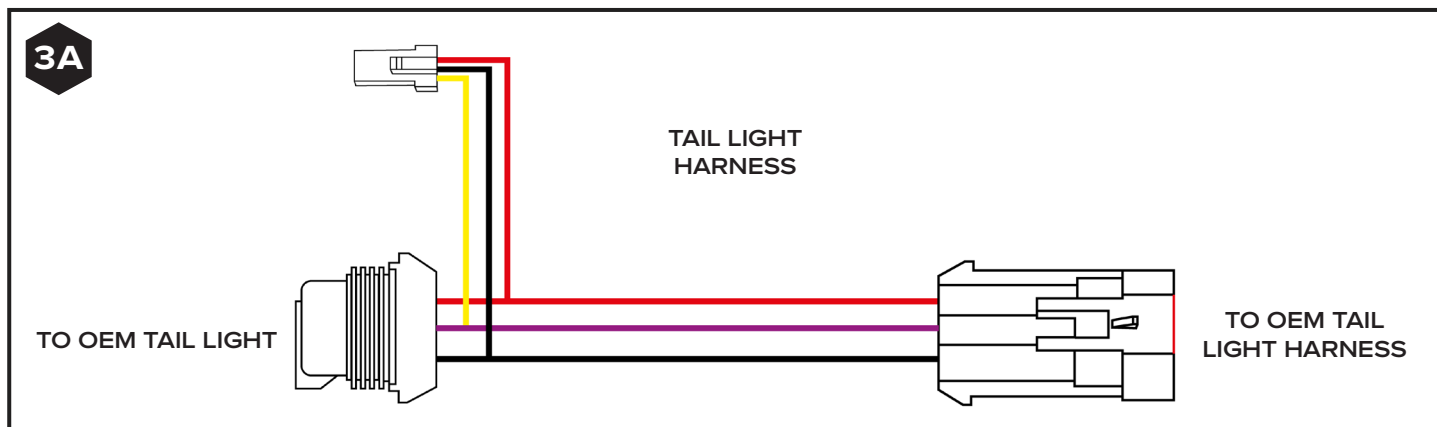

Grab your Tail Light Extension Harness and plug in each labeled connector to the corresponding Tail Light Harness, routing the Tail Light Extension Harness underneath the tailgate. [SEE FIGURES 3B-3E & DIAGRAM A]

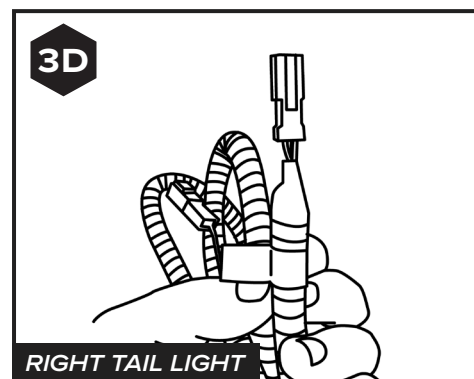
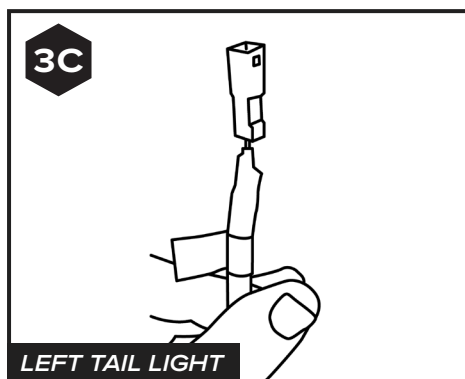
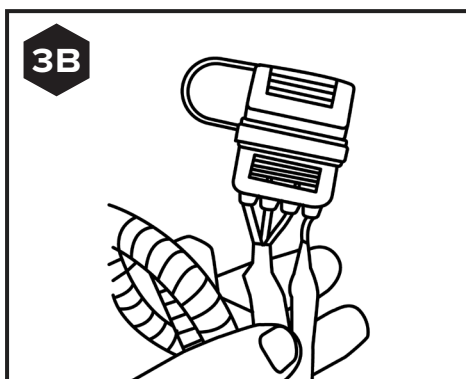

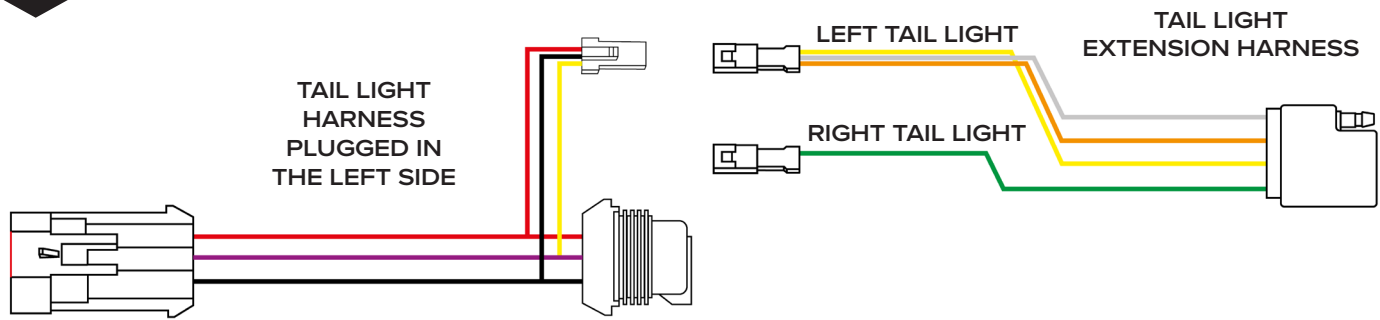
**3E****iii**

Set your Main Harness (harness with the controller box) in the engine compartment and make the following connections [SEE FIGURES 3F – 3H]:

- Plug in the 1-pin connector coming out the white wire on the Main Harness to the Work Light Harness (harness with relay)
- Plug in the trailer connector coming out the Main Harness to the connector on the Tail Light Extension Harness on the middle of the Xpedition
- Plug in the 4 pin connector coming out the Main Harness to the connector on the light connector on the light to the left side of the Xpedition

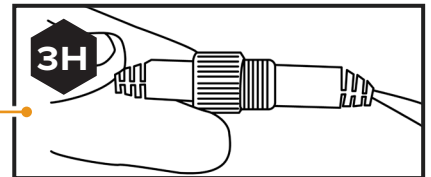
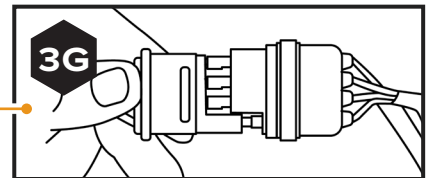
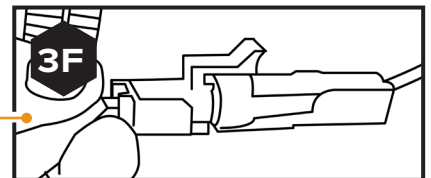
**4**

## HOOK UP ROCKER SWITCH

**i**

Grab both your Battery Negative and Battery Positive Harnesses. Hook the ring terminal to the corresponding accessory battery terminal and re-install 10mm nut on positive and negative battery terminals. [SEE FIGURES 4A & 4B]

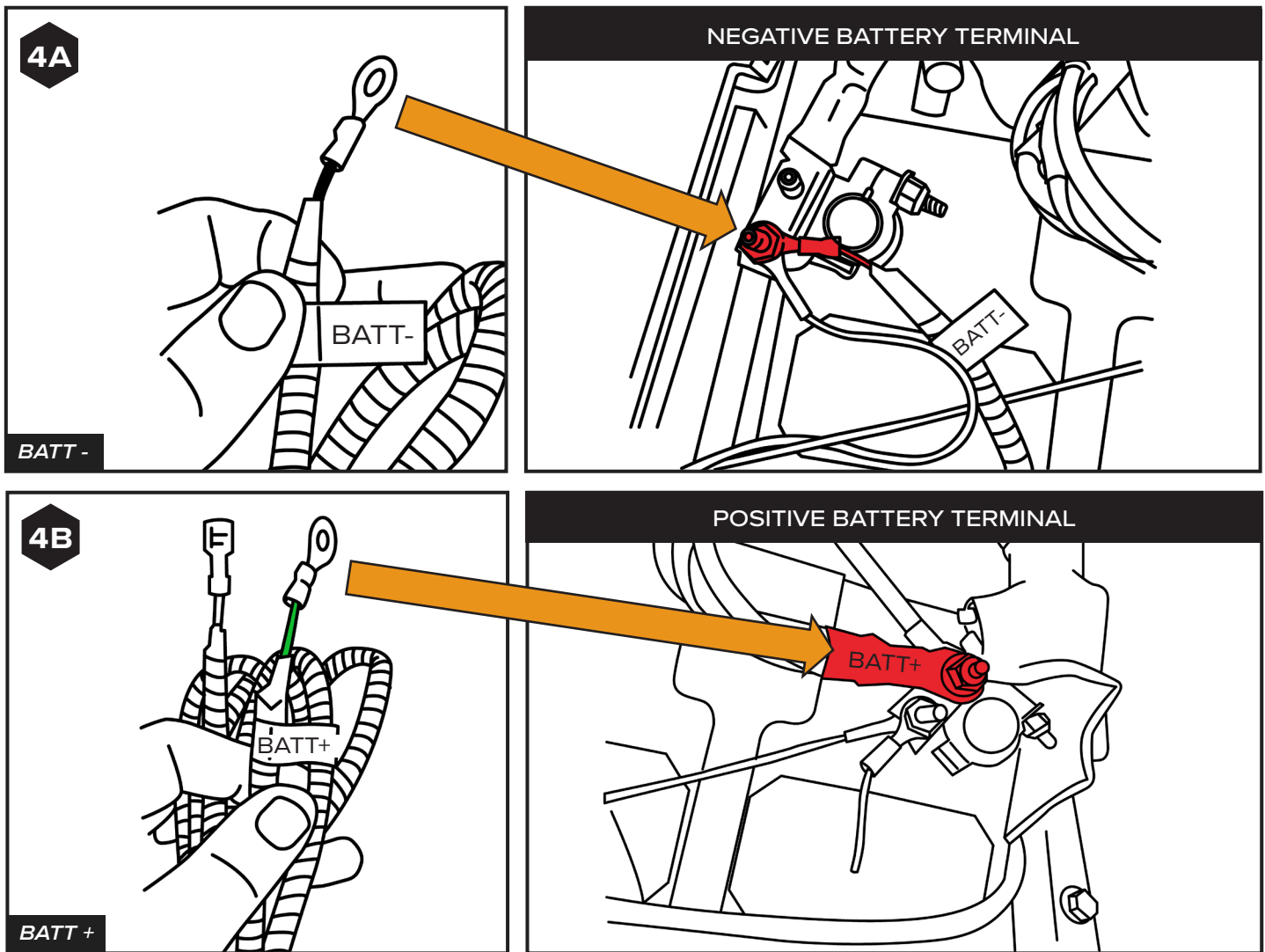

Grab the red spade connector on the Work Light Harness, the two black spade connectors from the Battery Negative Harness, and the green spade connector from the Battery Positive Harness, and bundle all four spade connectors together.

Route all four spades to the open rocker switch location referenced in step 1.i. [SEE FIGURES 4C-4F & DIAGRAM A]

**NOTE:** Be sure to keep all wiring away from hot or moving components.

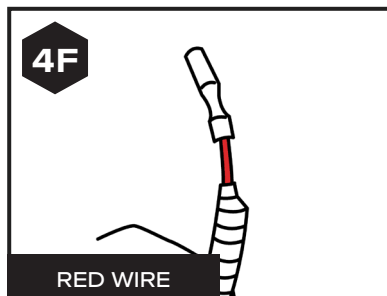
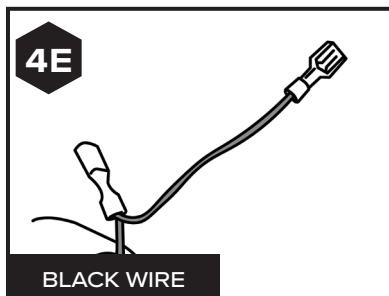
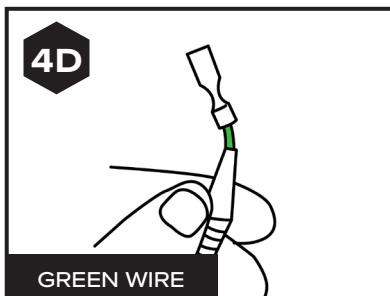
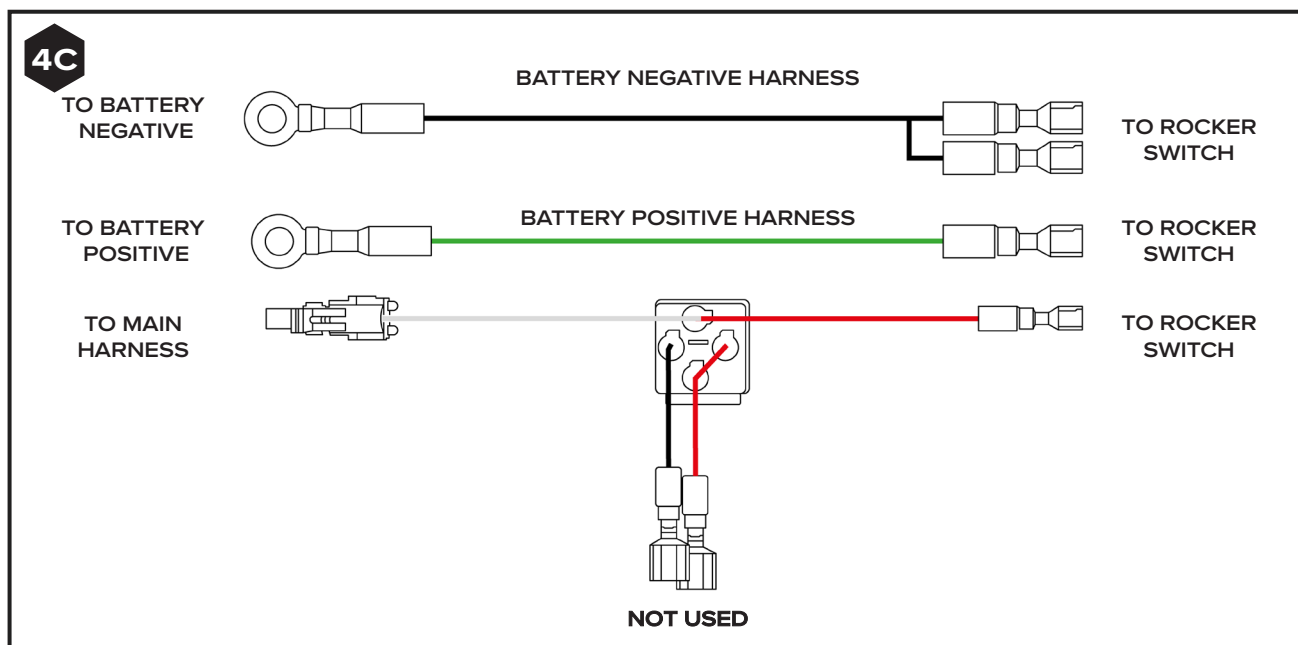

Reference diagram below to connect each spade connector to the appropriate spade terminal on the backside of the rocker switch.

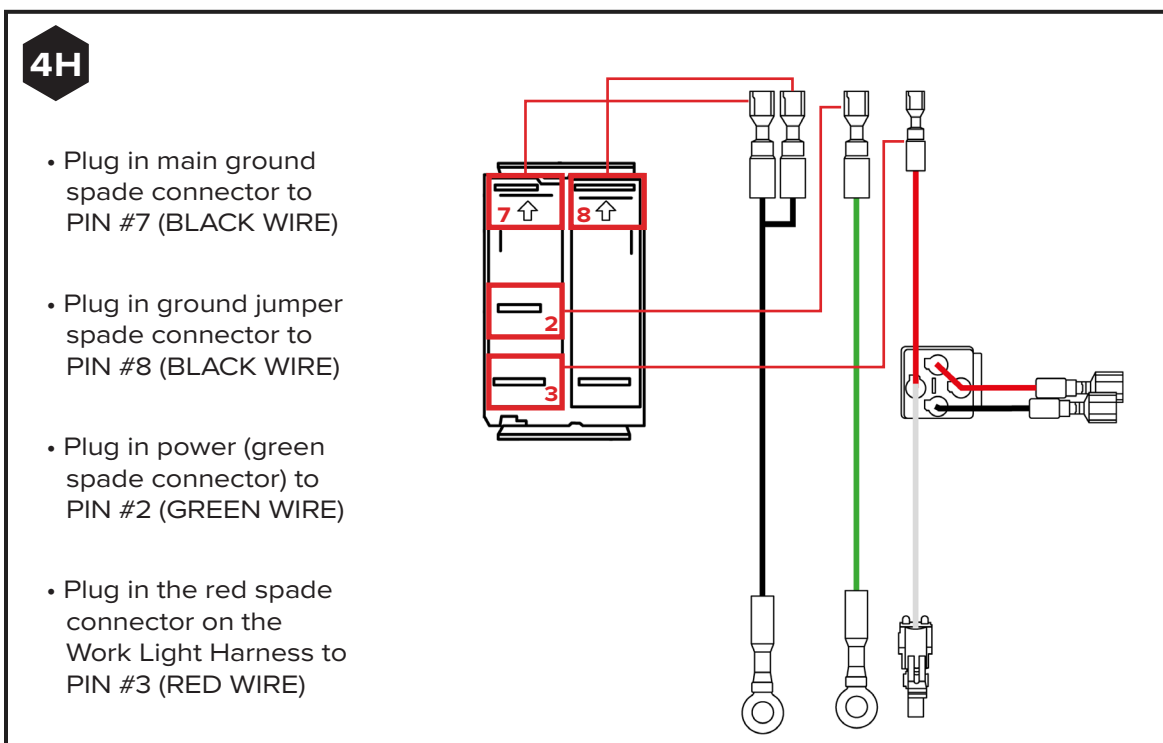





Now is time to confirm light works as designed:

- Red Running Light
- Brake Light
- White Work Light (with vehicle on or off)

***NOTE: If you have a turn signal kit hooked up to your Xpedition; verify the turn signal feature built in to the light.***



## TIDY UP YOUR MACHINE



Go over all your wiring and secure it to the different frame tubes and OEM harnesses. [REFERENCE DIAGRAM A FOR OVERVIEW OF WIRING]

***NOTE: Stay away from hot or moving components.***



Once all of your wiring is secured with the help of the zip ties, cut all the excess zip ties using side cutter pliers.



With your wiring neatly routed and secured to the Xpedition, reverse steps 1.i. - 1.xiii. to reinstall the different Xpedition components.



**RAVEK**  
BUILT FOR MORE

## WHY RAVEK

Stock UTVs don't come with enough storage, lighting, comfort, and protection. That's why we started RAVEK.

We live to design, manufacture, and test innovative SxS upgrades that elevate the riding experience. Here's what you can expect from us:

- Durable products built to last (100% lifetime guarantee)
- UTV upgrades thoughtfully designed & tested by riders
- Outstanding installation support (videos & USA customer service)
- Constant flow of epic riding content (check out our social media)

We're confident your RAVEK product will earn its place on your machine. Please call or e-mail us if we can help.

- Harry & Ricky (Brothers & Owners)

## MESSAGE FROM THE DESIGNER

When I designed the UTV Multi-function Tail Light, I thought about all the aspects a UTV rider needs: added visibility, sleek look, and easy installation. This product checks all the boxes, which is why I love it. It makes your machine look meaner and makes you and your ride crew safe at night on the trails.