



# RAVEK

POLARIS GENERAL 2021+

## ***APEX LIGHTS***

REAR RED



# INSTRUCTION MANUAL



# RAVEK

POLARIS GENERAL 2021+

## **APEX LIGHTS - REAR RED**

Part #: 64-702

Fitment: POLARIS GENERAL 2021+

### **TOOLS NEEDED: \*OPTIONAL**



Side Cutter Pliers



3mm Allen Wrench



4mm Allen Wrench

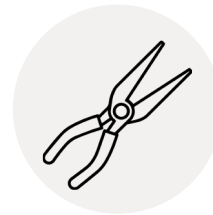

Needle Nose Pliers



Heat Gun/Lighter



T-30 Torx



T-40 Torx

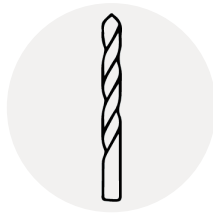

11/32" drill bit\*

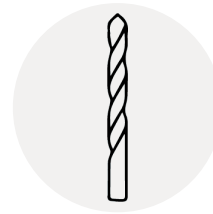

1/4" drill bit\*



Drill\*

### **PARTS INCLUDED:**

- Apex Light (2x)
- Power Harness (2x)
- Extension Harness (2x)
- Roll Bar Adapter (2x)
- Strap (2x)
- Zip Tie (8x)
- Double Sided Tape (2x)
- Pulse Modulator (2x)
- Taillight Harness (2x)
- M6 Flat Washer (2x)
- M5 x 0.8 x 6mm Allen Screw (4x)
- M6 x 1.0 x 10mm Allen Screw (2x)
- Adhesive Promoter Wipe (2x)
- Rubbing Alcohol Wipe (2x)
- Dielectric Grease (1x)
- Heat Shrink (1x)

**DON'T LIKE INSTRUCTIONS?  
VISIT OUR WEBSITE  
TO ACCESS THE  
VIDEO TUTORIAL.**



*NOTE: Dielectric grease is provided in each kit. We've engineered sealed connectors but we still recommend applying a small dab of dielectric grease on each connection point for added protection.*

*NOTE: Make sure your vehicle is off and key is out of the ignition before starting.*

**1**

### UNPLUG TAILLIGHT

Starting from the right side, remove the side cover using a T-40 TORX to remove the screw, then gently pull the panel away from the UTV to completely remove panel and expose more fasteners [SEE FIGURE 1A]

With the side cover removed, remove the four exposed screws behind where the side cover was, use a T-40 TORX [SEE FIGURE 1B]

Underneath the fender, by the dump lever, remove the three screws holding the fender from underneath the UTV using a T-30 TORX. [SEE FIGURE 1C]

Open the tailgate and remove the two screws by the taillight using a T-30 TORX. [SEE FIGURE 1D]

With all the hardware removed, gently pull the fender away from the vehicle to access the back side of the taillight and harness, and plug in the Apex Light Taillight Harness in-line. [SEE FIGURES 1E & 1F]

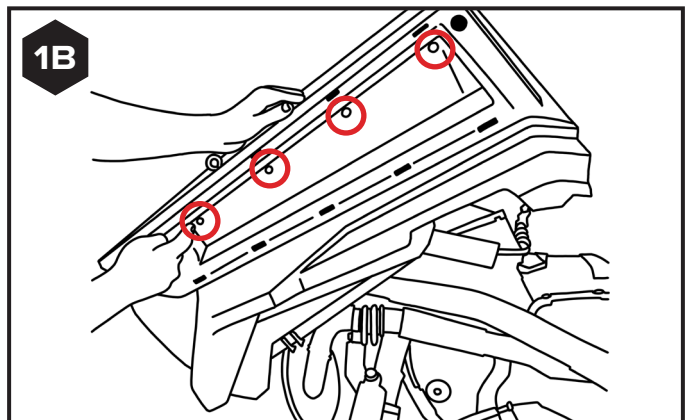
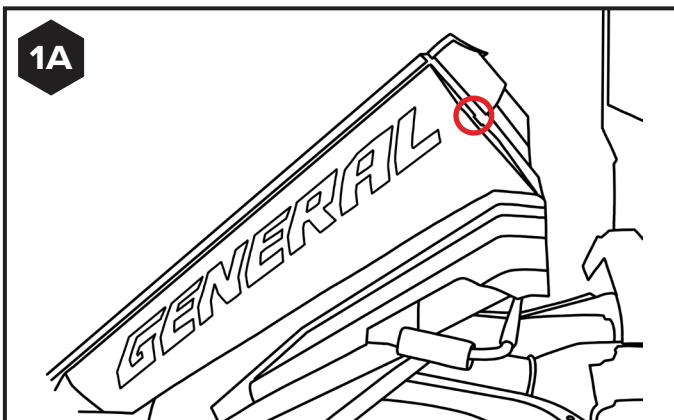

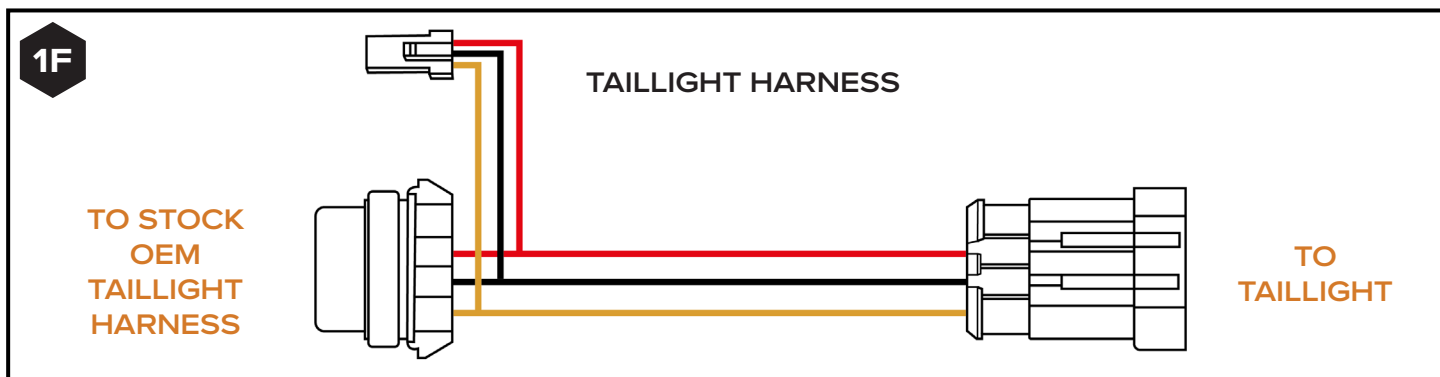
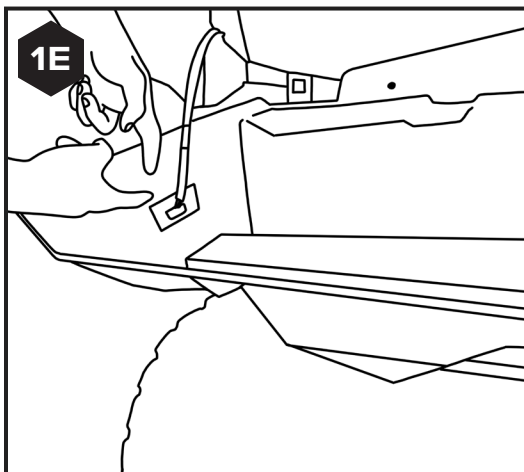
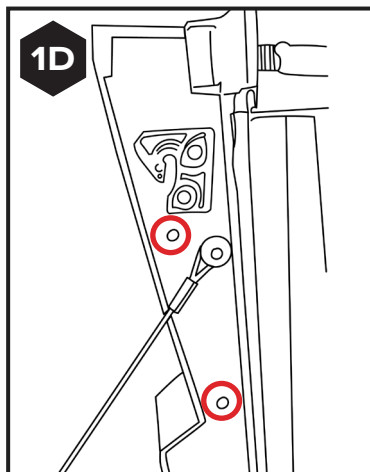
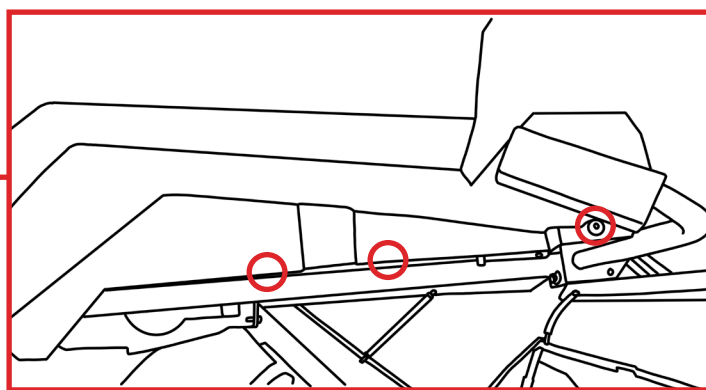
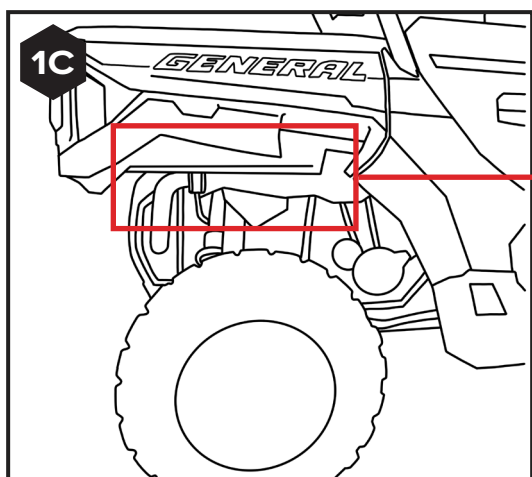

## 2

### REMOVE HEAT SHIELDS

Use a T-30 TORX wrench to remove the seven screws that hold in place the big heat shield and remove the two screws that hold the small heat shield in place. [SEE FIGURE 2A]

**NOTE:** Removing both heat shields is crucial for proper wire routing in future steps.

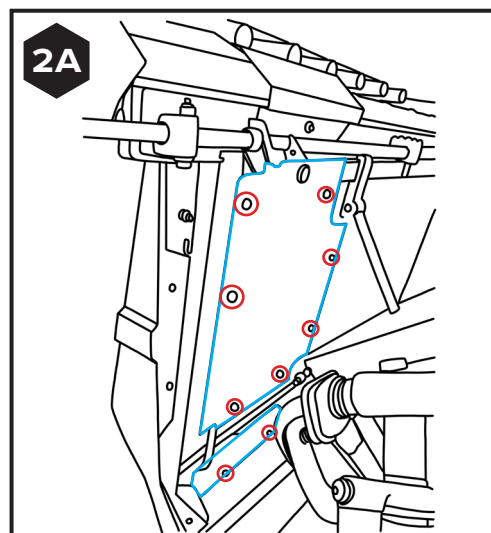

### 3

## HEAT SHRINK YOUR CONNECTIONS AND EXTRA CONNECTORS

As you make plug & play connections, use the heat shrink tubing, provided to protect your connections from dirt on the trails.

Go over the connection points you make and cut 2" of heat shrink for each. Use a lighter or heat gun to shrink the tubing. [SEE FIGURES 3A - 3G]

### HEAT SHRINK CONNECTIONS

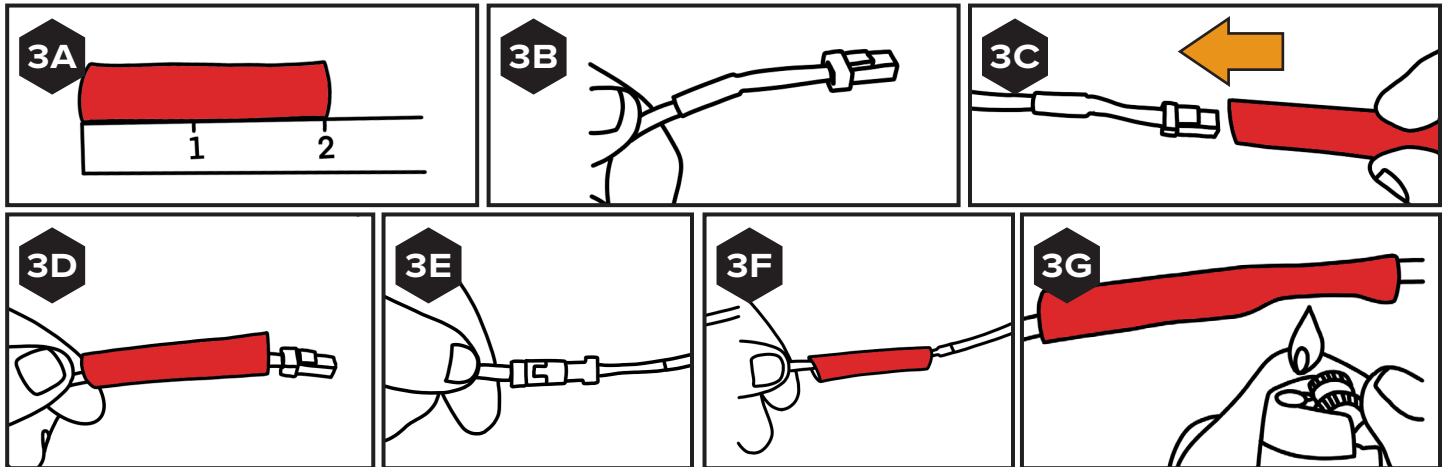

For the unused extension harness connectors (mentioned in the next step) cut 1.5" piece of heat shrink tubing, slide it over the connector and heat shrink it using a lighter or heat gun. Use needle nose pliers to pinch the end of the extra heat shrink. This will act as a cap to protect the connectors from getting dirt inside. [SEE FIGURES 3H - 3L]

### HEAT SHRINK EXTRA PLUGS

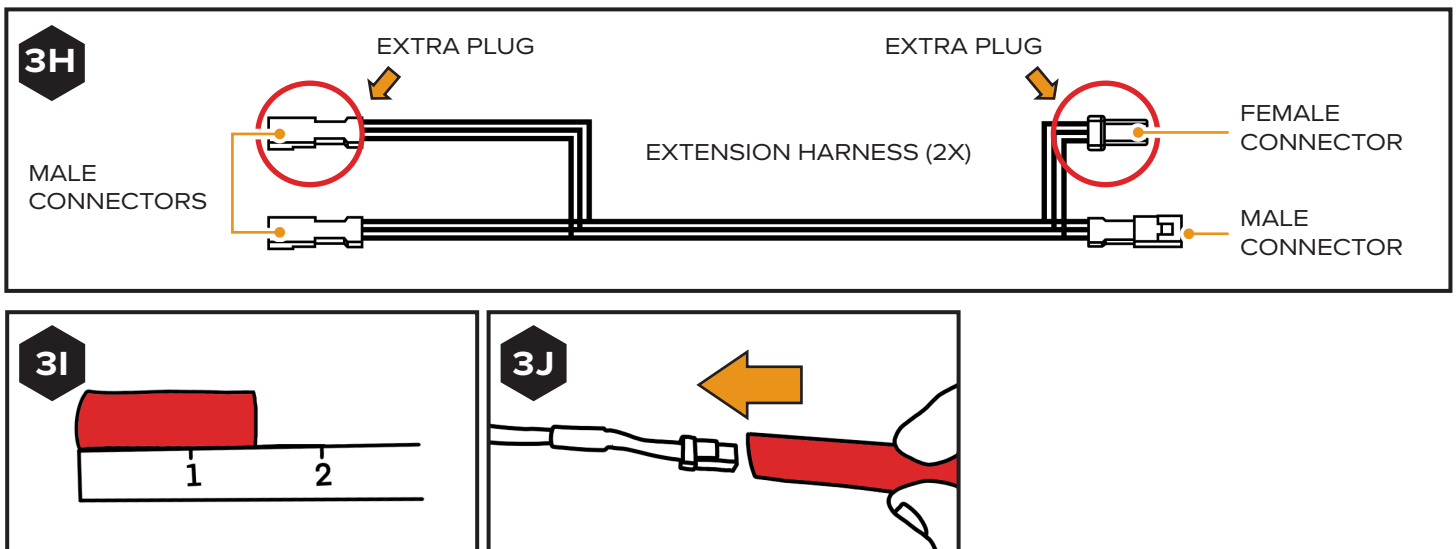

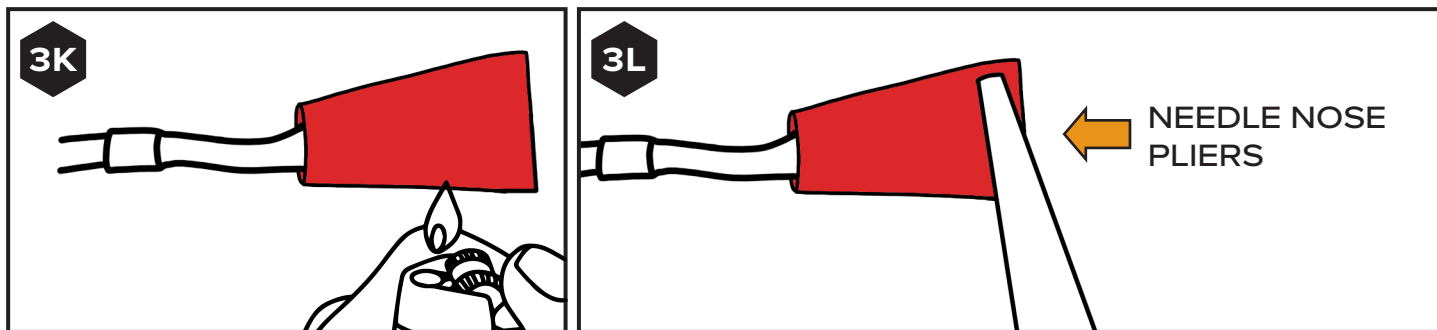

**4**

## PLUG IN PULSE MODULATOR

Plug in your pulse modulator to the Apex light taillight harness. [SEE FIGURE 4A]

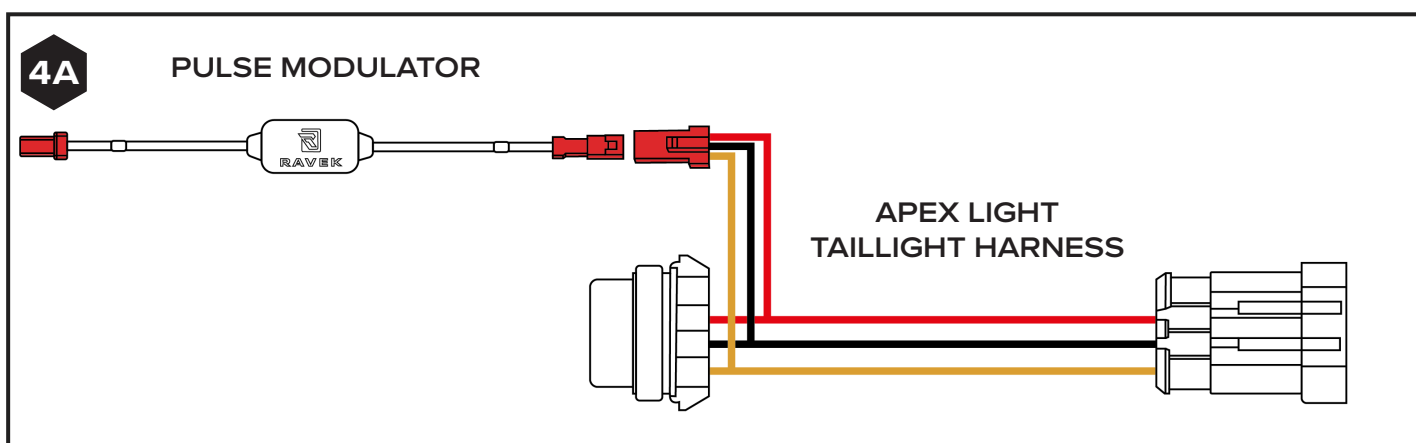

**5**

## PLUG IN EXTENSION HARNESS

Plug in your extension harness to the pulse modulator. [SEE FIGURES 5A]

*NOTE: Extension harnesses supplied come with extra connectors to easily add more Apex Lights, as seen in the circled connectors in FIGURE 5A.*

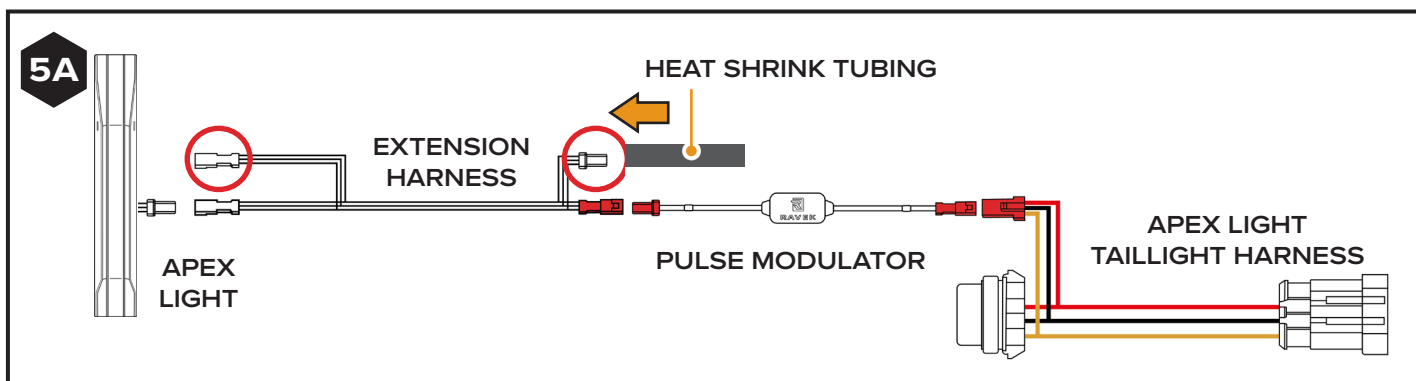

## 6

## SELECT LOCATIONS FOR APEX LIGHTS

Your options include:

- **Exterior Body Panel**  
*Any exterior panel with 8" of flat surface for mounting*
- **Roof Mounting**
- **Roll Bar/Bumper Mounting**

Check out the video to the right (see QR code) for a 50 second walkthrough of the different Apex Light mounting options.



## 7

## ROUTE WIRING

With your extension harness plugged into the taillight harness, choose your mounting location on the General. Route your extension harness from the brake light to your mounting location.

**NOTE:** We suggest you leave slack in wires until end of install when wires can be secured with wire ties provided. Route all wiring away from moving or hot components.

## 8

## READY TO MOUNT APEX LIGHT

Once you have routed your extension harness you are now ready to mount your Apex Lights.

If you have chosen to mount your Apex Lights to a roll bar or bumper, you will follow the Roll Bar mounting steps detailed in step 8A.

If you have decided to mount your Apex lights to either an exterior panel or to your roof, you now have to decide whether you want to mount your Apex lights via:

- Adhesive mount (i.e. no drill) → follow step 8B**
- Drill-mount for increased security → follow step 8C**

## OPTION A DIAGRAM - ROLL BAR MOUNTING

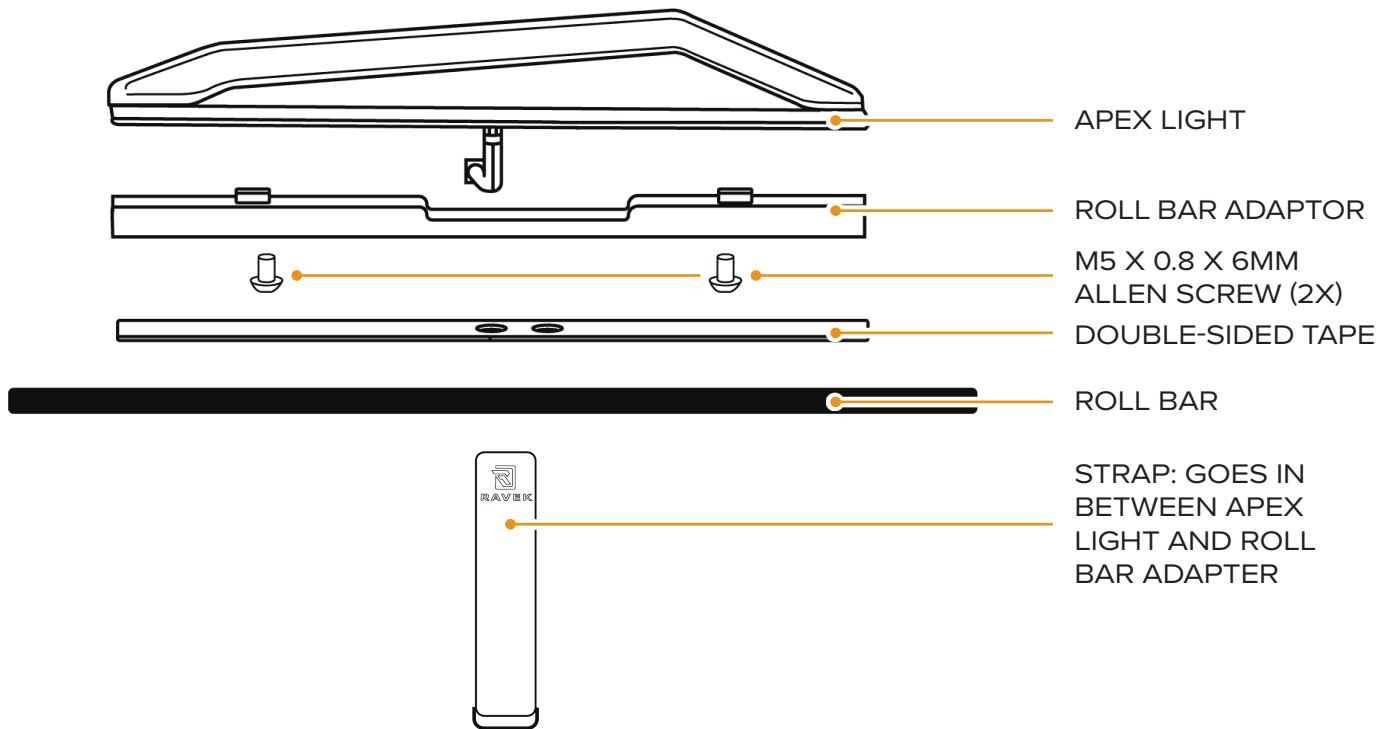

## i

**INSTALL ROLL BAR ADAPTOR**

Install the roll bar adaptor to the base of the light by using two of the M5 x 0.8 x 6mm Allen Screws with a 3MM ALLEN WRENCH. [SEE FIGURES A - C]

**NOTE:** Select which side you would like your wire to exit the light that allows you to best hide your wires.

A

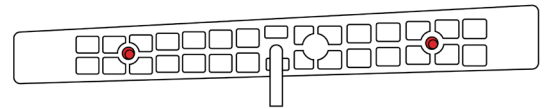

B

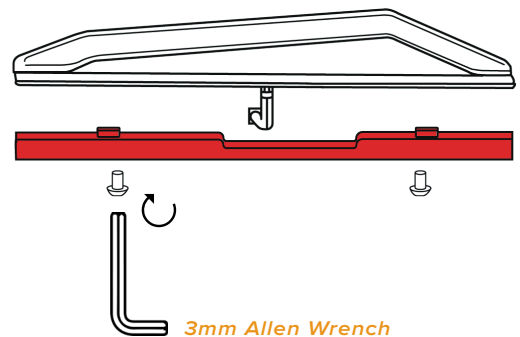

C

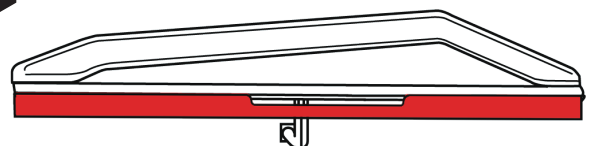



**ii**

## INSTALL STRAP

Once the roll bar adapter is secured to the light, install the strap provided through the opening between the light base and the roll bar adapter. [SEE FIGURES D & E]

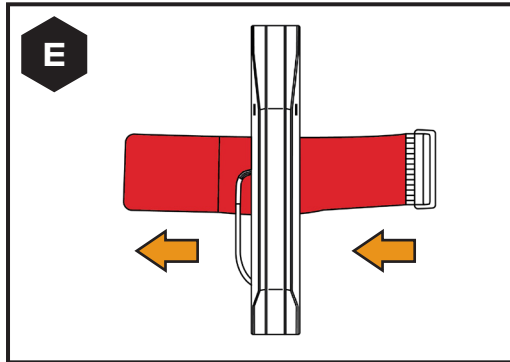
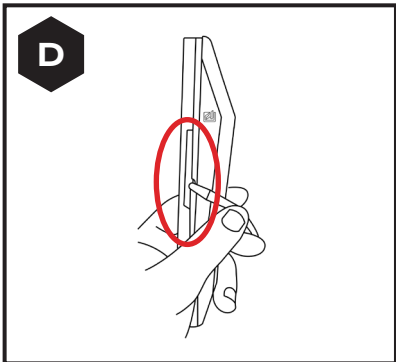
**iii**

## WIPE DOWN SURFACES

Before you permanently install your Apex light to the UTV's roll bar you've chosen, wipe down the roll bar and the base of the light with the rubbing alcohol wipe provided and let dry.

Next wipe down the roll bar and light base with the adhesion promoter wipe provided. Let dry. [SEE FIGURES F - J]

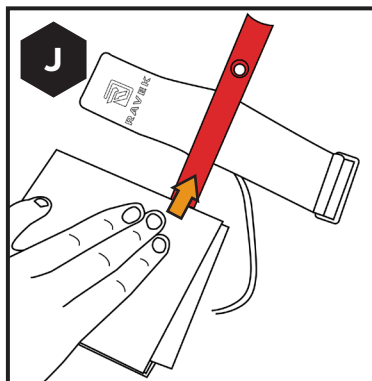
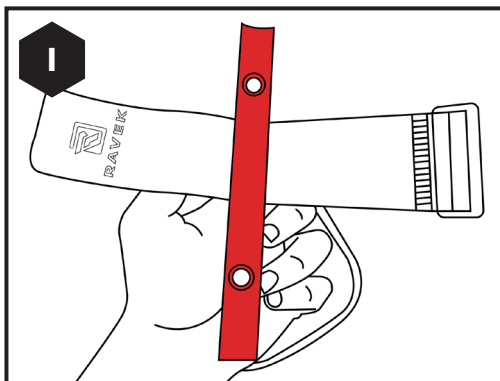
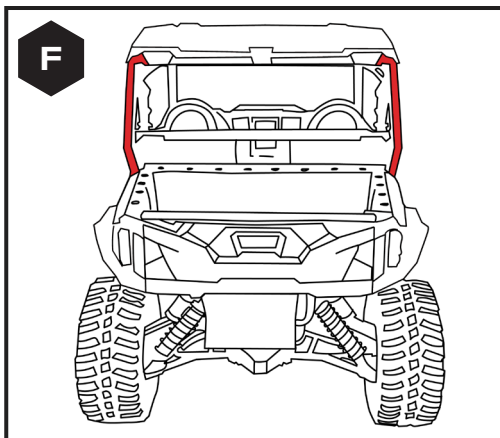

iv

## APPLY TAPE

Apply the double-sided tape to the dry Apex light's roll bar adapter, and attach the light to the surface you cleaned and prepared in the prior step. [SEE FIGURES K - N]

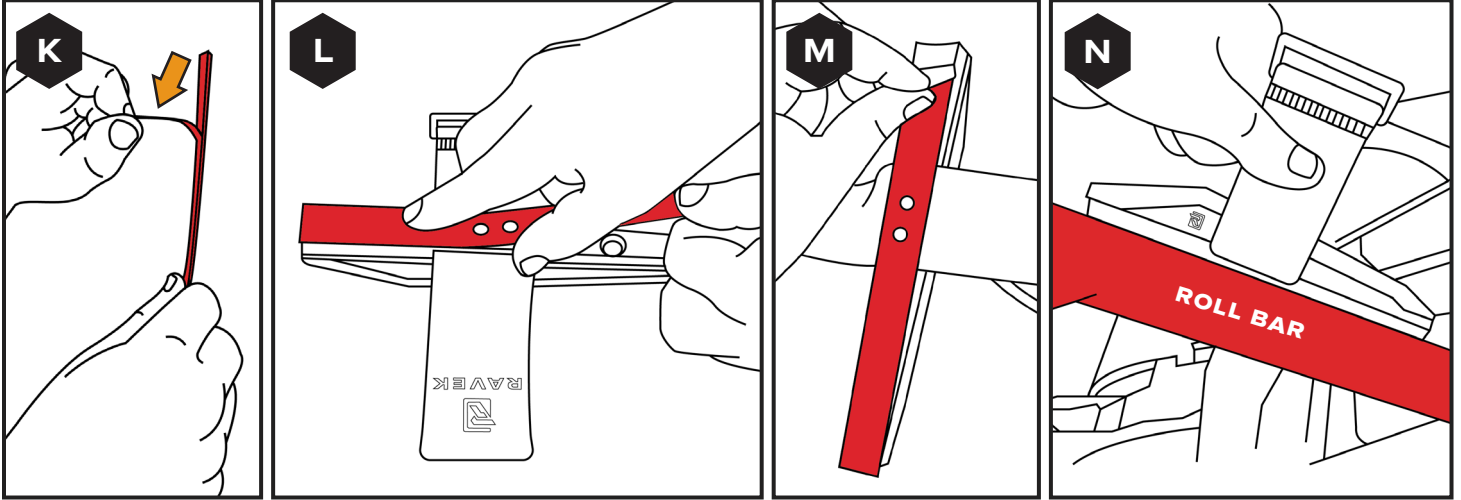

v

## TIGHTEN STRAP

Tighten straps onto base and roll bar. [SEE FIGURES O & P]

**NOTE:** If you have excess length of strap you can rotate the buckle away from the slack to reduce the slack in the strap.

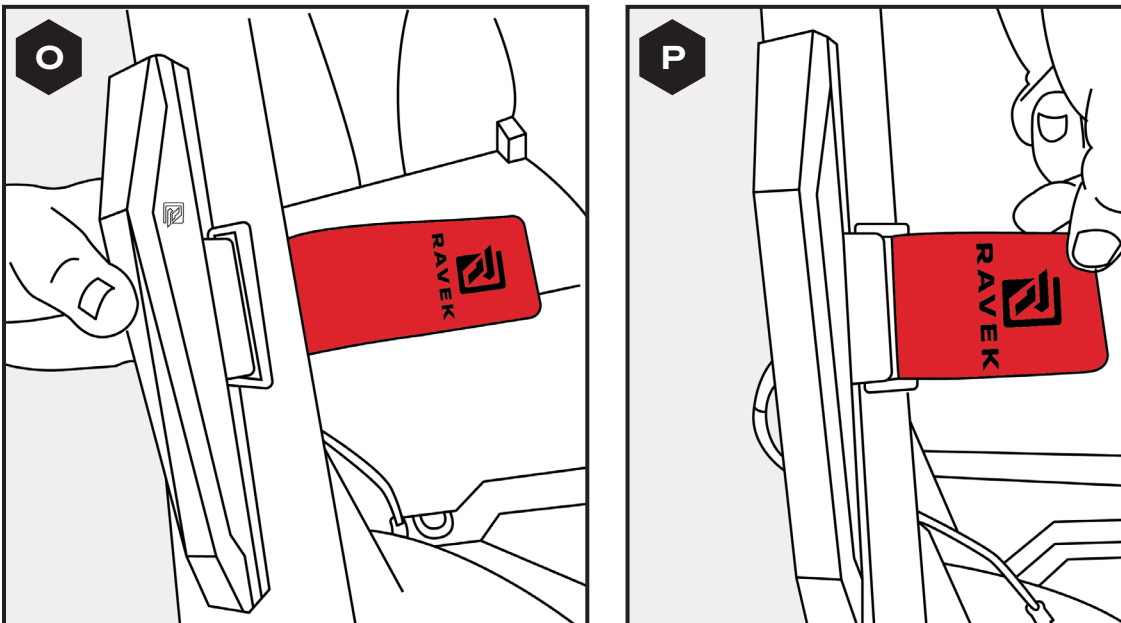

**JUMP TO STEPS 9-12 TO FINISH INSTALL**

## OPTION B DIAGRAM - ADHESIVE ONLY MOUNTING

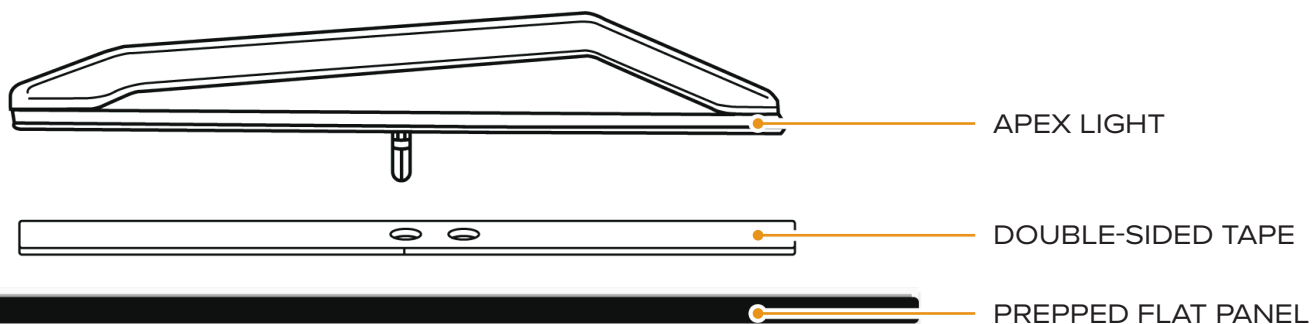

i

**LOCATE A SURFACE TO MOUNT TO**

Locate an exterior panel with 8" of flat surface for mounting. [SEE FIGURE A]

*NOTE: If you're adhesive mounting the Apex Lights to the roof, we recommend drilling a hole to feed the wires through. The Apex Light adhesive creates a water-tight seal.*

A

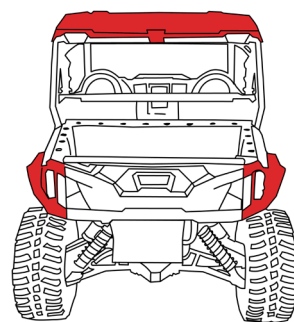

ii

**WIPE DOWN SURFACES**

Before you permanently install your Apex light to the UTV's flat panel you've chosen, wipe down the panel and the base of the light with the rubbing alcohol wipe provided and let dry.

Next wipe down the panel and light base with the adhesion promoter wipe provided. Let dry. [SEE FIGURES B & C]

B

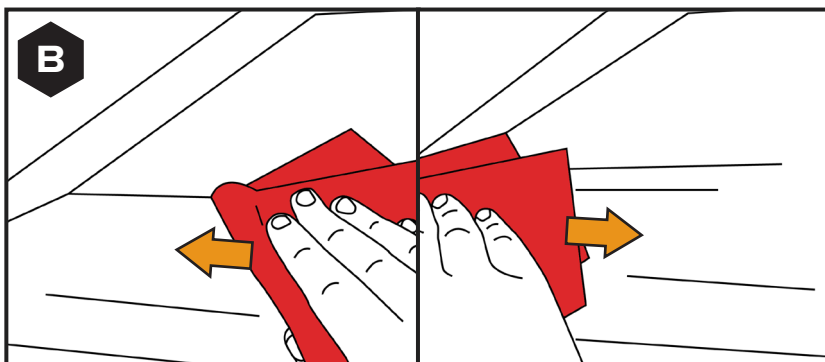

RUBBING  
ALCOHOL WIPE

ADHESIVE  
PROMOTER WIPE

C

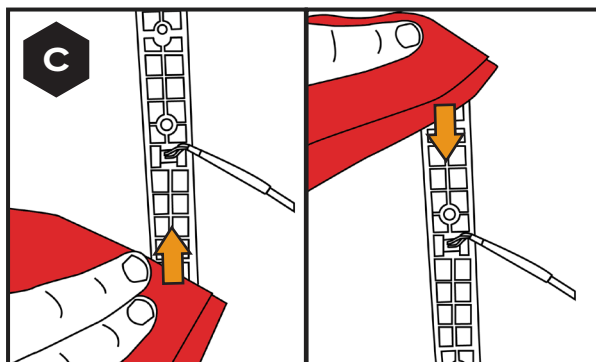

RUBBING  
ALCOHOL WIPE

ADHESIVE  
PROMOTER WIPE



## APPLY TAPE

Apply the double-sided tape to the Apex light's base and affix the light to the prepped surface. [SEE FIGURES D - G]

**NOTE:** Be sure the whole light's base is in contact with the surface of the UTV to ensure the light will hold up permanently.

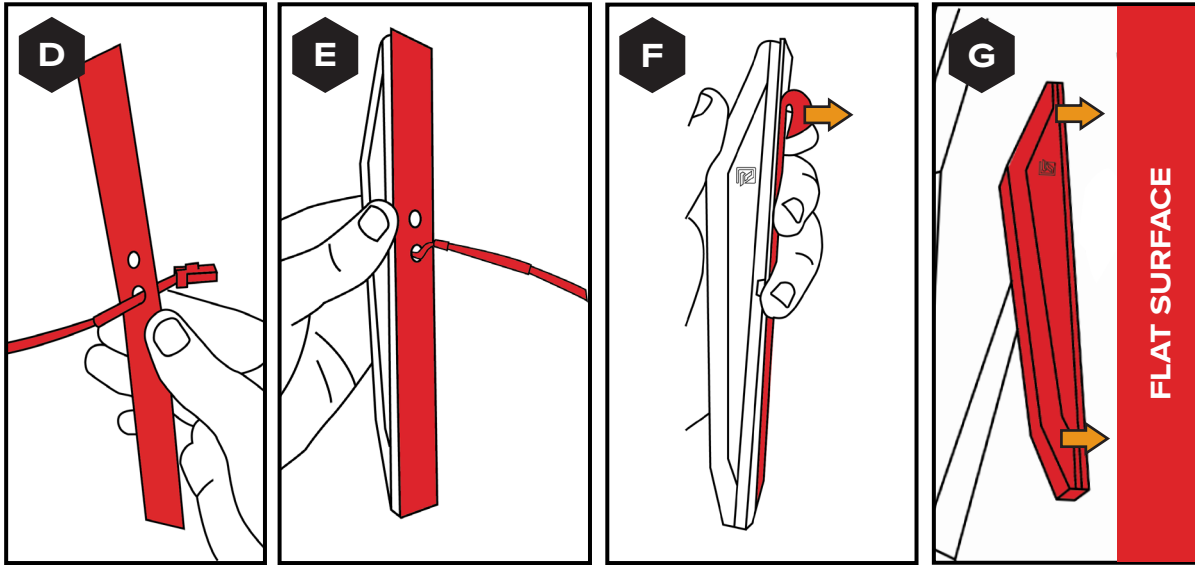

**JUMP TO STEPS 9-12 TO FINISH INSTALL**

8C

## OPTION C - DRILLED AND ADHESIVE MOUNTING:

### OPTION C DIAGRAM - DRILLED AND ADHESIVE MOUNTING

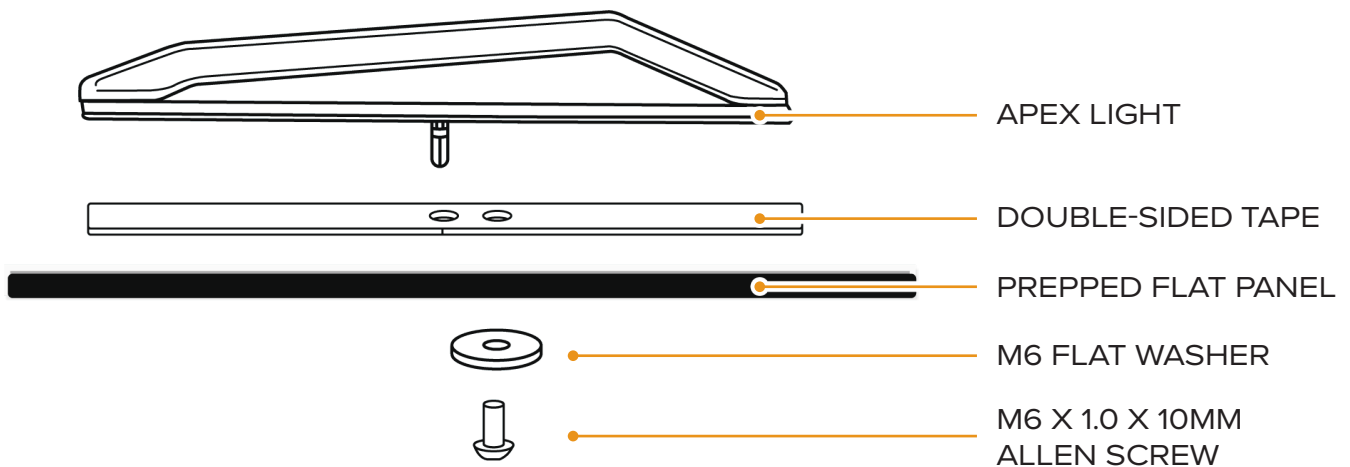



## LOCATE A SURFACE TO MOUNT TO

Locate an exterior panel with 8" of flat surface for mounting.  
[SEE FIGURE A]

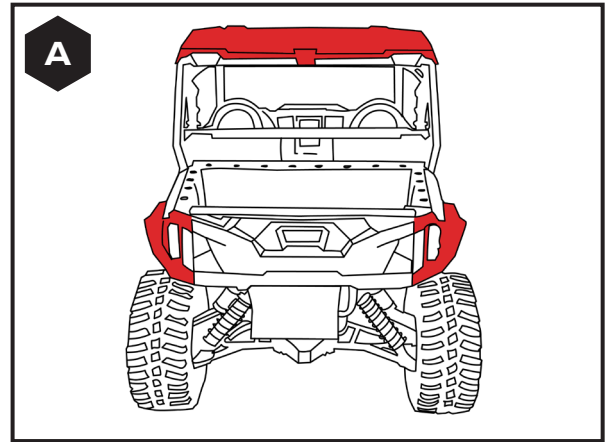

## MARK HOLES TO DRILL

Use the double-sided tape holes as a template for the drilling locations.  
Confirm you can access the inside of the panel that you'll need to be able to access this area with your flat washer. [SEE FIGURES B - D]

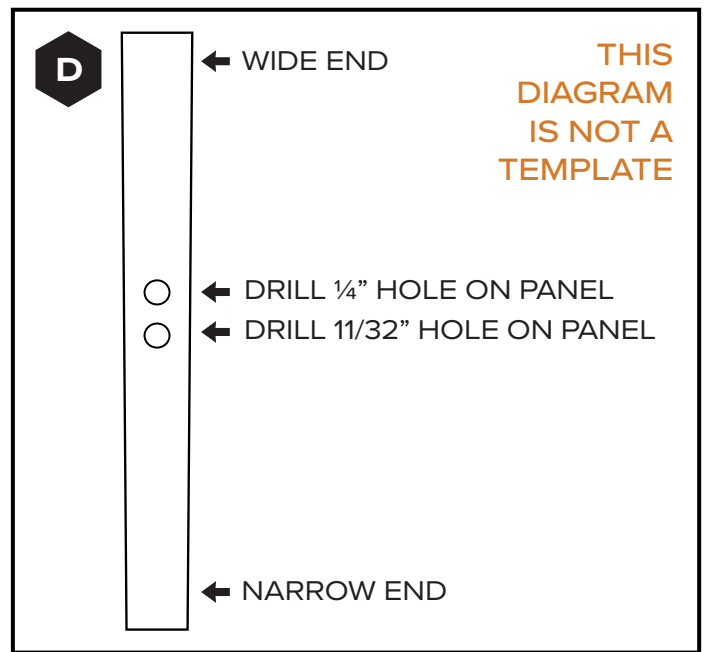
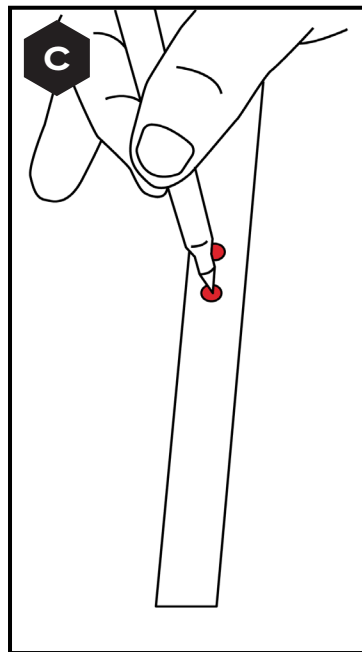
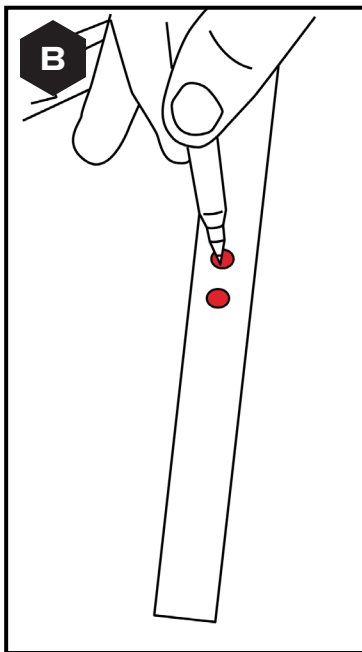

## DRILL 1/4" HOLE

Once you have your holes marked, drill a 1/4" hole that will be used to feed the screw through.

**NOTE:** We recommend using a brad point drill bit to avoid damaging your panel.



## DRILL 11/32" HOLE

Drill a 11/32" hole that you will feed the Apex light's wire connector through.



## WIPE SURFACE WITH RUBBING ALCOHOL

Before you permanently install your Apex light to the UTV's flat panel you've chosen, wipe down the panel and the base of the light with the rubbing alcohol wipe provided and let dry.

Next wipe down the panel and light base with the adhesion promoter wipe provided. Let dry. [SEE FIGURES E & F]

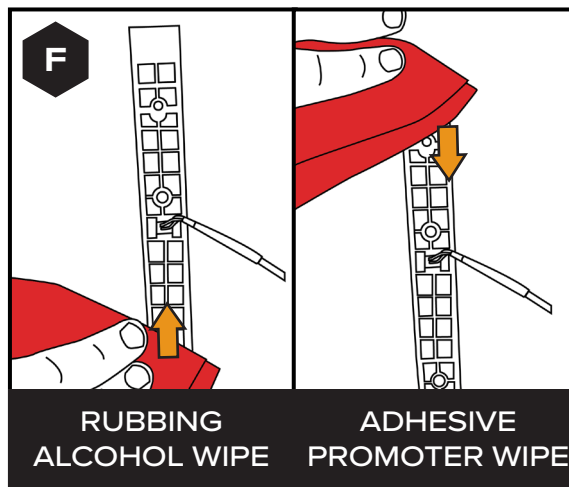

## APPLY TAPE

Apply the double-sided tape to the Apex light's base. [SEE FIGURES G - I]

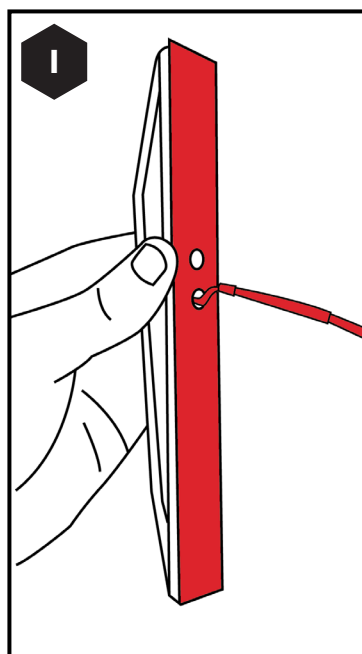
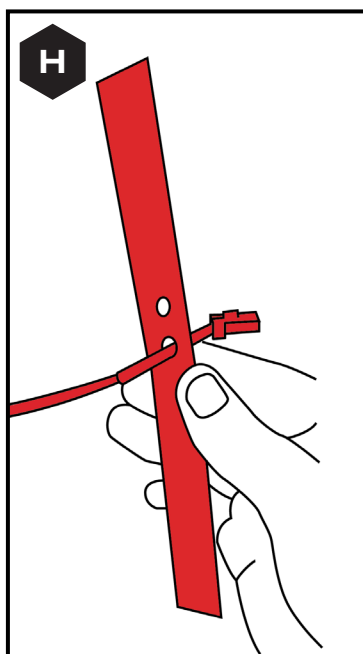
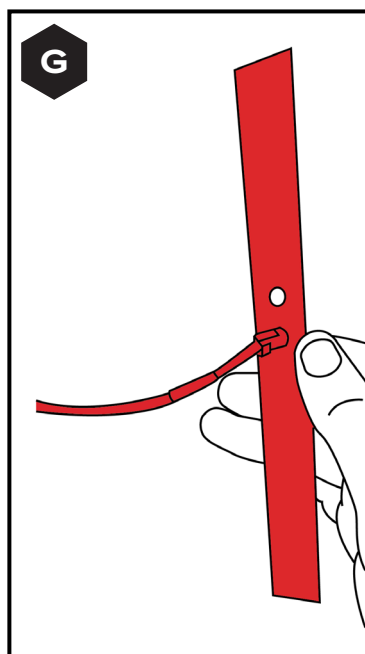

vii

## ADHERE LIGHT TO PREPPED SURFACE

Feed your light's wiring through the 11/32" hole. Peel away the double-sided tape cover, and stick the Apex light to the prepped surface. [SEE FIGURES J - L]

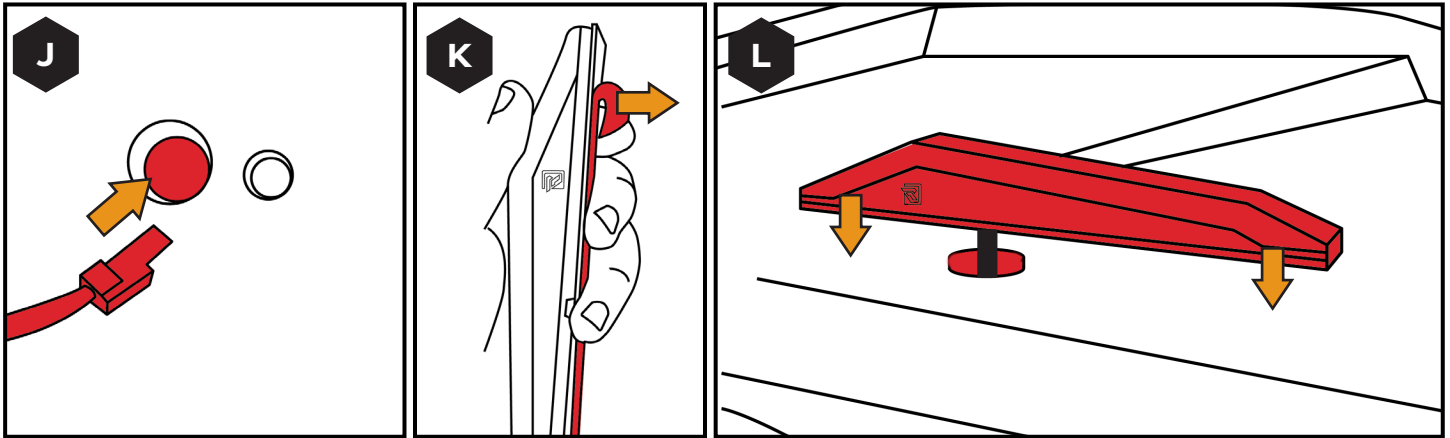

viii

## THREAD IN SCREW

Thread your M6 x 1.0 x 10mm Socket Allen Screw with an M6 Flat Washer through the backside of the panel into the light's base using a 4MM ALLEN WRENCH. [SEE FIGURES M & N]

**NOTE:** If a longer screw is required, you have two options:

1. Give us a call or email, and we will express mail you a screw of the length you need.
2. Go to your local hardware store and purchase a M6 x 1.0 x (your desired length).

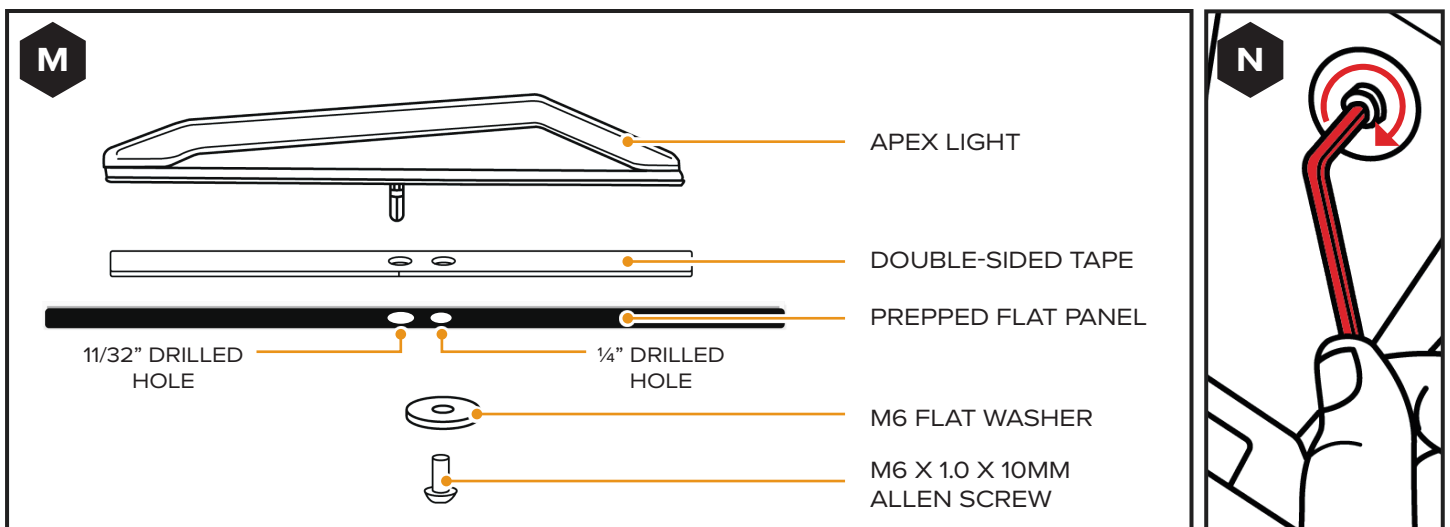

**JUMP TO STEPS 9-12 TO FINISH INSTALL**

9

### PLUG IN THE APEX LIGHT

Plug your Apex light into the extension harness. [SEE FIGURES 9A & 9B]

*NOTE: Remember to heat shrink all your connection points as seen in step 3.*

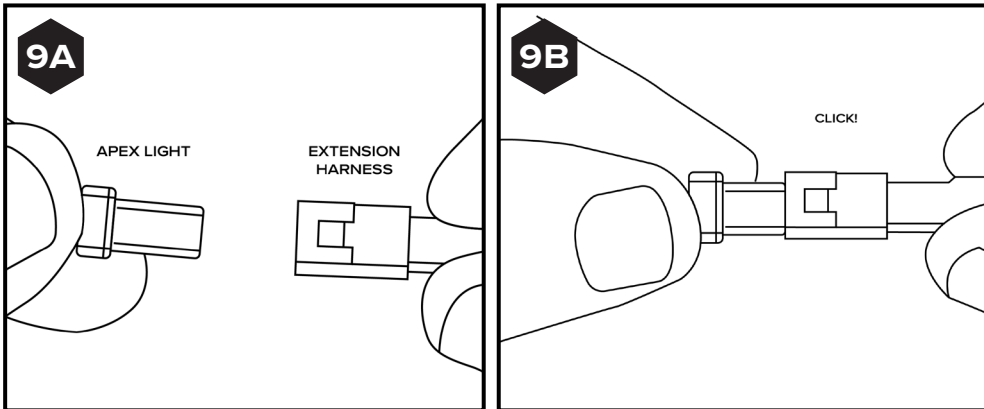

10

### REPEAT STEPS 1 TO 8

Repeat step 1 through 9 on the right side of the General to install your other Apex light.

11

### LET THE ADHESIVE CURE

Let adhesive tape cure for 24 hours before riding.

12

### SECURE WIRING

Once you have both of your Apex lights mounted, go through and secure all the wiring using the zip ties provided.

*NOTE: Secure wiring away from hot or moving components.*

*NOTE: Remember to heat shrink all your connection points as seen in step 3.*





**RAVEK**  
BUILT FOR MORE

## WHY RAVEK

Stock UTVs don't come with enough storage, lighting, comfort, and protection. That's why we started RAVEK.

We live to design, manufacture, and test innovative SxS upgrades that elevate the riding experience. Here's what you can expect from us:

- Durable products built to last (100% lifetime guarantee)
- UTV upgrades thoughtfully designed & tested by riders
- Outstanding installation support (videos & USA customer service)
- Constant flow of epic riding content (check out our social media)

We're confident your RAVEK product will earn its place on your machine. Please call or e-mail us if we can help.

- Harry & Ricky (Brothers & Owners)

## MESSAGE FROM THE DESIGNER

Has anyone ever noticed how there are far fewer light options for the rear of these vehicles than the front? The contours of the Apex Lights in red just pop to me. Not only are you adding the safety of more rearward facing taillights, but they also inevitably make anything look badass, am I right?







**RAVEK**  
BUILT FOR MORE