



# RAVEK

POLARIS RZR XP 2017-2023

***MOLLE STORAGE PANELS***



# INSTRUCTION MANUAL



# RAVEK

POLARIS RZR XP 2017-2023

## ***MOLLE STORAGE PANELS***

Part #: 64-300

Fitment: POLARIS RZR XP 2017-2023

### **PARTS INCLUDED:**

- LEFT MOLLE PANEL (1X)
- RIGHT MOLLE PANEL (1X)
- CLAMP (10X)
- M6 X 1.0 X 20MM SCREW (10X)
- M6 X 1.0 NYLOCK NUT (10X)

### **TOOLS NEEDED:**

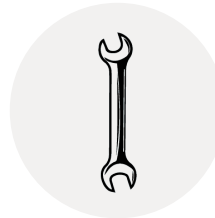

10mm Wrench



4mm Allen Wrench

### **INSTALL VIDEO TUTORIAL**

**DON'T LIKE INSTRUCTIONS?  
VISIT OUR WEBSITE TO ACCESS  
THE VIDEO TUTORIAL**



1

## LOCATE THE REAR ROLL CAGE

To begin, locate the rear roll cage area where the MOLLE panels will be mounted. [SEE FIGURE 1A]

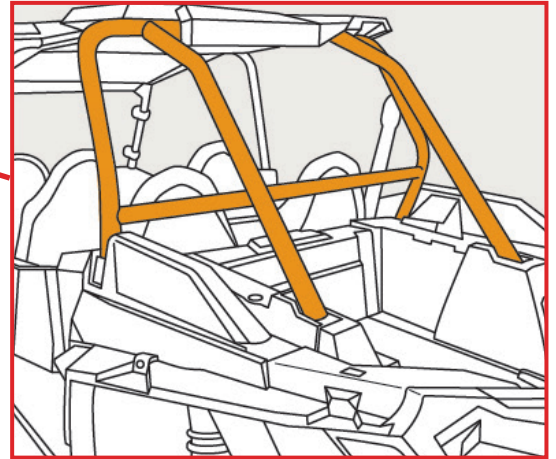
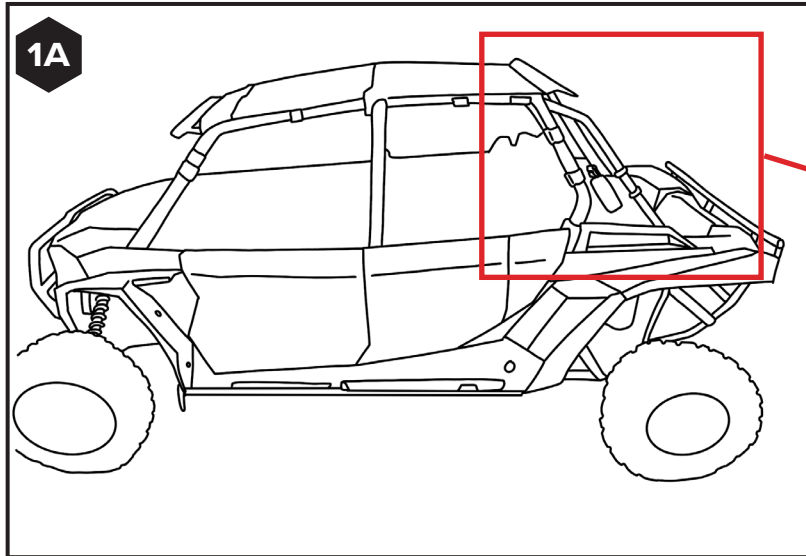

2

## LOCATE THE CLAMPS

Find the clamps in your kit and identify the flat side of each clamp. This side will rest flat against the back of the MOLLE Storage Panel when you attach it to the roll bar. [SEE FIGURES 2A & 2B]

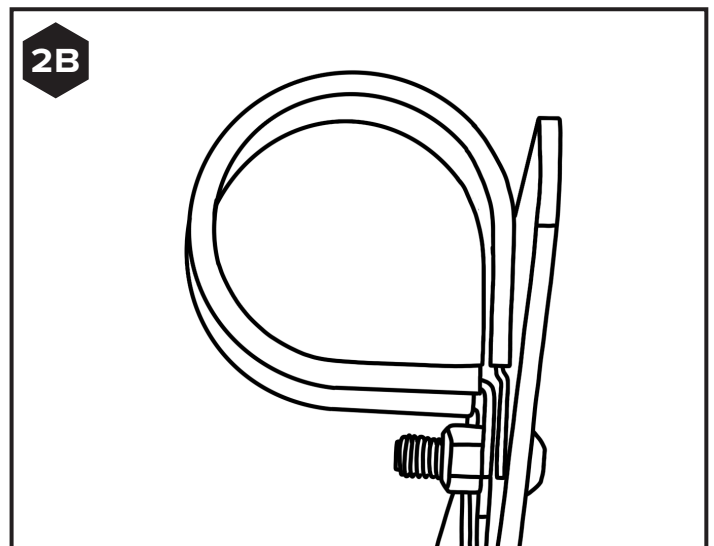
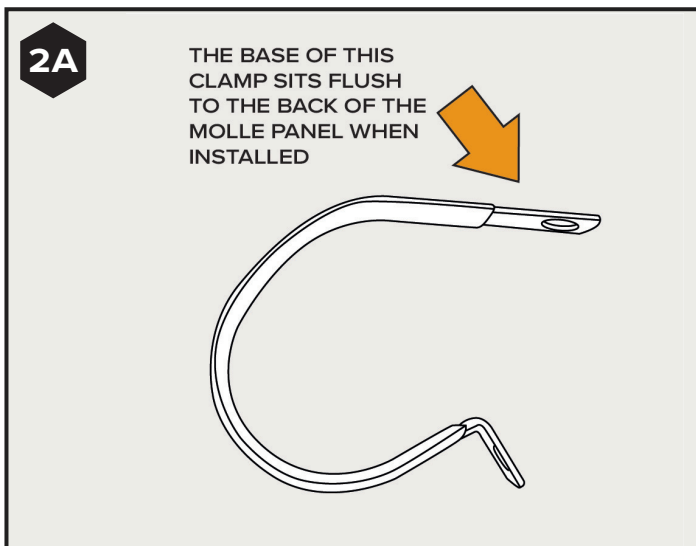

## 3

## INSTALL THE LEFT SIDE PANEL

- Go to the left side of the RZR.
- Place the left MOLLE Panel against the roll cage.
- Place the clamp on the rollbar.
- Use a screw from the kit and put it through the circled hole on the MOLLE Panel and the holes on the clamp. [SEE FIGURE 3A]
- Once the screw is through all the holes, add a nut to the back side of the screw. Tighten the nut slightly with your fingers. [SEE FIGURE 3B]

**NOTE:** It might be difficult to align the clamp with the hole on the MOLLE Panel while inserting the screw. Consider asking a friend to help you with this step.

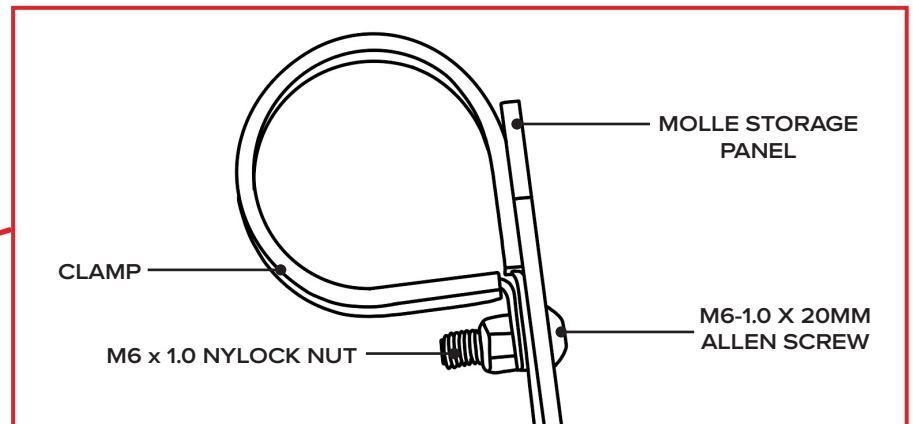
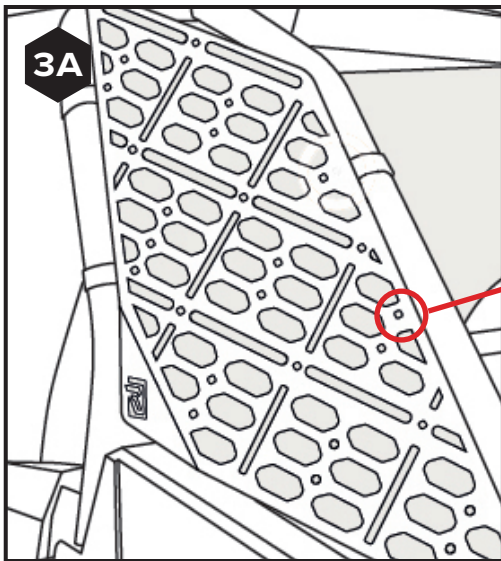

## 4

## INSTALL THE OTHER MOLLE CLAMPS

Using three more clamps, screws, and nuts, mount the MOLLE storage panel to your roll cage. Get all the hardware finger-tighten before continuing.

**NOTE:** The MOLLE Panels can be used on RZR's with or without accessories on the roll cage. However, the mounting locations might vary depending on your accessories. If the suggested holes don't work, try using other holes or slots to securely attach the MOLLE Panel to your RZR.

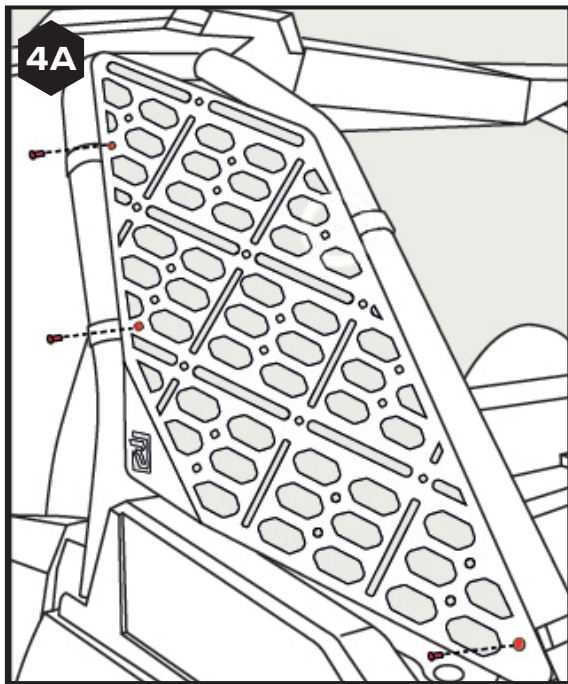

5

## TIGHTEN THE BOLTS

Use a 4mm Allen wrench to tighten the screws, and a 10mm wrench to hold the nuts on the back side of the clamps to secure it to the roll bar.

**NOTE:** It's essential to use at least four clamps to attach each MOLLE Storage Panel to the RZR. Two extra clamps are provided with each kit.

6

## REPEAT FOR RIGHT SIDE PANEL

Repeat steps 3-5 on the right side of the UTV to mount your MOLLE Storage Panel securely to the roll cage of your RZR.

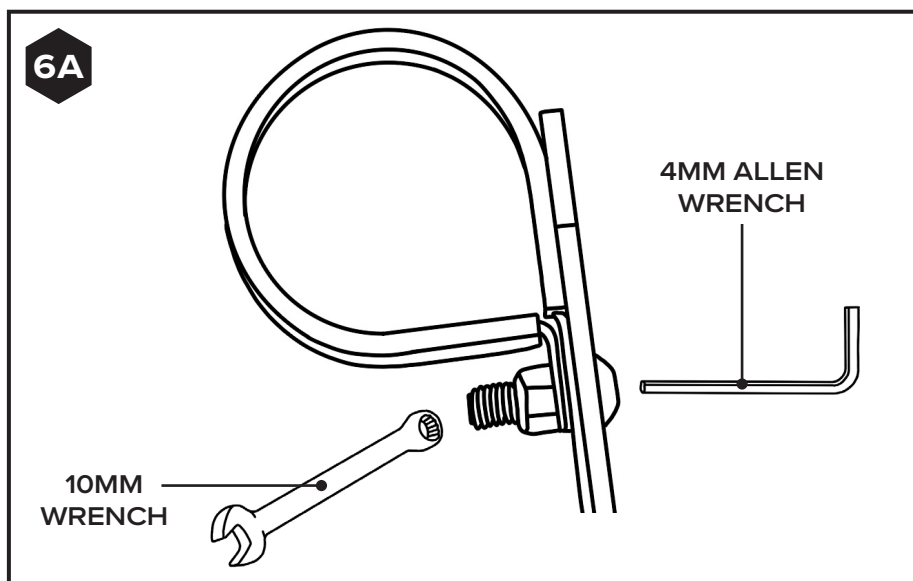



# RAVEK

BUILT FOR MORE

## WHY RAVEK

Stock UTVs don't come with enough storage, lighting, comfort, and protection. That's why we started RAVEK.

We live to design, manufacture, and test innovative SxS upgrades that elevate the riding experience. Here's what you can expect from us:

- Durable products built to last (100% lifetime guarantee)
- UTV upgrades thoughtfully designed & tested by riders
- Outstanding installation support (videos & USA customer service)
- Constant flow of epic riding content (check out our social media)

We're confident your RAVEK product will earn its place on your machine. Please call or e-mail us if we can help.

- Harry & Ricky (Brothers & Owners)

## MESSAGE FROM THE DESIGNER

I love the bodylines on the Polaris RZR. Its clean, strong features allow you to customize the RZR to be more aggressive – or more focused on utility.

The Molle Panel for the 17-23 RZR was designed to really fit into the body lines and look like an OEM piece. Ride on.





**RAVEK**  
BUILT FOR MORE