



# RAVEK

POLARIS RANGER

## ***TURN SIGNAL KIT***

PLUG & PLAY AUTO-CANCEL



# INSTRUCTION MANUAL



# RAVEK

## POLARIS RANGER

### ***PLUG & PLAY AUTO CANCEL UTV TURN SIGNAL KIT***

Part #: 64-101

Fitment:

- POLARIS RANGER 570 2015+
- POLARIS RANGER 900 2014-2019
- POLARIS RANGER 1000 2017-2018

#### **PARTS INCLUDED:**

- Turn Signal Controller (1x)
- Switchback Apex Light (2x)
- Taillight Harness (2x)
- Power Harness (1x)
- Horn (1x)
- Turn Signal Rocker Switch (1x)
- Horn/Hazards Rocker Switch (1x)
- Turn Signal Rocker Switch Extension Harness (1x)
- Horn/Hazards Rocker Switch Extension Harness (1x)
- Right Taillight Extension Harness (1x)
- Left Taillight Extension Harness (1x)
- Right Turn Signal Extension Harness (1x)
- Left Turn Signal Extension Harness (1x)
- Right Dash Indicator Harness (1x)
- Left Dash Indicator Harness (1x)
- Horn Harness (1x)
- License Plate Illuminator Extension Harness (1x)
- Dielectric Grease (1x)
- Heat Shrink (1x)
- Wire Loom (1x)
- Roll Bar Adapter (2x)
- Strap (2x)
- Zip Tie (20x)
- Double Sided Tape (2x)
- M6 Flat Washer (2x)
- M5 x 0.8 x 6mm Allen Screw (4x)
- M6 x 1.0 x 10mm Allen Screw (2x)
- Adhesive Promoter Wipe (3x)
- Rubbing Alcohol Wipe (3x)

## TOOLS NEEDED: \***OPTIONAL**



*Side Cutter Pliers*



*Push Pin Pliers*

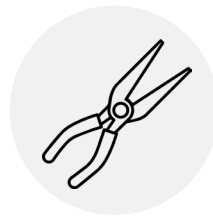

*Needle Nose Pliers*



*Pick*



*3mm Allen Wrench*



*4mm Allen Wrench*

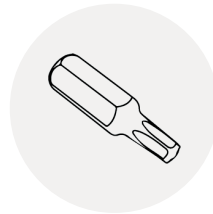

*T-30 Torx*

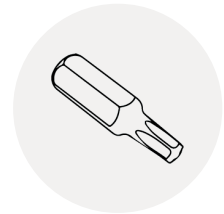

*T-40 Torx*



*Ratchet*



*10mm Socket*



*Small Flathead  
Screwdriver*



*Heat Gun / Lighter*

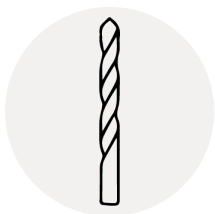

*11/32" drill bit\**

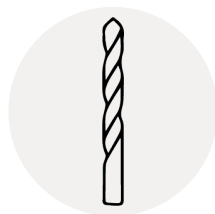

*1/4" drill bit\**



*Drill\**



*Wire Fish\**

## INSTALL VIDEO TUTORIAL

**DON'T LIKE INSTRUCTIONS?  
VISIT OUR WEBSITE  
TO ACCESS THE  
VIDEO TUTORIAL.**



i

Remove the center hood panel on your Ranger by turning the latches a quarter turn each and lift the hood away from the SxS. [SEE FIGURE 1A]

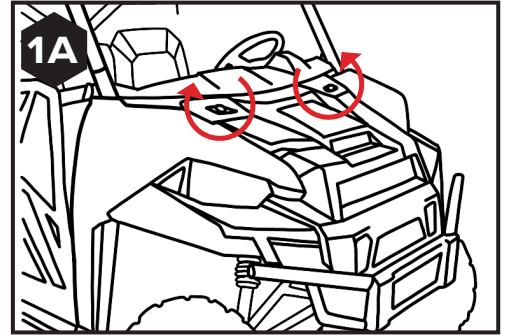

ii

Locate the Bus Bar underneath the panel removed in step 1. Remove the far-right and far-left nuts on the Bus Bar using a 10MM DEEP WELL SOCKET and RATCHET. [SEE FIGURES 1B & 1C]

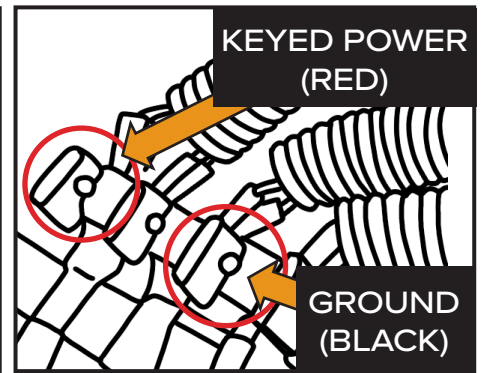
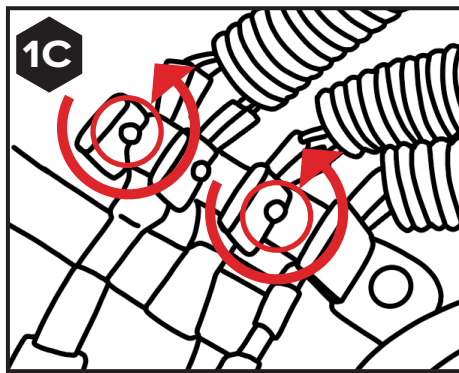
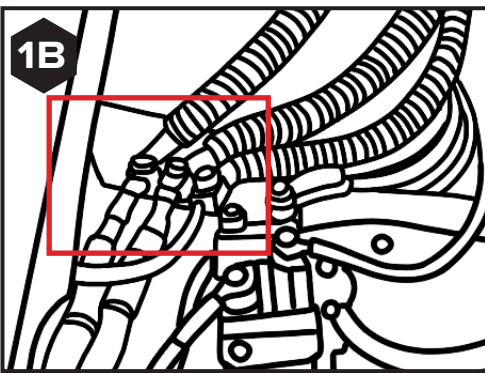

iii

Using a T-30 TORX remove the six torx screws holding the center floor piece on your machine. Once fasteners are removed, lift the panel and remove it. [SEE FIGURES 1D & 1E]

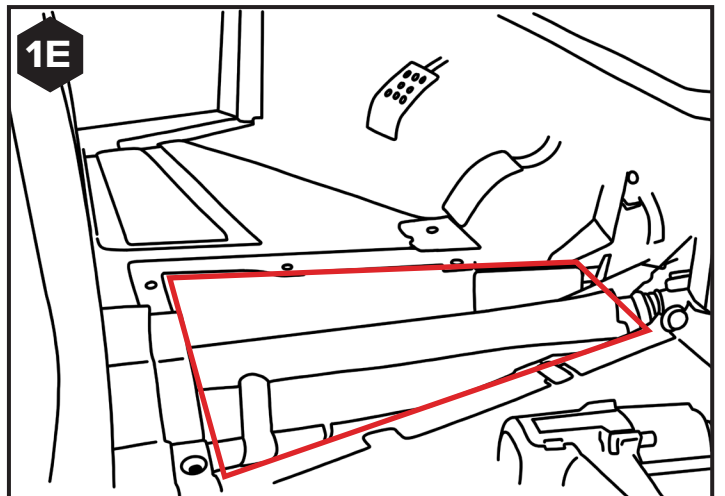
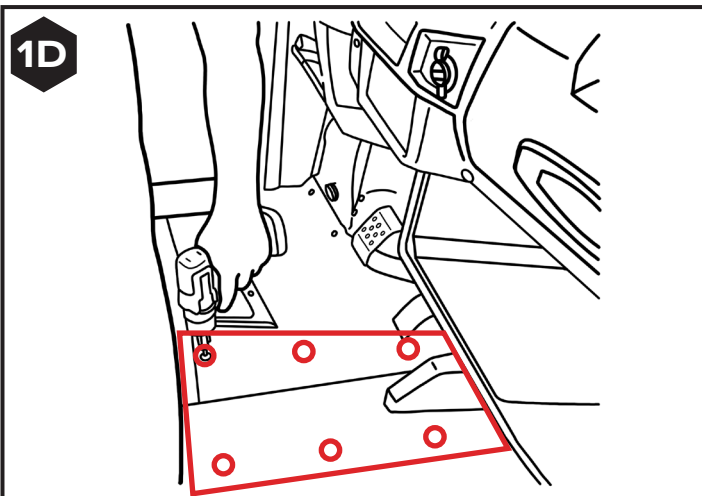

iv

Flip your seats up and remove the storage tray to access your Ranger's battery. Disconnect your battery using a 10MM DEEP WELL SOCKET and a RATCHET. [SEE FIGURES 1F- 1J]

**NOTE:** Disconnect the negative battery terminal first to prevent arcing. Make sure cables don't touch each other or any metal surfaces when disconnected.

**NOTE:** The area below the seat will be crucial in a future step when routing wires to the rear of the machine.

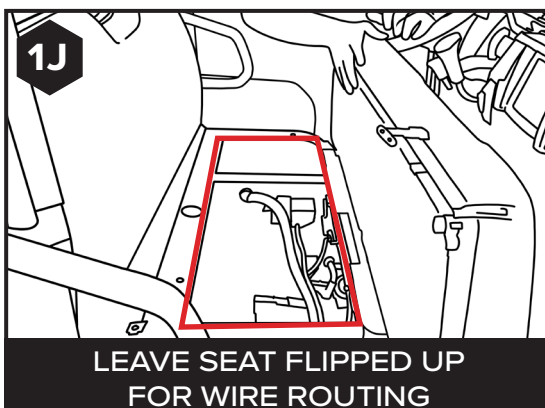
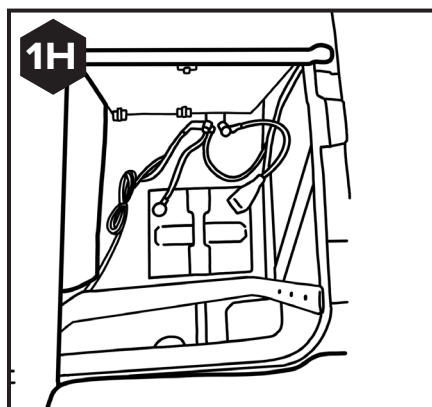
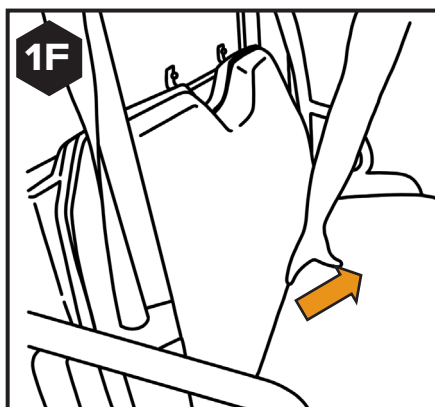

v

Using PUSH PIN PLIERS remove your dashboard cover. [SEE FIGURES 1K - 1L]

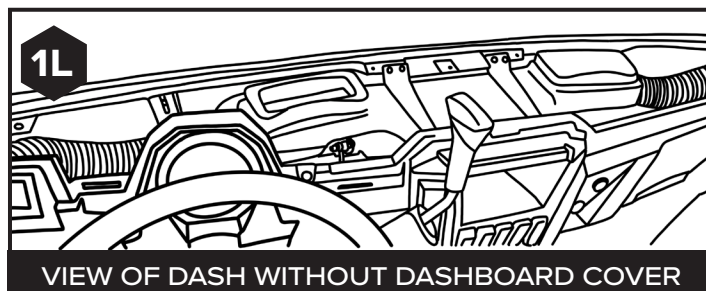
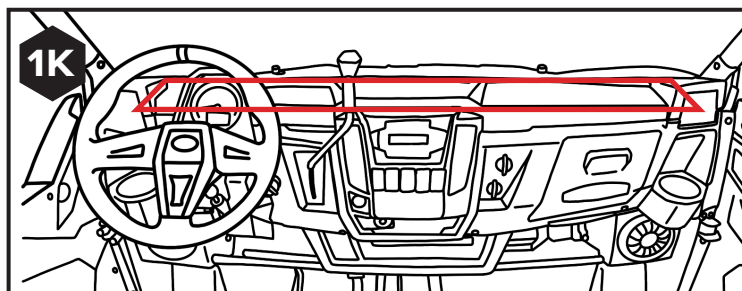

vi

Remove two rocker switch knock outs from the rocker switch panel by gently prying them off using a **SMALL FLATHEAD SCREWDRIVER**. You'll be installing the Turn Signal and Horn/Hazards rocker switches in those slots in a future step. [SEE FIGURES 1M & 1N]

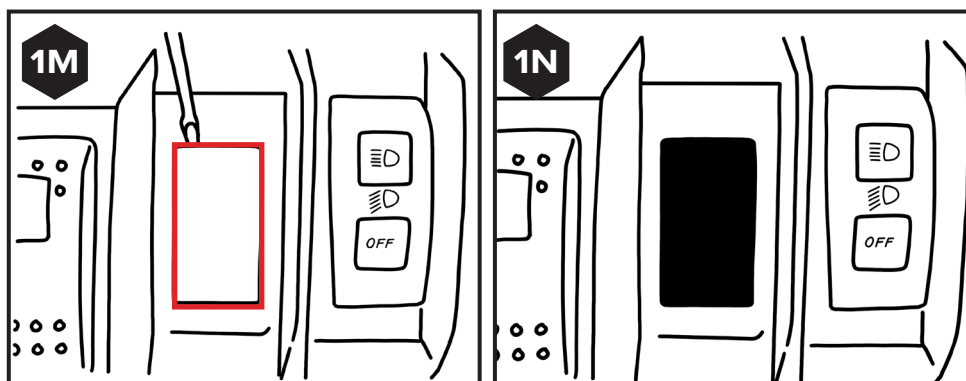

vii

Remove the taillights using a **10MM SOCKET** and **RATCHET** and set aside. [SEE FIGURES 1O – 1R]

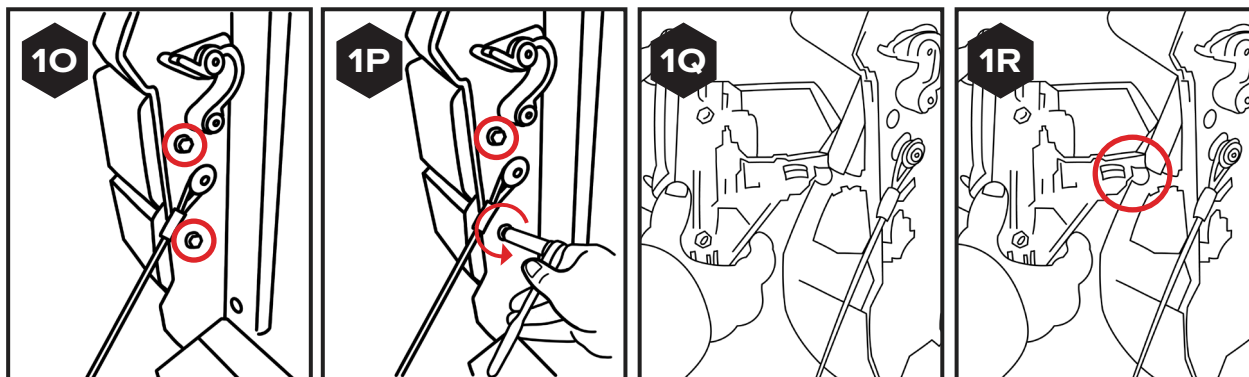

viii

Dump your bed to gain access to the Ranger's frame rail. [SEE FIGURE 1S]

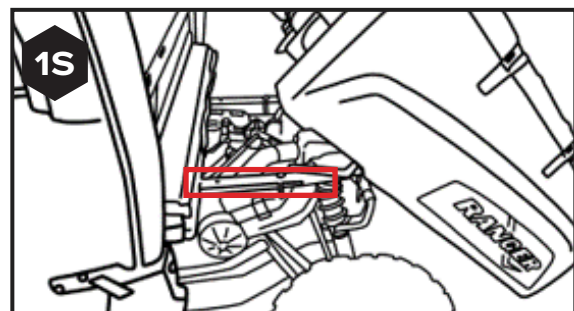



## 2 INSTALL THE WIRING TO THE TURN SIGNAL CONTROLLER

i

Grab your Turn Signal controller and set it where you'll permanently mount it in a future step. [SEE FIGURE 2A]

**NOTE:** We recommend mounting your controller under the center hood panel removed in step 1i.

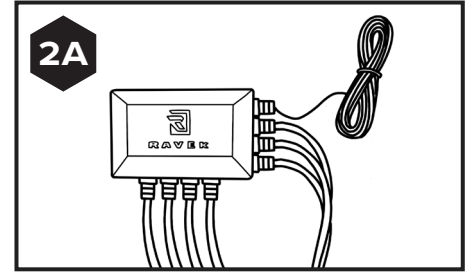

ii

Plug all of your extension harnesses except for Horn/Hazards and Turn Signal harness into the controller's corresponding connectors. Even though all the connectors we engineered are waterproof, we recommend using a small dab of dielectric grease to each connection point. [SEE DIAGRAM A FOR AN OVERVIEW OF YOUR CONNECTIONS]

**NOTE:** All your extension harnesses have labeled heat shrink, allowing you to determine where each extension harness plugs into. [SEE DIAGRAM A]

**NOTE:** The Brake Input red wire does not have an extension harness to be plugged; this will be routed directly to the driver's side taillight harness in an upcoming step.

## 3 HEAT SHRINK YOUR CONNECTIONS

i

As you make the different plug & play connections, use the heat shrink tubing provided to protect your connections from the dirt on the trails.

Go over the connection points you make and cut 2" of heat shrink for each. Use a lighter or heat gun to shrink the tubing. [SEE FIGURES 3A – 3G]

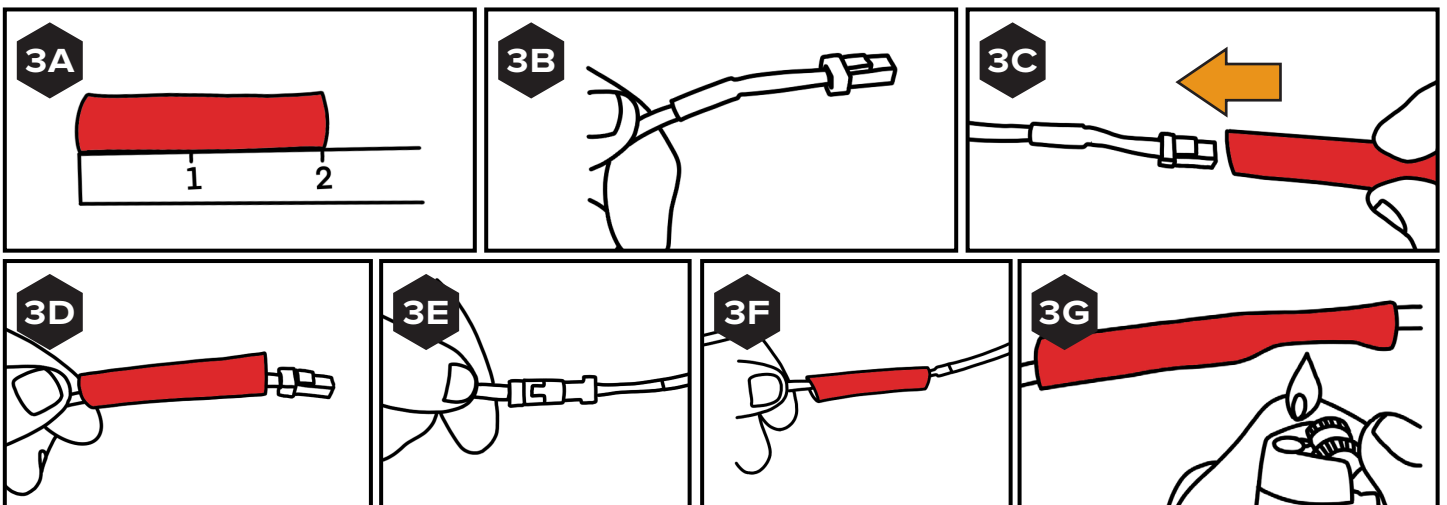

If you won't use the extra Taillight Harness connectors (mentioned in step 5) cut 1.5" piece of heat shrink tubing, slide it over the connector and heat shrink it using a lighter or heat gun. Use needle nose pliers to pinch the end of the extra heat shrink. This will act as a cap to protect the connectors from getting dirt inside. [SEE FIGURES 3H – 3M]

### HEAT SHRINK EXTRA PLUGS

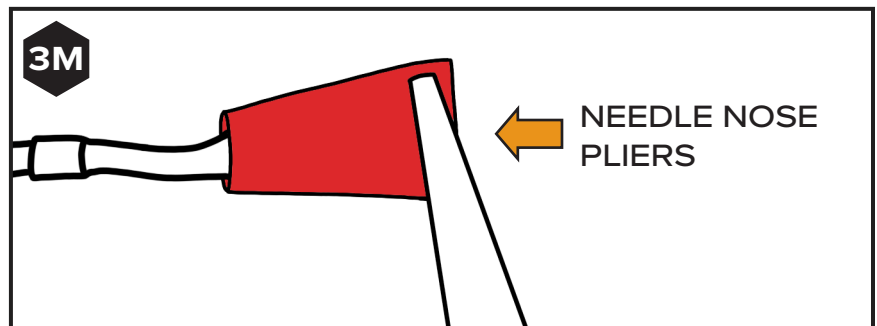
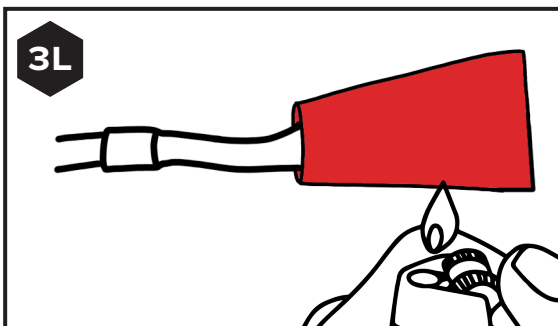
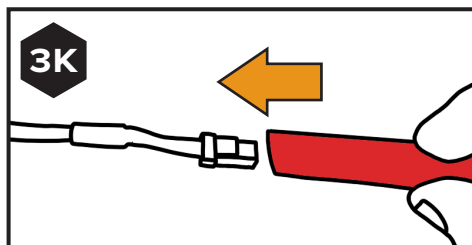
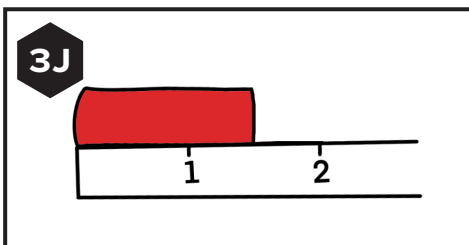
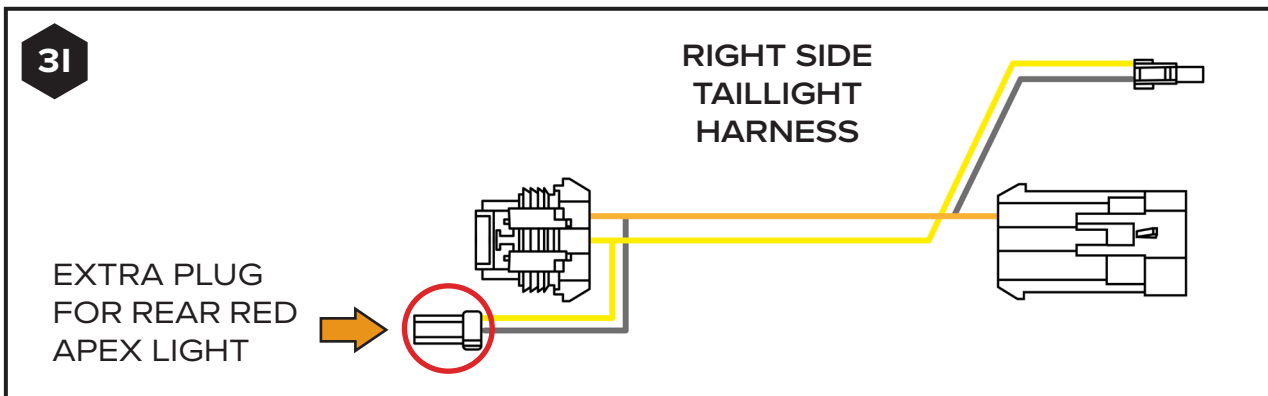
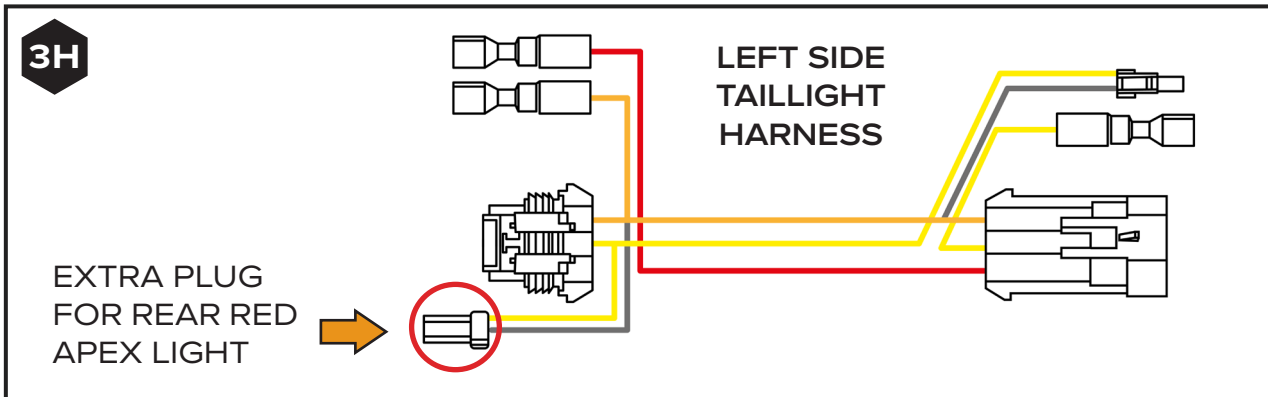





**This step is optional as this will help with maintaining a clean OEM look. Not required for protection of the wiring.**

Grab your Brake Input wire and route it through the wire loom (supplied with the kit).

[SEE FIGURE 3N & 3O]

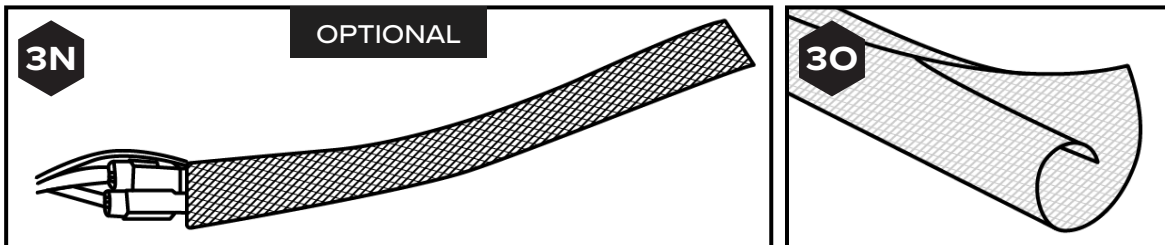

## ROUTE THE REAR LIGHT WIRING



Grab your Rear Left extension, Rear Right extension, and Brake Input wire.

Route your LEFT REAR and Brake Input wires through the driveshaft tunnel panels removed in step 1F to the left taillight and route your RIGHT REAR wire through the driveshaft tunnel through the right taillight. [SEE FIGURES 4A – 4C]

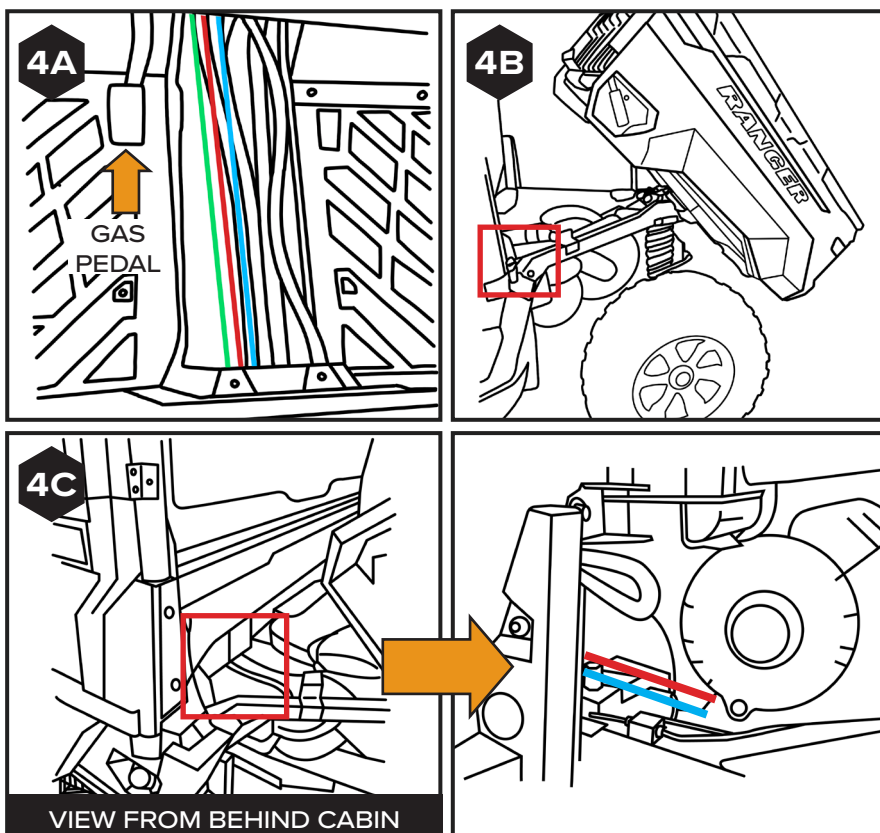

i

With the rear wiring coming out of the controller and routed up to the taillights, you are ready to install your taillight harnesses, included with the kit. [SEE FIGURES 5A & 5B]

**NOTE:** The left side Taillight Harness is easily identifiable as the Taillight harness with the most connectors coming from it.

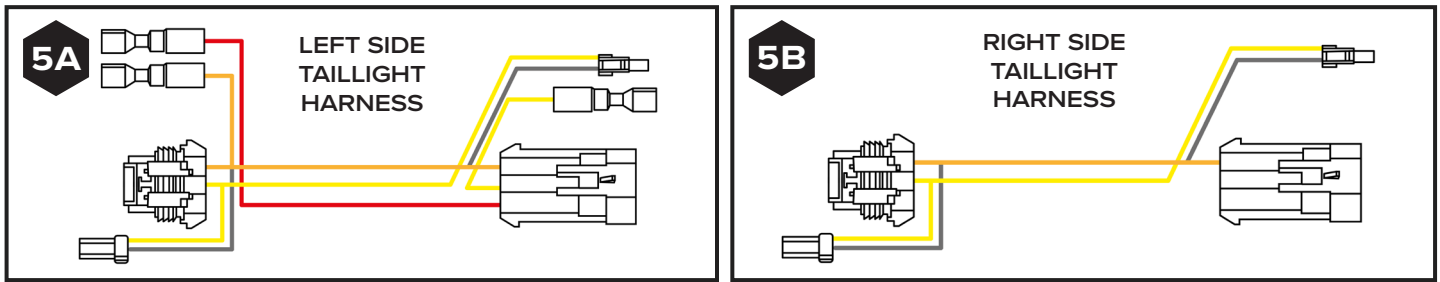

ii

Unplug the stock OEM connector from the left Taillight and plug in the left Taillight harnesses provided with the kit in line with the stock OEM connector and to the Taillight. [SEE FIGURE 5C]

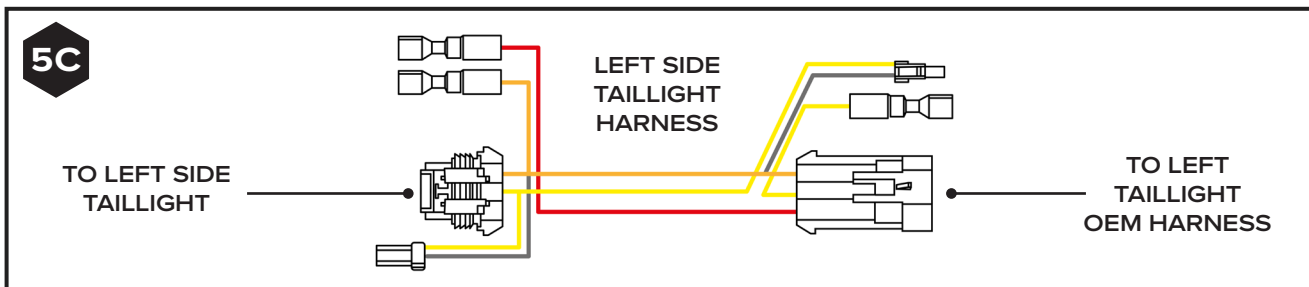

iii

Plug your REAR LEFT extension harness into the corresponding labeled connector from the left Taillight harness, and plug your Brake Input wire to the connector labeled on the left Taillight connector. [SEE FIGURE 5D]

**NOTE:** Extra plug on taillight harness provided to easily add RAVEK Rear Running & Brake Apex Lights to your Ranger (RAVEK Part #64-106), these will add running light, brake light, and turn signal functionality to your machine.

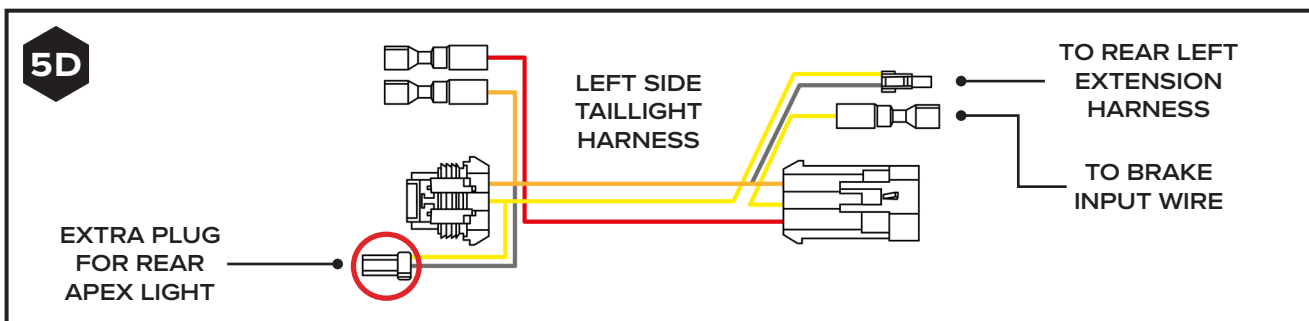

iv

Repeat the previous two steps on the right Taillight with the right- side harness provided (excluding the Brake Input information). [SEE FIGURE 5E]

5E

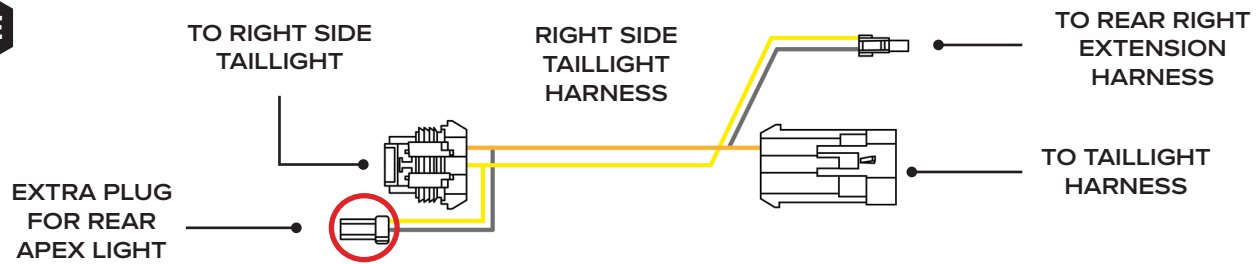

## 6 PLUG IN YOUR LICENSE PLATE ILLUMINATOR (OPTIONAL)

i

Locate the License Plate Illuminator provided with your kit. [SEE FIGURE 6A]

6A

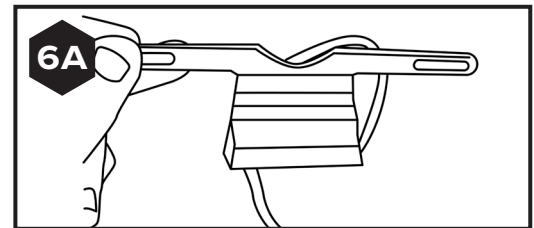

ii

Plug the connectors from the License Plate Illuminator (White = Power) (Black = Ground) to the License Plate Illuminator Extension Harness. Plug the extension harness to the left Taillight Harness labeled accordingly. [SEE FIGURE 6B]

6B

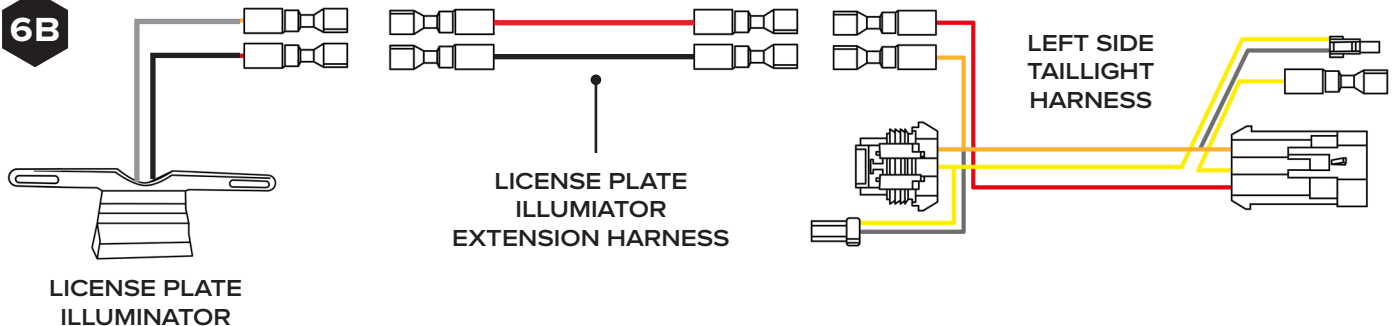

iii

Affix the License Plate Illuminator to your license plate, reusing the hardware from your license plate. [SEE FIGURE 6C]

6C

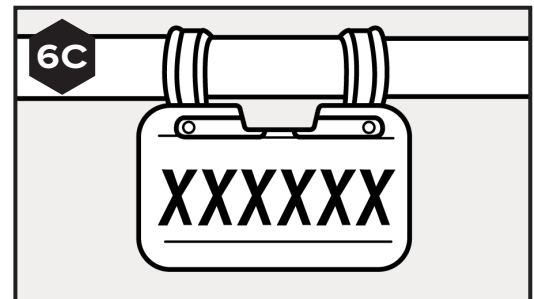

**NOTE:** Before driving your UTV on public roads, check your local laws. This includes verifying if a license plate illuminator is required.

## 7 ROUTE FRONT LEFT & RIGHT TURN WIRING

**i** With all your rear wiring routed (but not yet secured), go to where you placed your Turn Signal Controller and grab your FRONT LEFT and FRONT RIGHT wires.

**ii** Route your FRONT LEFT and FRONT RIGHT extension harnesses to the front end of the Ranger, where you went to mount your Apex Turn Signal Lights permanently (jump to the next step to see all the mounting options for your lights). [SEE FIGURE 7A]

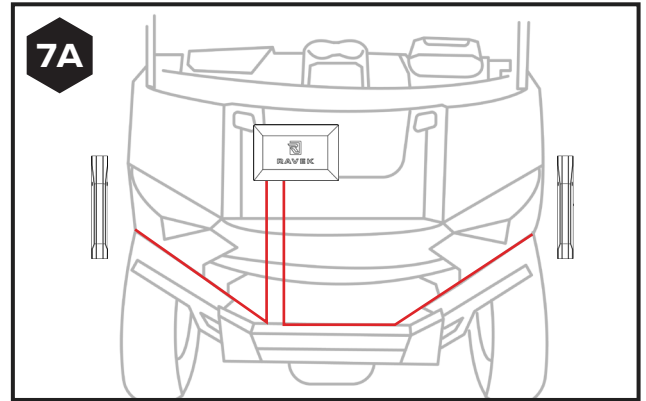

## 8 SELECT LOCATIONS FOR APEX LIGHTS

**i** Your options include:

- **Exterior Body Panel**  
*Any exterior panel with 8" of flat surface for mounting*
- **Roof Mounting**
- **Roll Bar/Bumper Mounting**

Check out the video to the right (see QR code) for a 50 second walkthrough of the different Apex Light mounting options.



## 9 READY TO MOUNT APEX LIGHT

**i** If you have chosen to mount your Apex Lights to a roll bar or bumper, you will follow the Roll Bar mounting steps detailed in step 9A.

If you have decided to mount your Apex lights to either an exterior panel or to your roof, you now have to decide whether you want to mount your Apex lights via:

- Adhesive mount (i.e. no drill) → follow step 9B**
- Drill-mount for increased security → follow step 9C**

## OPTION A DIAGRAM - ROLL BAR MOUNTING

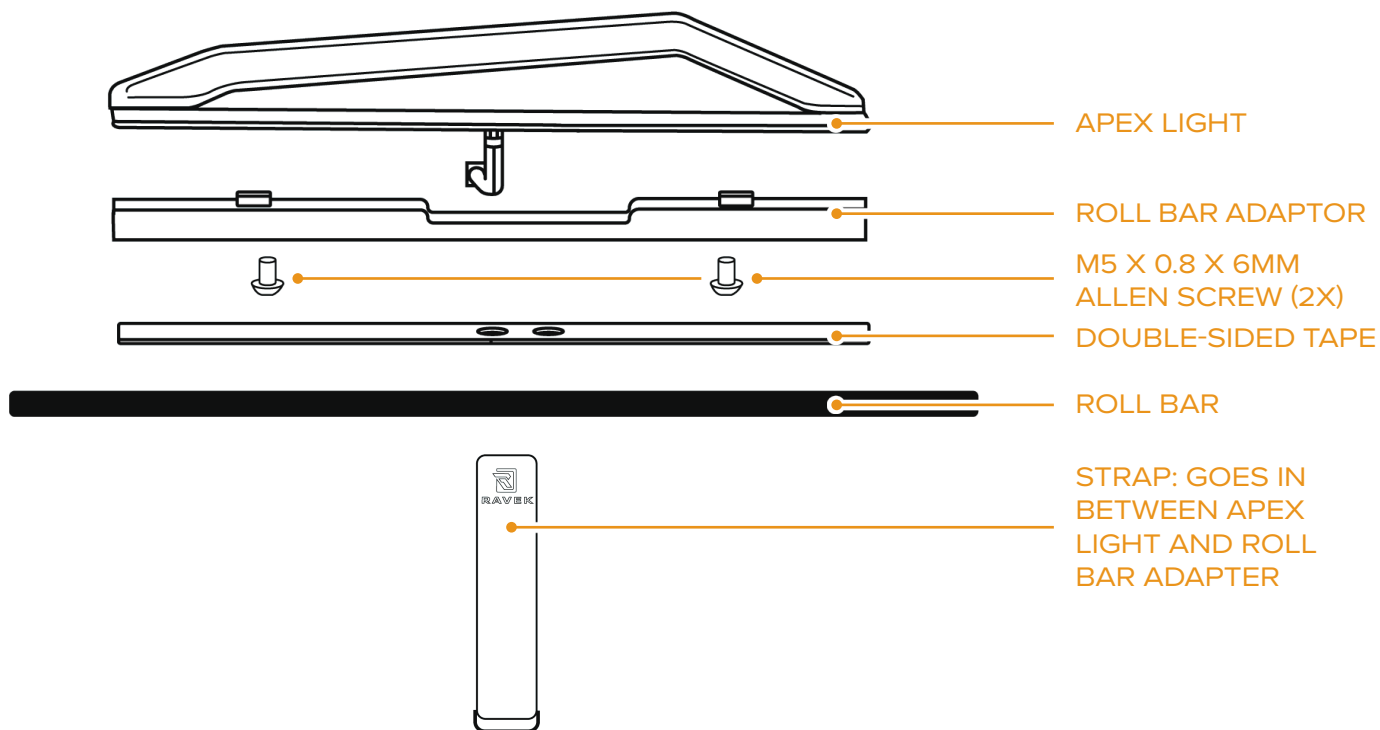

## i

**INSTALL ROLL BAR ADAPTOR**

Install the roll bar adapter to the base of the light by using two of the M5 x 0.8 x 6mm Allen Screws with a 3MM ALLEN WRENCH. [SEE FIGURES A THROUGH C]

**NOTE:** Select which side you would like your wire to exit the light that allows you to best hide your wires.

A

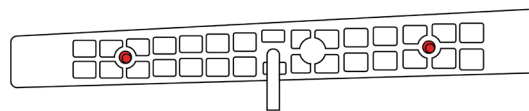

B

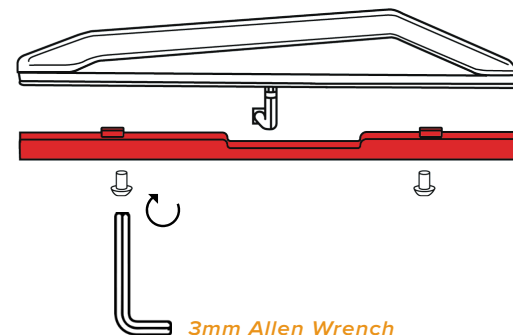

C

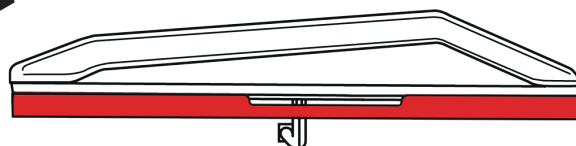

## ii

### INSTALL STRAP

Once the roll bar adapter is secured to the light, install the strap provided through the opening between the light base and the roll bar adapter. [SEE FIGURES D & E]

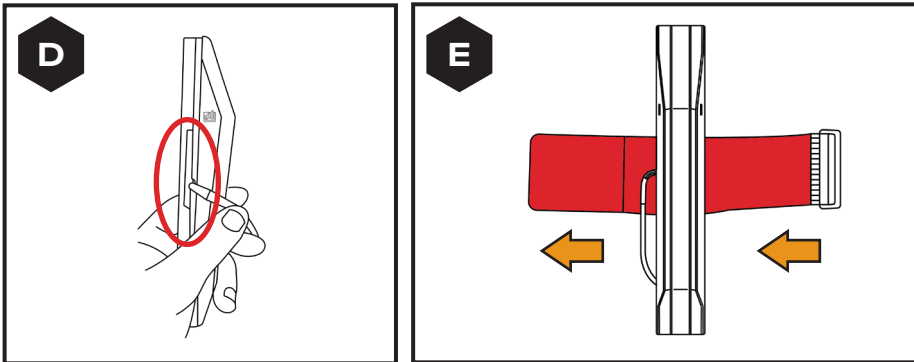

## iii

### WIPE DOWN SURFACES

Before you permanently install your Apex light to the UTV's roll bar you've chosen, wipe down the roll bar and the base of the light with the rubbing alcohol wipe provided and let dry.

Next wipe down the roll bar and light base with the adhesion promoter wipe provided. Let dry. [SEE FIGURES F - J]

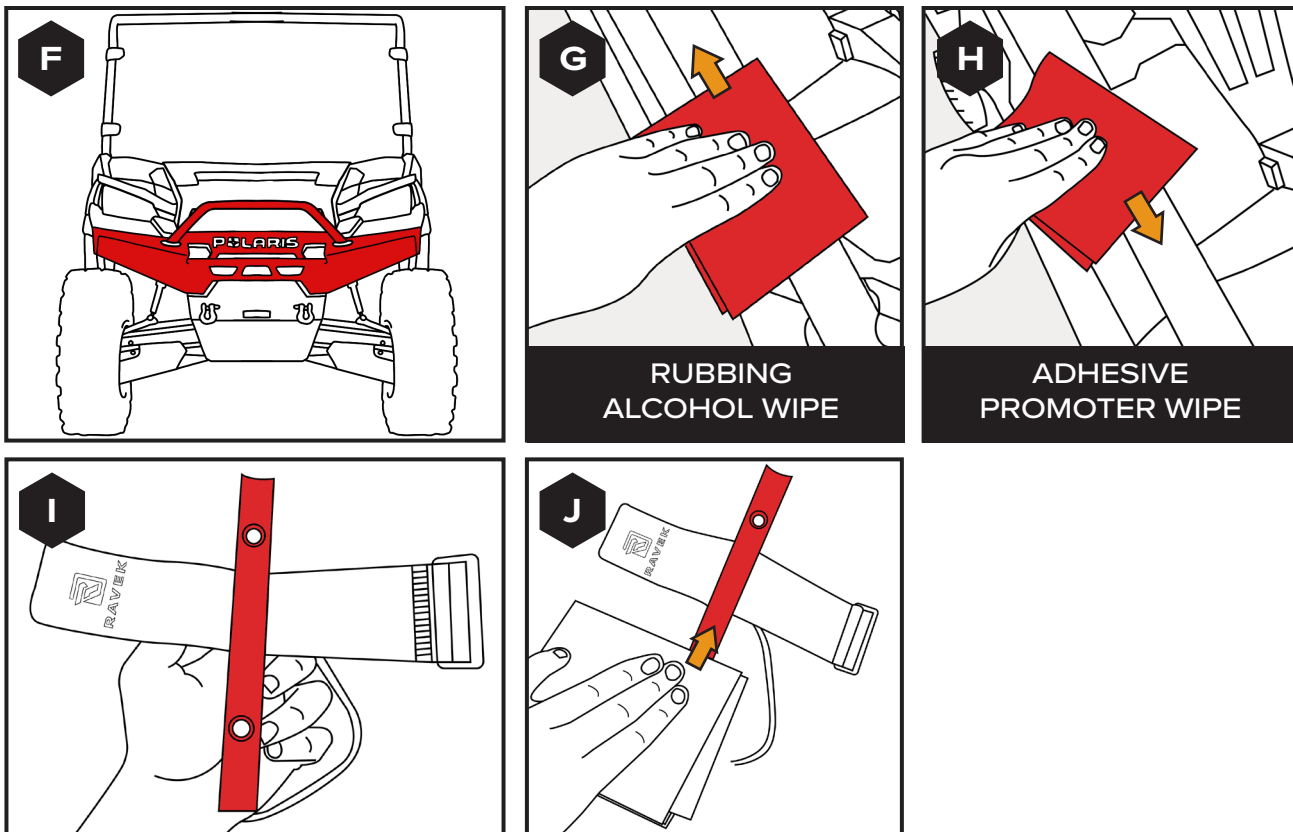



iv

## APPLY TAPE

Apply the double-sided tape to the dry Apex light's roll bar adapter, and attach the light to the surface you cleaned and prepared in the prior step. [SEE FIGURES K - N]

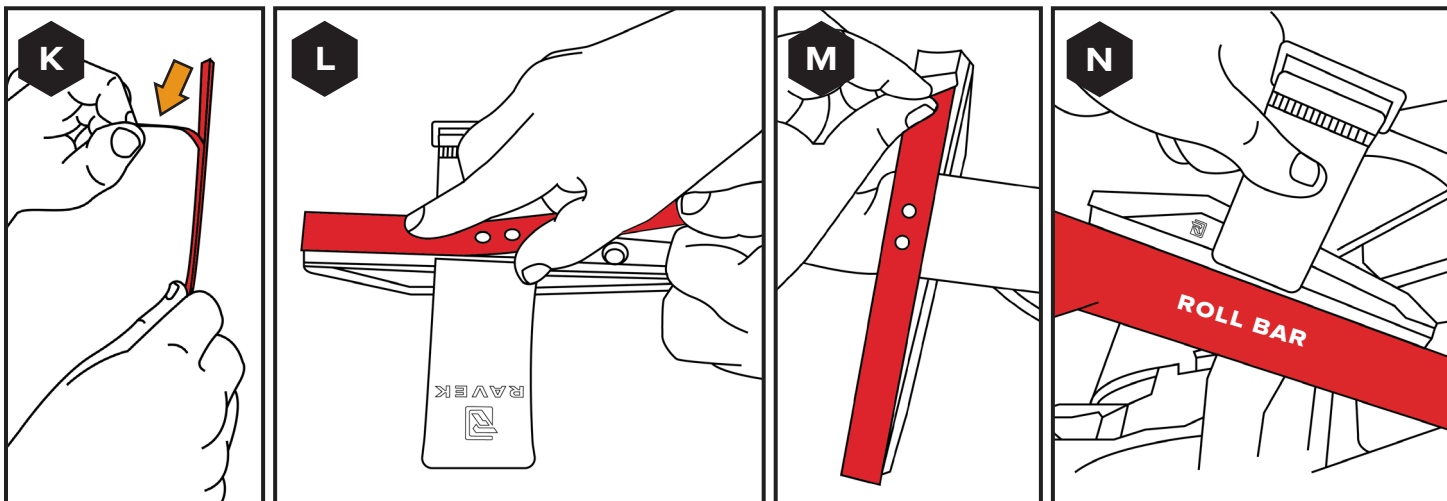

v

## TIGHTEN STRAP

Tighten straps onto base and roll bar. [SEE FIGURES O & P]

**NOTE:** If you have excess length of strap you can rotate the buckle away from the slack to reduce the slack in the strap.

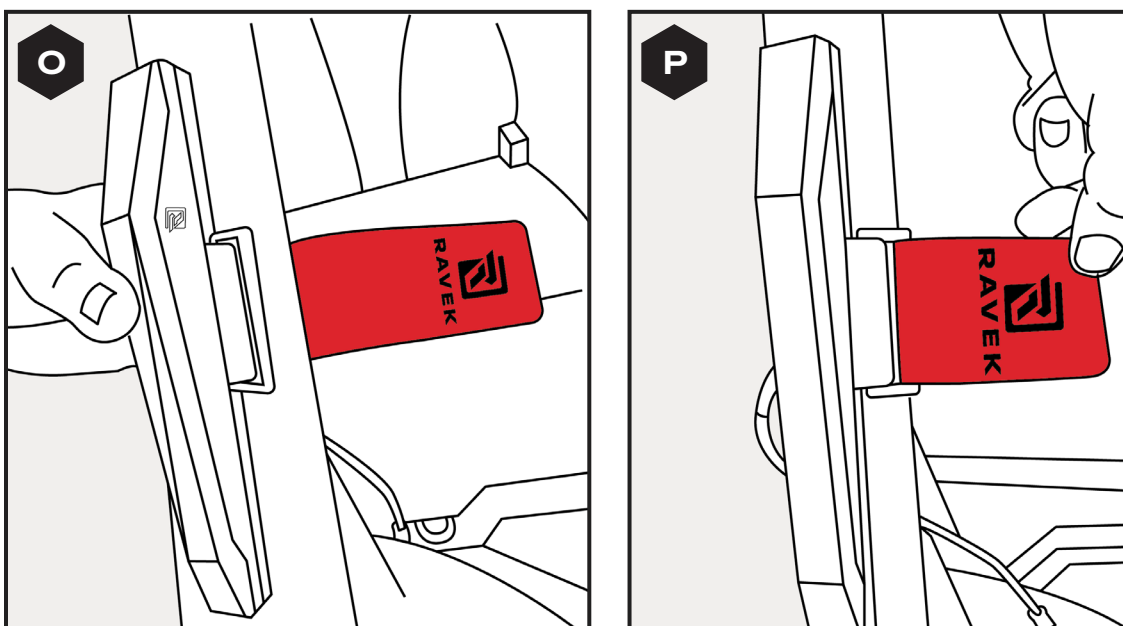

**JUMP TO STEPS 10-15 TO FINISH INSTALL**

## OPTION B DIAGRAM - ADHESIVE ONLY MOUNTING

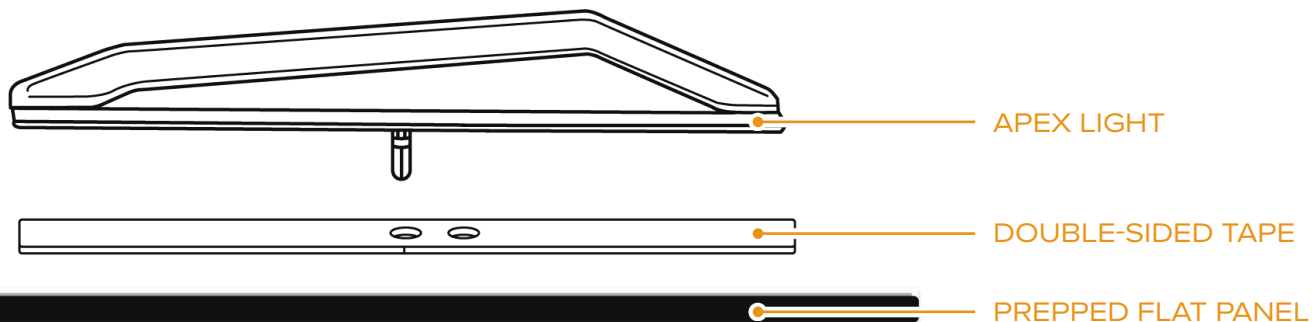

i

**LOCATE A SURFACE TO MOUNT TO**

Locate an exterior panel with 8" of flat surface for mounting. [SEE FIGURE A]

*NOTE: If you're adhesive mounting the Apex Lights to the roof, we recommend drilling a hole to feed the wires through. The Apex Light adhesive creates a water-tight seal.*

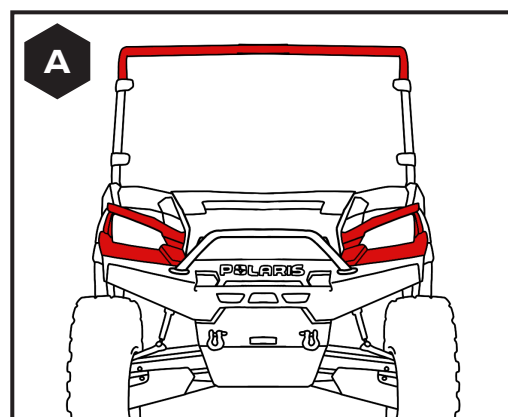

ii

**WIPE DOWN SURFACES**

Before you permanently install your Apex Light to the UTV's flat panel you've chosen, wipe down the panel and the base of the light with the rubbing alcohol wipe provided and let dry.

Next wipe down the panel and light base with the adhesion promoter wipe provided. Let dry. [SEE FIGURES B & C]

B

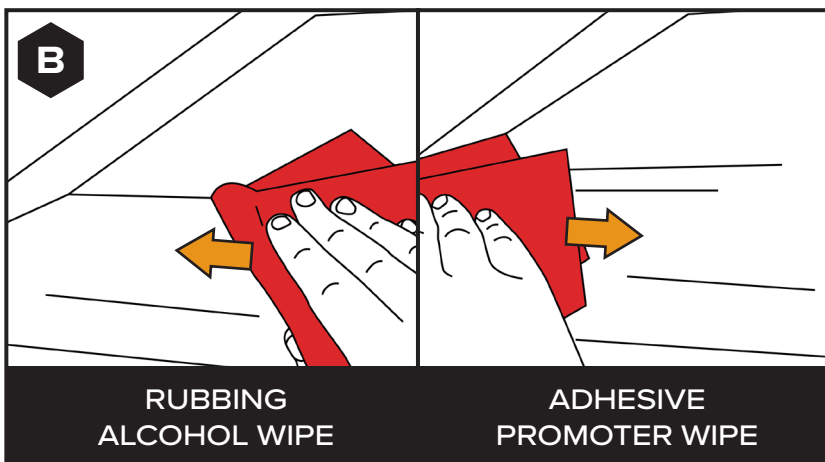

C

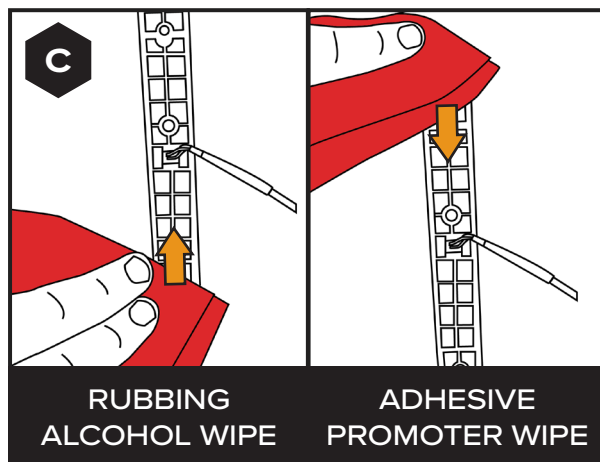



## APPLY TAPE

Apply the double-sided tape to the Apex light's base and affix the light to the prepped surface. [SEE FIGURES D - G]

**NOTE:** Be sure the whole light's base is in contact with the surface of the UTV to ensure the light will hold up permanently.

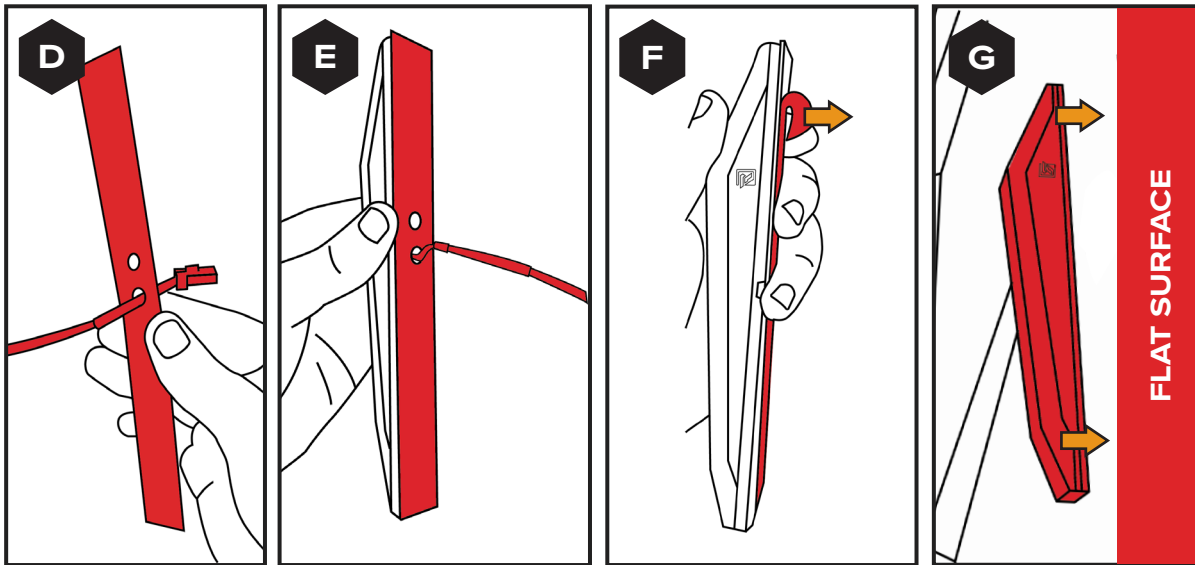

**JUMP TO STEPS 10-15 TO FINISH INSTALL**

9C

## OPTION C - DRILLED AND ADHESIVE MOUNTING:

### OPTION C DIAGRAM - DRILLED AND ADHESIVE MOUNTING

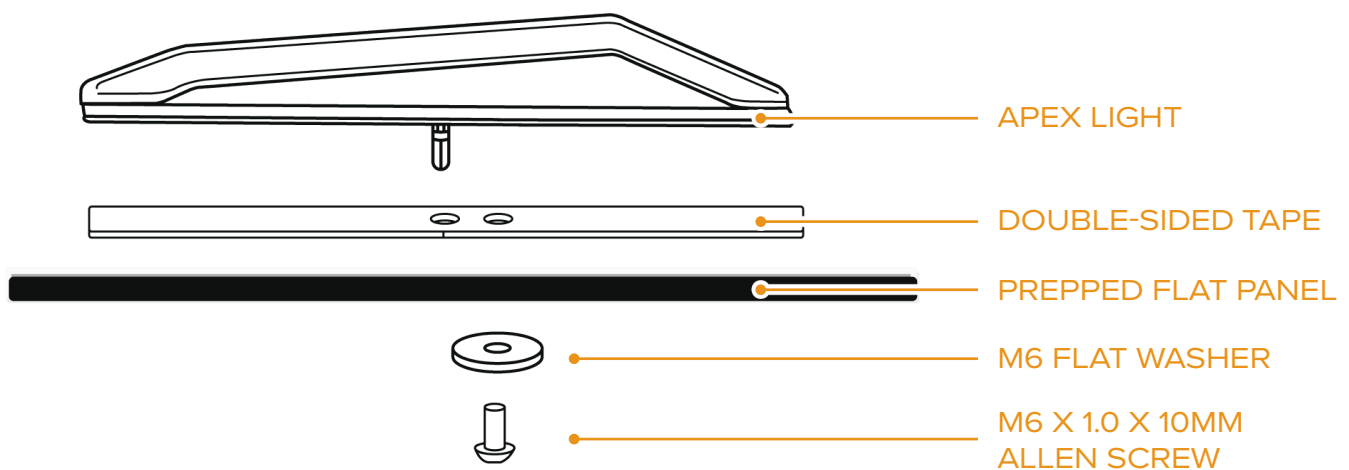

i

## LOCATE A SURFACE TO MOUNT TO

Locate an exterior panel with 8" of flat surface for mounting.  
[SEE FIGURE A]

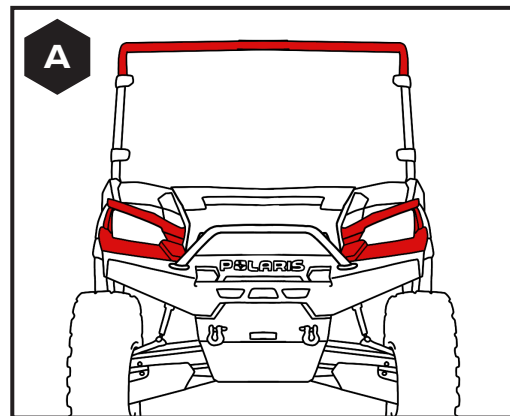

ii

## MARK HOLES TO DRILL

Use the double-sided tape holes as a template for the drilling locations. Confirm you can access the inside of the panel that you'll need to be able to access this area with your flat washer. [SEE FIGURES B - D]

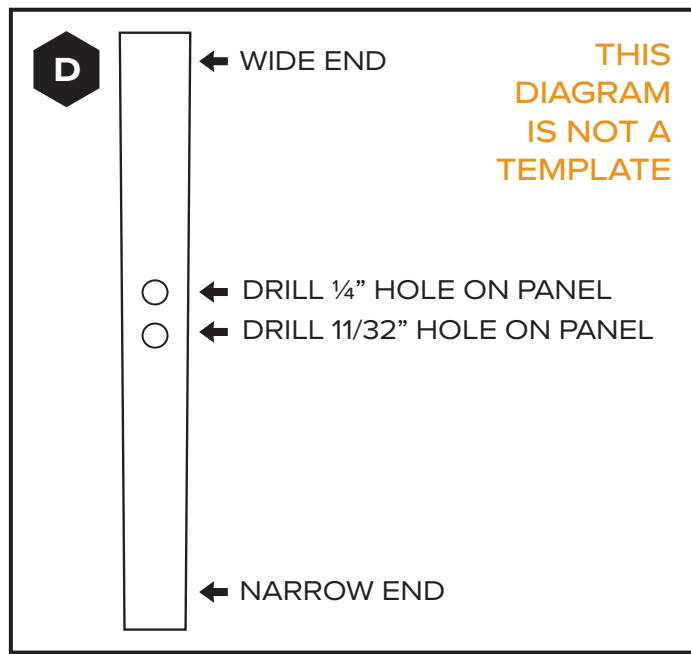
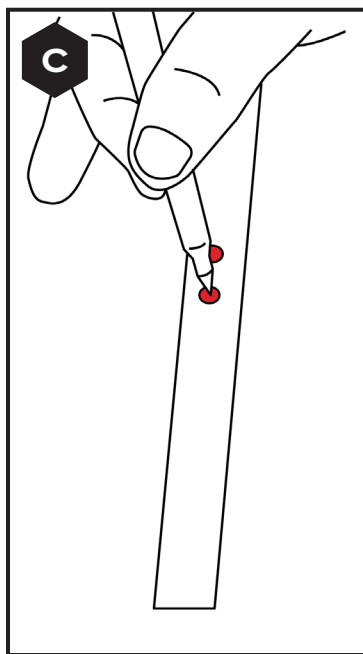
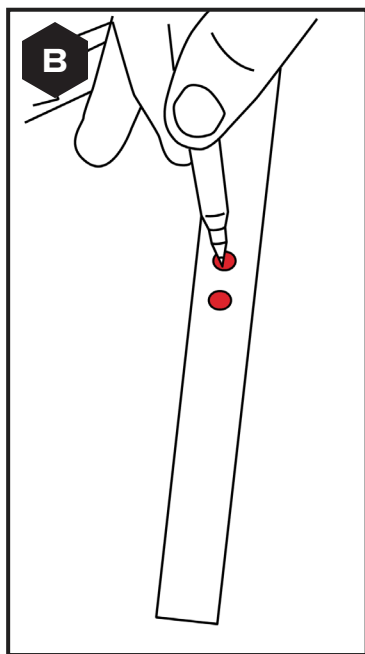

iii

## DRILL 1/4" HOLE

Once you have your holes marked, drill a 1/4" hole that will be used to feed the screw through.

**NOTE:** We recommend using a brad point drill bit to avoid damaging your panel.

iv

## DRILL 11/32" HOLE

Drill a 11/32" hole that you will feed the Apex Light's wire connector through.



## WIPE SURFACE WITH RUBBING ALCOHOL

Before you permanently install your Apex Light to the UTV's flat panel you've chosen, wipe down the panel and the base of the light with the rubbing alcohol wipe provided and let dry.

Next wipe down the panel and light base with the adhesion promoter wipe provided. Let dry. [SEE FIGURES E & F]

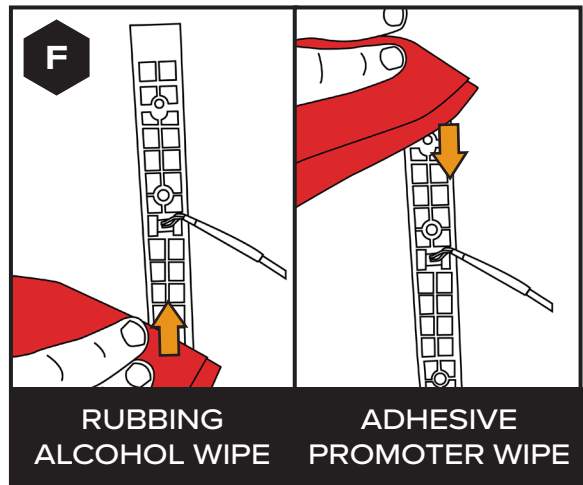

## APPLY TAPE

Apply the double-sided tape to the Apex Light's base. [SEE FIGURES G - I]

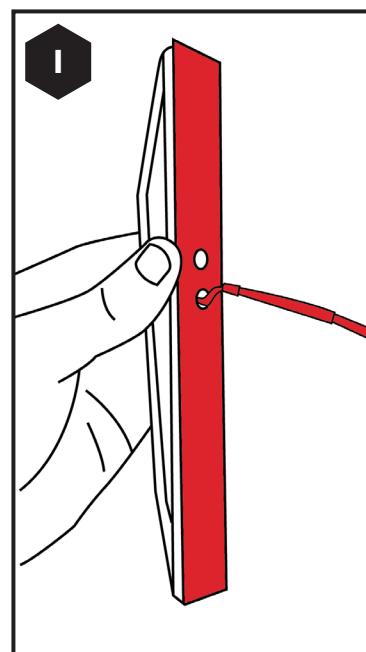
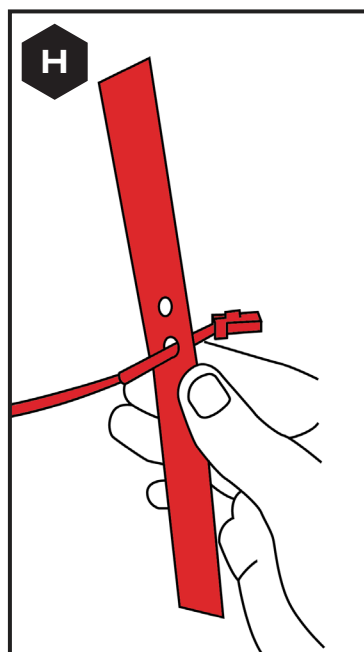
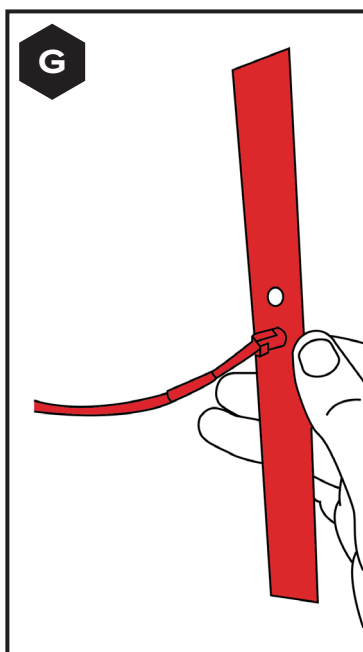

vii

## ADHERE LIGHT TO PREPPED SURFACE

Feed your light's wiring through the 11/32" hole. Peel away the double-sided tape cover, and stick the Apex Light to the prepped surface. [SEE FIGURES J - L]

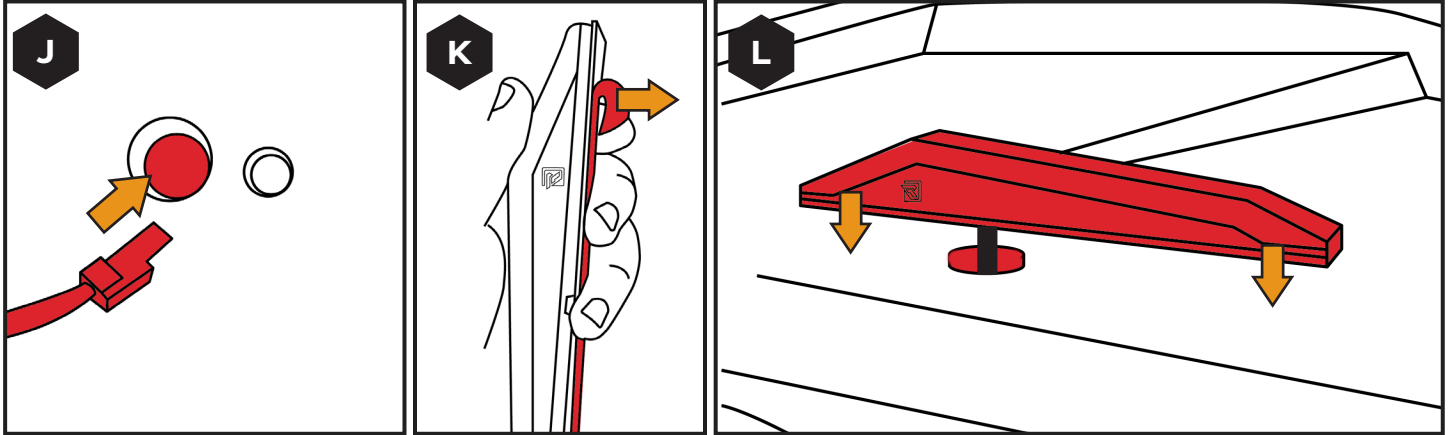

viii

## THREAD IN SCREW

Thread your M6 x 1.0 x 10mm Socket Allen Screw with an M6 Flat Washer through the backside of the panel into the light's base using a 4MM ALLEN WRENCH. [SEE FIGURES M & N]

**NOTE:** If a longer screw is required, you have two options:

1. Give us a call or email, and we will express mail you a screw of the length you need.
2. Go to your local hardware store and purchase a M6 x 1.0 x (your desired length).

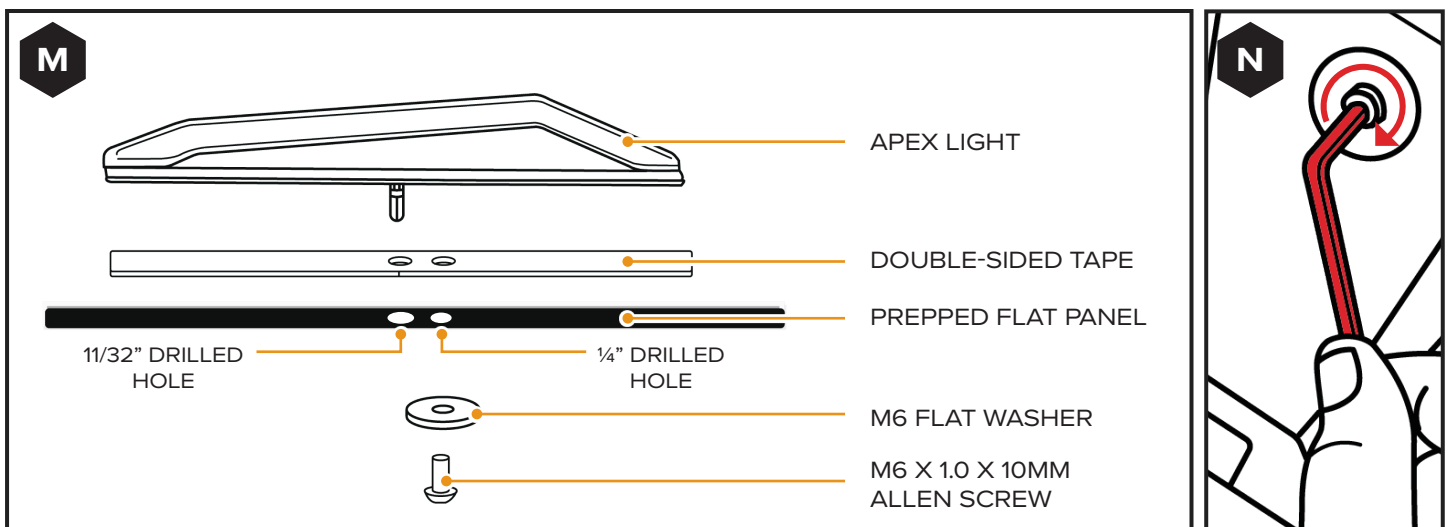

**JUMP TO STEPS 10-15 TO FINISH INSTALL**



i

- Grab your Turn Signal rocker switch and extension wire. Feed the extension wire through the front of the rocker switch adapter.
- Feed the extension wire through your chosen open slot in your switch panel.
- Route the small plug on the extension wire through the firewall grommet and connect it to the controller. [SEE FIGURES 10A – 10C]

**NOTE:** The easiest way to route the extension wire is through the adapter, then the rocker switch open slot, and finally through the firewall grommet to reach the controller, as described above.

**NOTE:** Repeat this process with the Horn/Hazard Switch extension wire.

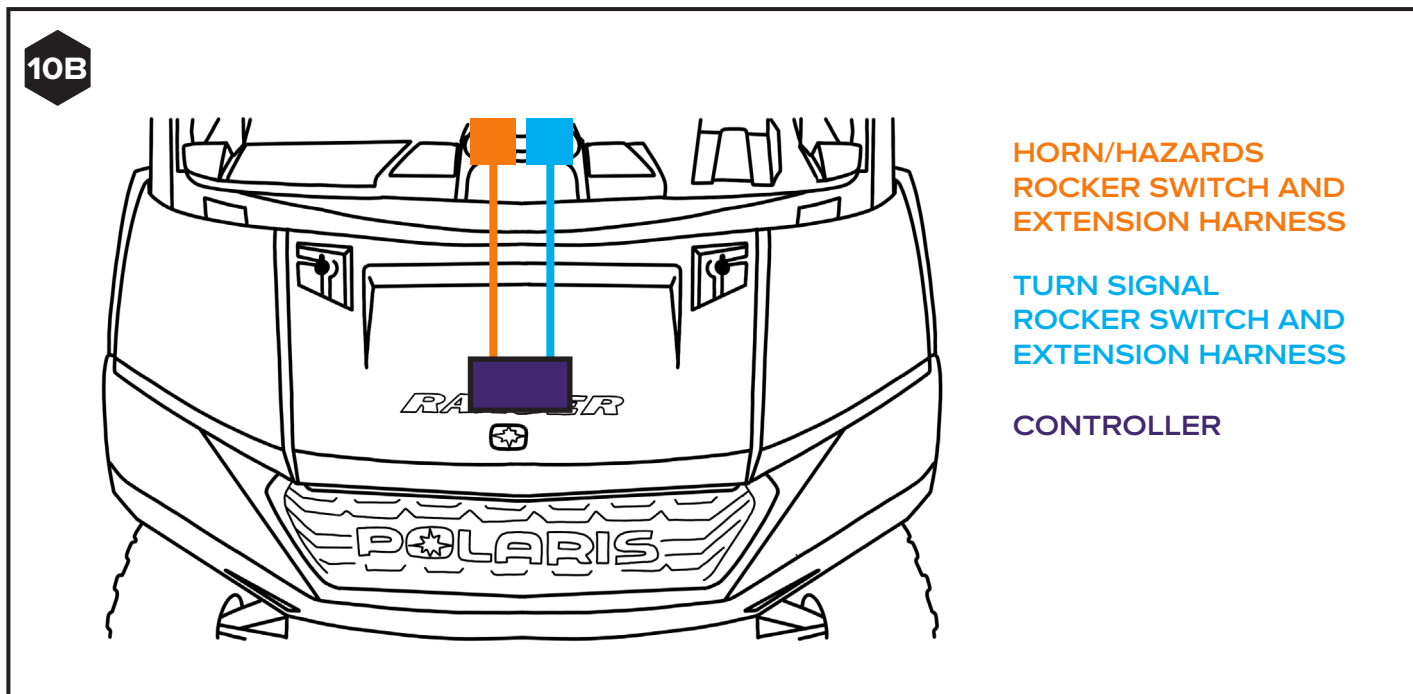
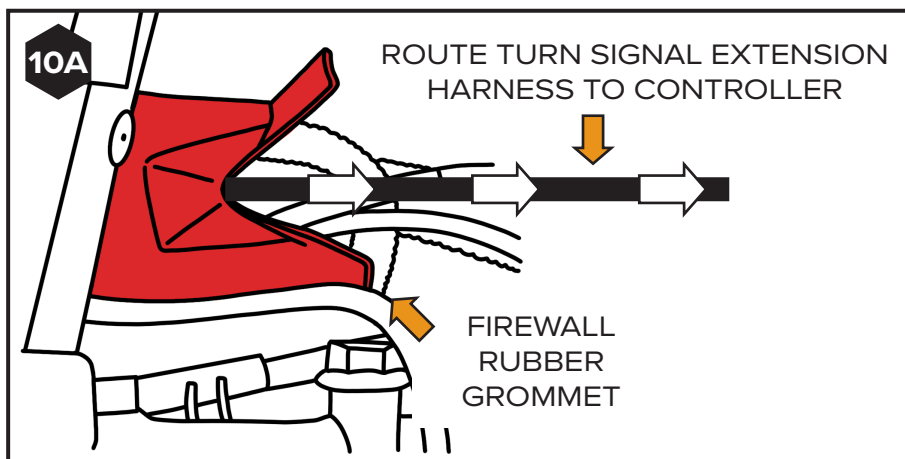

i

Return to the Turn Signal Controller and route the Horn Extension harness to the front of the Ranger, where you will permanently mount the Horn reusing an OEM bolt that you select.

ii

Grab your horn once your wiring is fed to the front area. [SEE FIGURE 11A]

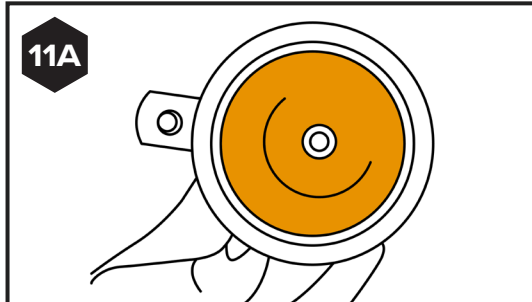

iii

Install the horn in an open area that is out of the way of suspension or moving parts of the Ranger, reusing a bolt location you choose on the front of the Ranger. [SEE FIGURE 11B]

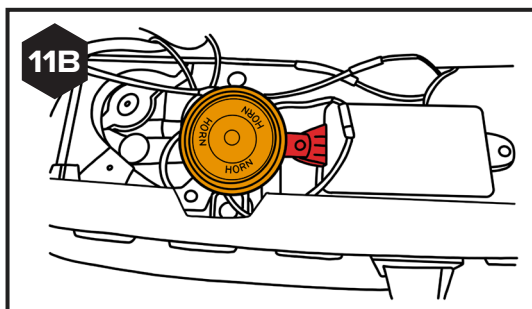

iv

Plug both spade connectors from the extension harness to the connectors on the backside of the horn (no specific connector to plug into). [SEE FIGURE 11C]

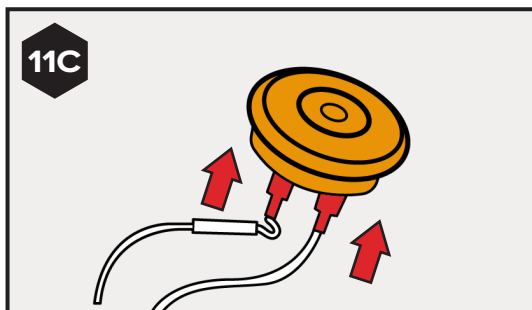

i

Return to the Turn Signal Controller and hook up the ring terminals from the Power Harness to the bus bar located behind the center hood panel removed in step 1i. [SEE FIGURE 12A]

Hook up your power harness ring terminals as follows: red ring terminal to the left terminal at the bus bar (red to far-left terminal) and the black ring terminal to the middle terminal (black to middle terminal).

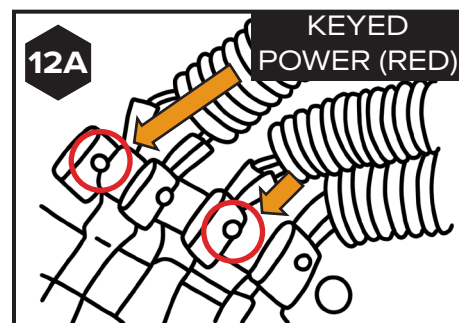

i

Remove gauge cluster and Unplug the connector in the backside [SEE FIGURE 13A]

ii

Remove the clear gray cover on the connector by depressing the white tabs at each end and sliding it up. [SEE FIGURES 13A – 13C]

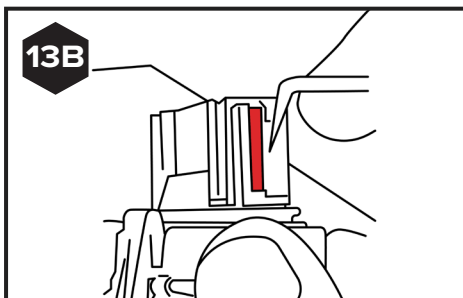
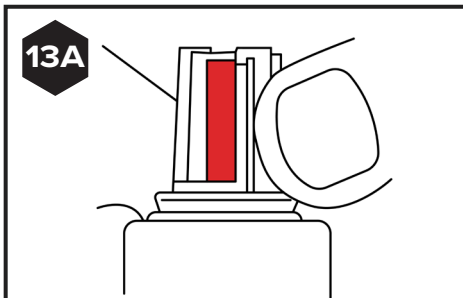

iii

Once the connector is unplugged, access the pins through the backside using a small flathead screwdriver to open the connector housing carefully. [SEE FIGURES 13E – 13G]

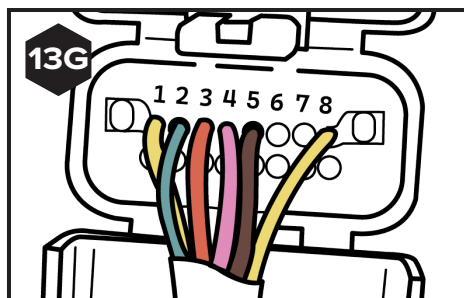
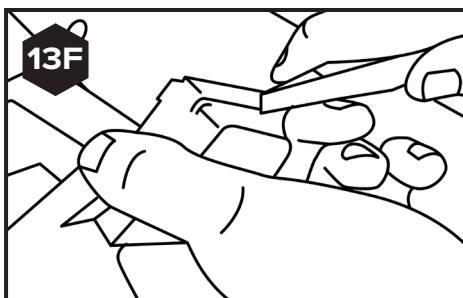
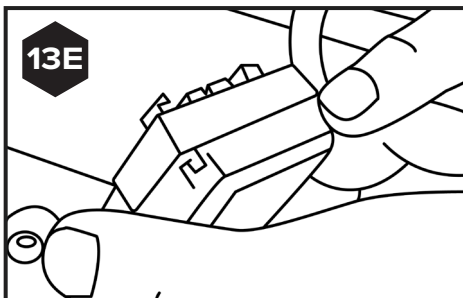

iv

Remove the plastic pin inserts on terminals 6 and 7 by pulling them outward. These pins are numbered on the wire side of the plug [SEE FIGURES 13H & 13I]

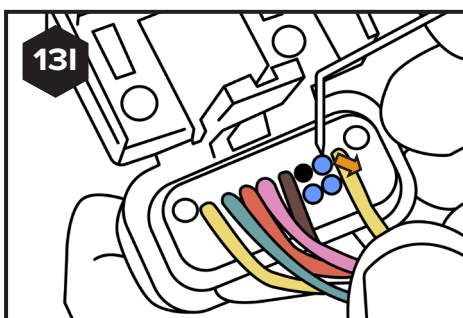
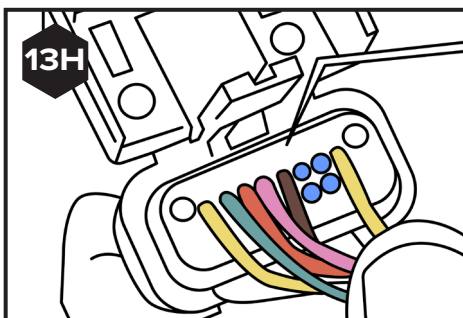



Grab your RIGHT DI wire, insert the pin from the wire into terminal 6, and verify it lines up evenly with the other pins. [SEE FIGURE 13J & 13K]

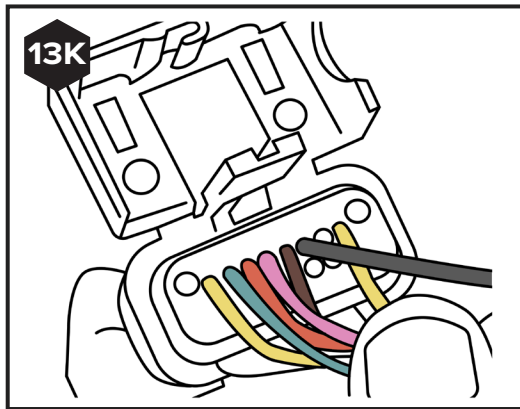
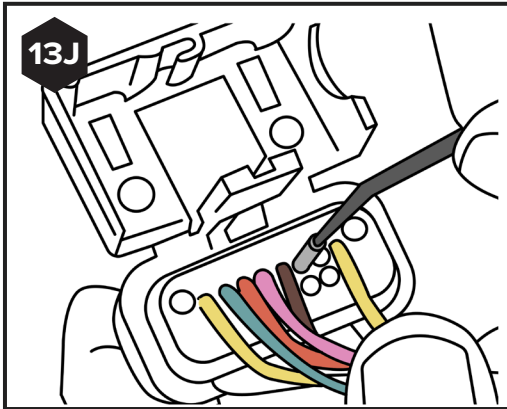

Repeat the previous step with the LEFT DI wire on terminal 7. [SEE FIGURE 13L]

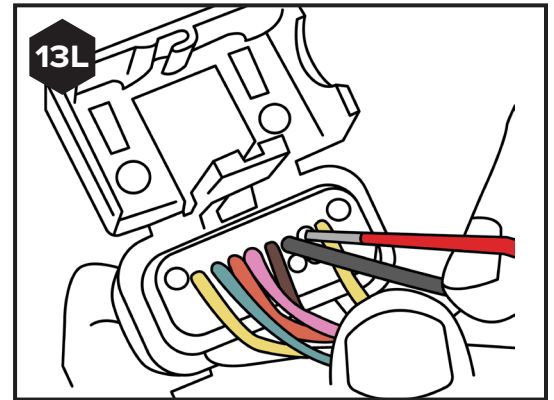

Once pins are precisely inserted and aligned into their respective terminals, reinstall the tinted cover onto the plug (cover removed in step 13.ii).

Next, snap the grey cover closed and plug the connector to the gauge cluster. [SEE FIGURES 13M & 13N]



**VERIFY ALL PINS ARE PERFECTLY  
ALIGNED TO EACH OTHER**

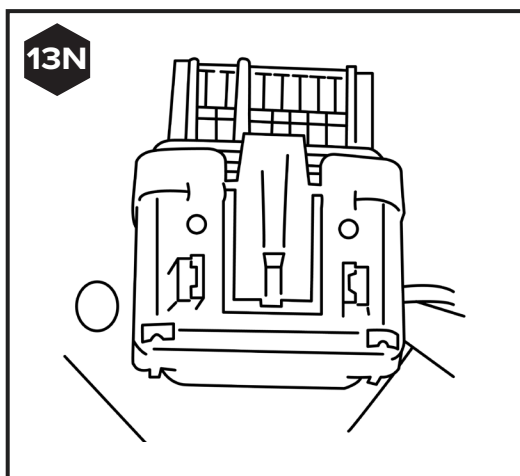

i

Now it's time to confirm the kit is working as designed, but before reconnect your battery by reversing step 1.iv.

With you battery connected turn your Ranger's Power on, and test all the kit's features:

- Running brake lights
- Running white lights
- Brake light w/ pulse effect
- Left turn signal → 15 second auto cancel
- Left turn signal dash indicator (in gauge cluster)
- Right turn signal → 15 second auto cancel
- Right turn signal dash indicator (in gauge cluster)
- Hazards
- Horn (plug your ears)

i

Once the function of the kit is verified and everything is working appropriately, go over all your connection points and heat shrink them (if you have not done so already) as mentioned in step 3.

ii

Use the zip ties supplied in the kit, secure all of your wiring to frame tubes or roll bars (away from hot or moving components).

iii

Once all of your wiring is secured with the help of the zip ties, cut all the excess zip ties using side cutter pliers.

iv

Place the two strips of double-sided tape provided in the kit on the backside cavities on the controller. [SEE FIGURE 15A]

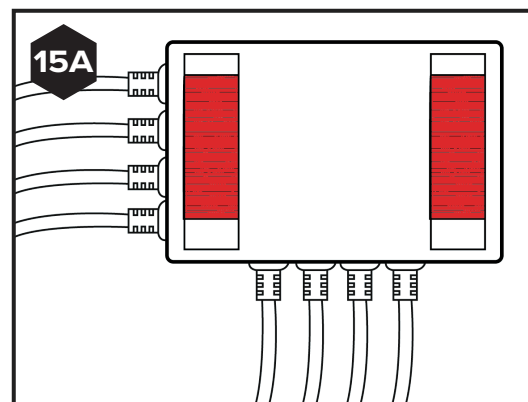

v

Locate a nice flat surface to stick the controller to. Clean the surface with the Rubbing Alcohol Wipe and Adhesive Promoter Wipe provided in the kit, and let dry before continuing.

vi

Once the surface is clean and dry, stick your controller to your chosen location and let the tape cure for 24 hours before riding. [SEE FIGURE 15B]

**RAVEK RECOMMENDED SPOT IS UNDERNEATH HOOD PANEL REMOVED IN STEP 1.i**

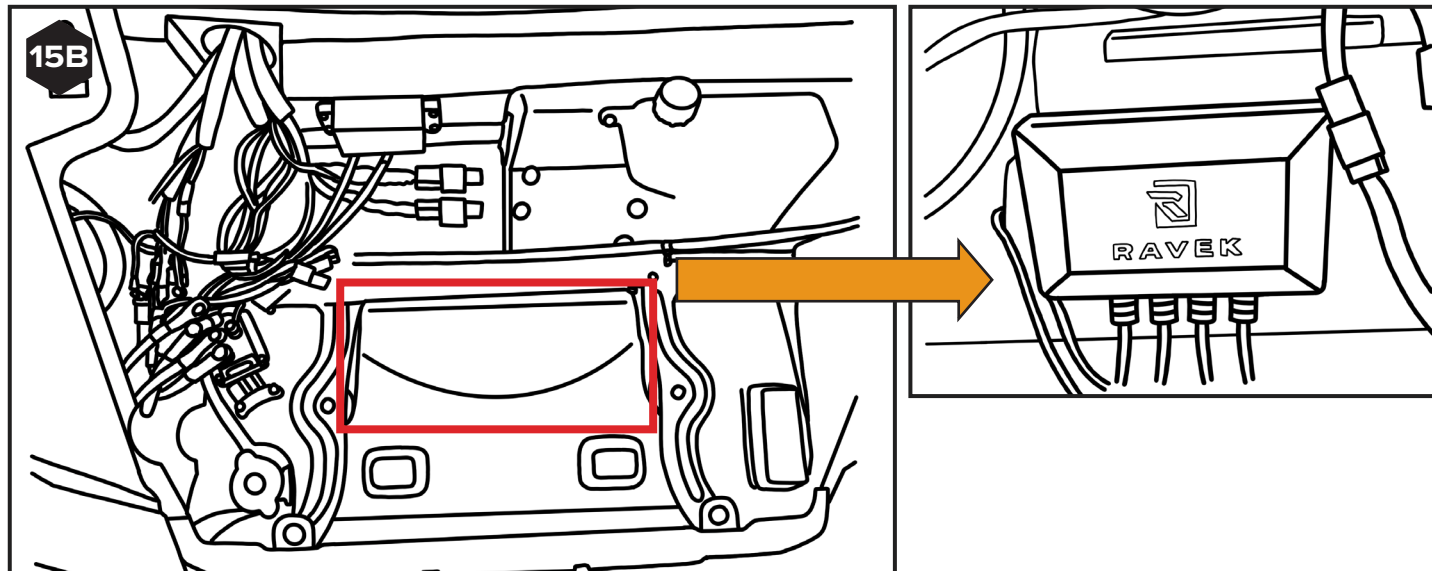

vii

Reverse steps 1i-1viii to reinstall all your Ranger's body panels and parts that were previously removed.





# RAVEK

BUILT FOR MORE

## WHY RAVEK

Stock UTVs don't come with enough storage, lighting, comfort, and protection. That's why we started RAVEK.

We live to design, manufacture, and test innovative SxS upgrades that elevate the riding experience. Here's what you can expect from us:

- Durable products built to last (100% lifetime guarantee)
- UTV upgrades thoughtfully designed & tested by riders
- Outstanding installation support (videos & USA customer service)
- Constant flow of epic riding content (check out our social media)

We're confident your RAVEK product will earn its place on your machine. Please call or e-mail us if we can help.

- Harry & Ricky (Brothers & Owners)

## MESSAGE FROM THE DESIGNER

All UTVs come without turn signals, and even though you can ride them on the road, people need to make hand signals to indicate to other riders that you are making a turn! Not only is it tiring, but not safe!

That is why I created this kit: you can easily install a turn signal kit to your UTV, add some personality to your ride, and make your ride safe at any time of the day.



**RAVEK**  
BUILT FOR MORE