



# RAVEK

POLARIS RZR 2024+

## ***ARMRESTS***

HEAVY-DUTY ADJUSTABLE

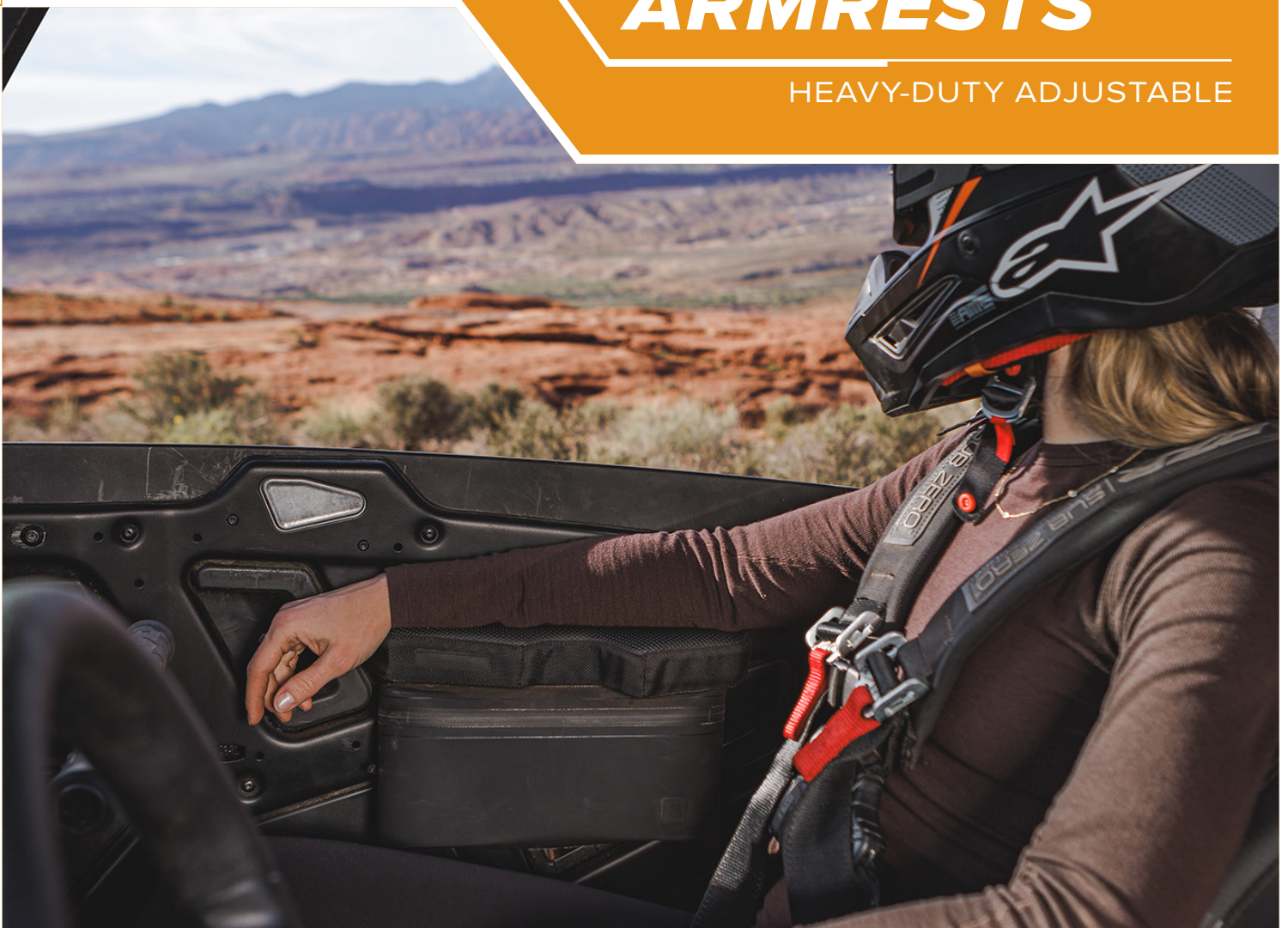

# INSTRUCTION MANUAL



# RAVEK

POLARIS RZR 2024+

## ARMRESTS

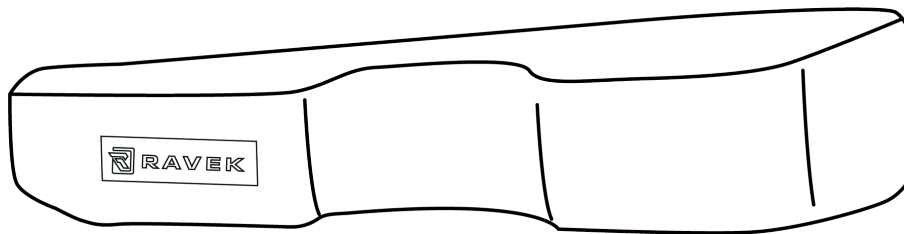

Part #: 64-306

Fitment: RZR XP 2024+

### PARTS INCLUDED:

- L-MOUNT BRACKET (4x)
- DRIVER ARMREST PAD (1x)
- PASSENGER ARMREST PAD (1x)
- M6 X 1.0 NYLOC NUT (4x)
- M6-1.0 X 15MM ALLEN SCREW(4x)
- 1/4-20 X 3/4IN LONG PHILLIPS PAN HEAD SCREW (4x)

### TOOLS NEEDED:



10mm Wrench



Phillips Screwdriver

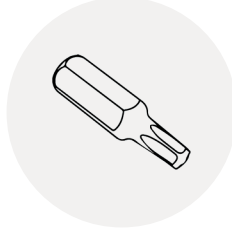

T-20 Torx Driver



4mm Allen Wrench

**DON'T LIKE INSTRUCTIONS?**  
**CHECK OUT THE**  
**VIDEO TUTORIAL**



**1**

## REMOVE DOOR PANEL

Starting from the driver's side of the RZR, use a T-20 TORX to remove the nine screws highlighted in the figure below. [SEE FIGURE 1A]

Once the screws are removed, remove the door panel.

*NOTE: Hardware removed will be reutilized in a future step.*

*NOTE: Detach your door's latching cable before removing your door panel.*

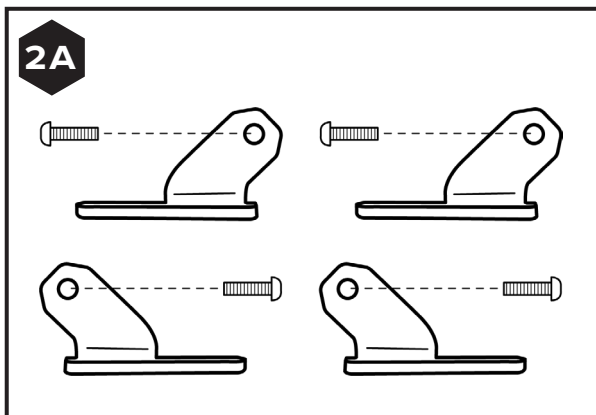
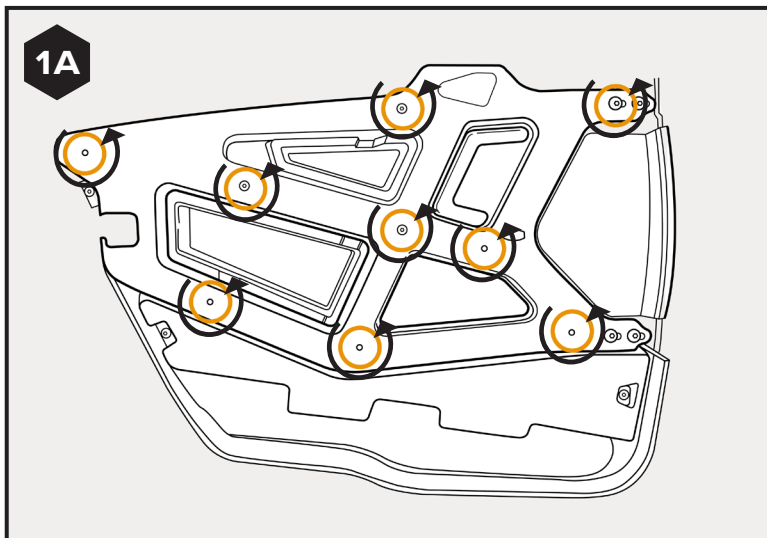

**2**

## INSTALL THE L-MOUNT BRACKETS

**A**

Identify the L-mount brackets on your kit. [SEE FIGURE 2A]

**B**

Now it's time for you to choose what armrest height and angle works best for you. By using different combination of the mounting holes on the stock OEM door frame and orientation of the L-mounts you can customize the height and angle of your armrest. [SEE FIGURES 2B – 2C]

**NOTE:** We suggest sitting in your RZR and loosely installing different combinations of armrest heights and angles to see what feels most natural to you. **We recommend C1!**

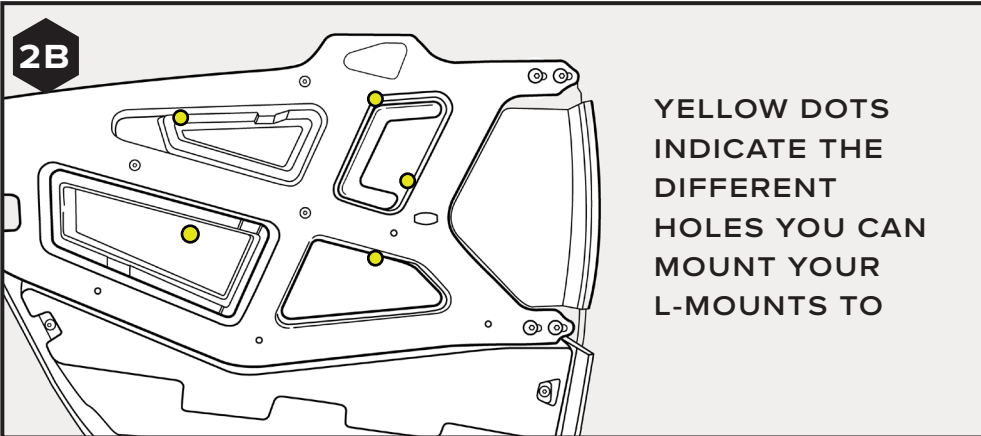
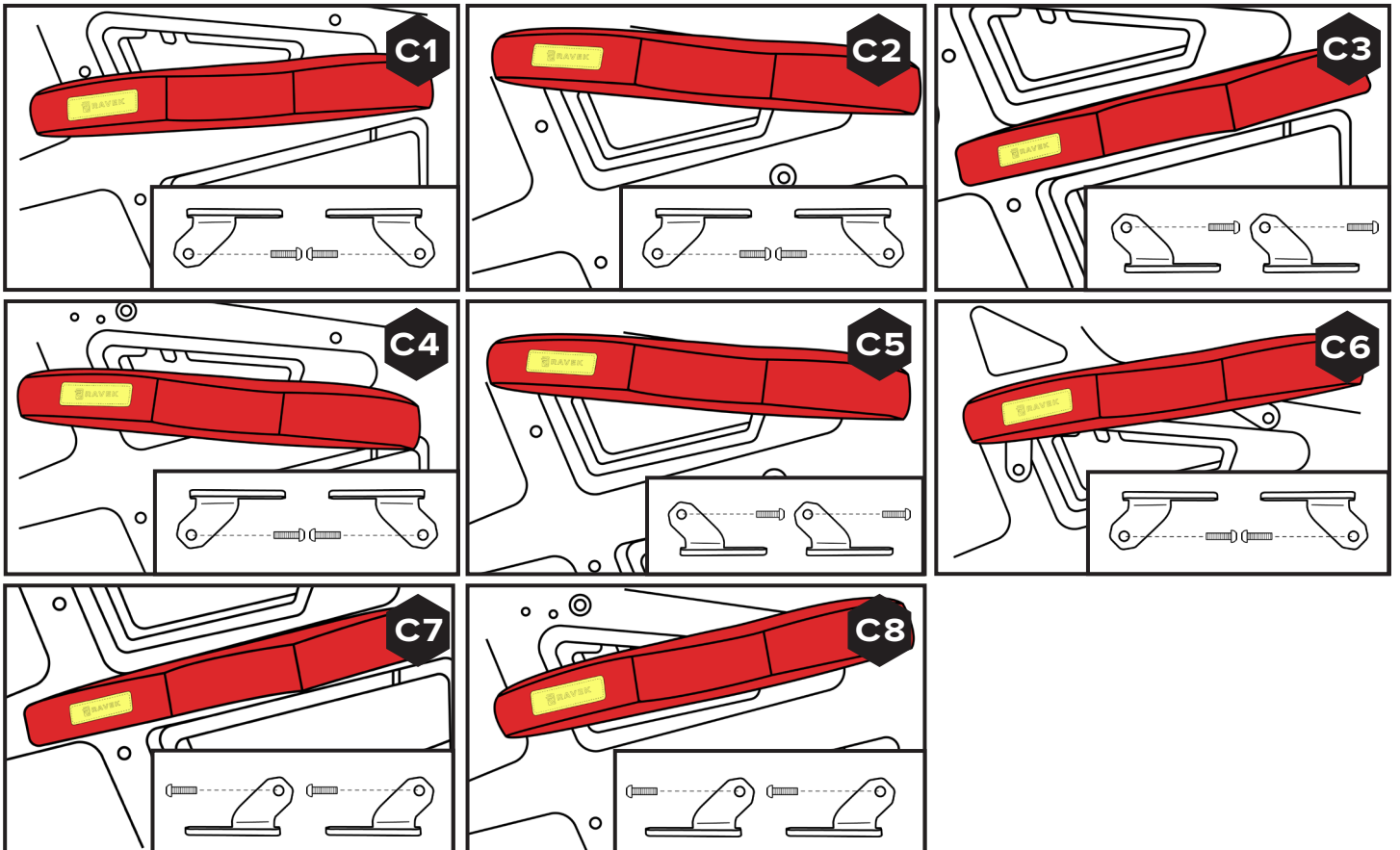
**2B****2C**

3

## SECURE L-MOUNTS

Now that you have decided the best pad height and angle on your RZR. Using a 4MM ALLEN WRENCH and 10MM WRENCH secure the L-mounts to the door's frame with two M6 X 1.0 Nylock Nuts and two M6-1.0 X 15MM Allen Screws. [SEE FIGURE 3A]

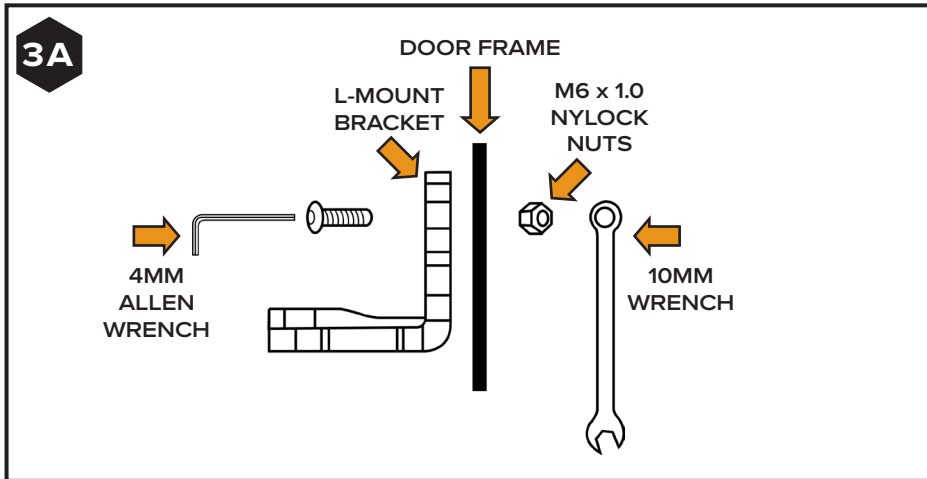

4

## REINSTALL DOOR PANEL

With your L-mounts secured to the door's frame. Reinstall the RZR's door panel by reversing step 1.

**NOTE:** Do not over-tighten stock OEM hardware on the door panel as it can cause damage.

**NOTE:** Do not forget to reinstall your door latching cable.

5

## INSTALL THE ARMREST PAD

A

Identify your driver's side armrest pad. [SEE FIGURE 6A]

5A



DRIVER ARMREST PAD

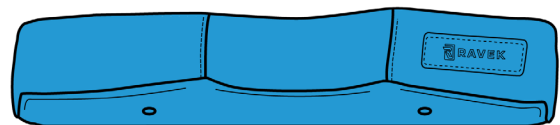

PASSENGER ARMREST PAD

**B**

Using two ¼-20 X ¾IN PHILLIPS SCREWS and a Phillips screwdriver, install the driver's side pad. [SEE FIGURE 5B]

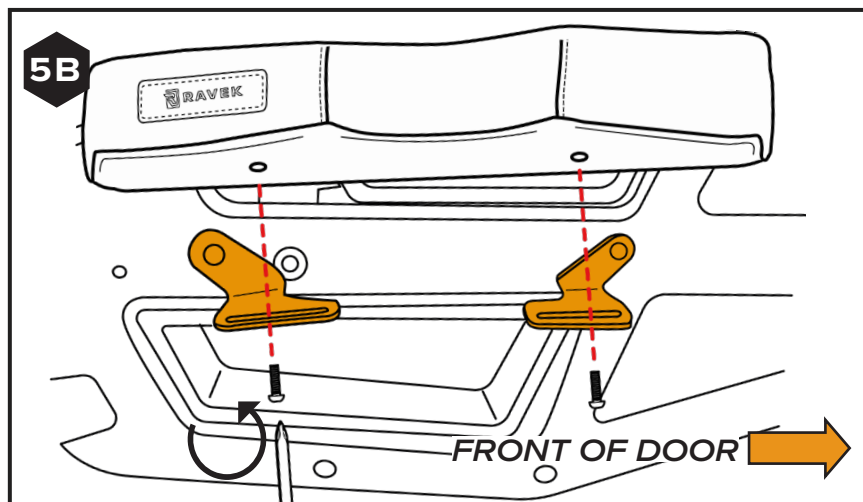
**6**

## **WANT STORAGE?**

Add RAVEK's Polaris RZR XP 2024+ Armrest Pouches. Each pouch is designed to mount to your new armrest. (RAVEK Part #: H64-300PO)

**7**

## **REPEAT STEPS 1 - 5**

Repeat steps 1-5 on the right side of the RZR to install the passenger's side armrest.





# RAVEK

BUILT FOR MORE

## BRAND MESSAGE

Stock UTVs don't come with enough storage, lighting, comfort, and protection. That's why we started RAVEK.

We live to design, manufacture, and test innovative SxS upgrades that elevate the riding experience. Here's what you can expect from us:

- Durable products built to last (100% lifetime guarantee)
- UTV upgrades thoughtfully designed & tested by riders
- Outstanding installation support (videos & USA customer service)
- Constant flow of epic riding content (check out our social media)

We're confident your RAVEK product will earn its place on your machine. Please call or e-mail us if we can help.

- Harry & Ricky (Brothers & Owners)

## MESSAGE FROM THE DESIGNER

From the initial design phase, we knew these armrests had to be extremely durable, comfortable, and adjustable to fit different rider sizes and riding styles.

After extensive design, engineering, prototyping, and aggressive field testing, these armrests came out just the way I'd hoped.

They're 100% waterproof, have 350 lbs. of load-bearing capacity, have over 8 adjustable positions at installation, and are filled with premium memory-foam padding. I love riding with them and expect you and your crew will too.



**RAVEK**

BUILT FOR MORE