



POLARIS RANGER XP 1000 2025+ **PLUG & PLAY AUTO-CANCEL UTV TURN SIGNAL KIT**

PART #: 64-1008 FITMENT: POLARIS RANGER XP 1000 2025+

TOOLS NEEDED:



*Side Cutter
Pliers*



*Push Pin
Pliers*



*Needle Nose
Pliers*



Pick



*T-30
Torx*



Ratchet



*10mm
Socket*

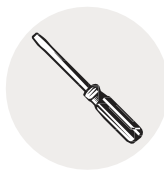

*Small Flathead
Screwdriver*



*T-40
Torx*

PARTS INCLUDED:

- **Controller (1x)**
- **Insert with Apex Light (2x)**
- **Horn (1x)**
- **Power Harness (1x)**
- **Turn Switch (1x)**
- **Horn/Hazards Switch (1x)**
- **Switch Extension Harness (2x)**
- **Rear Extension Harness (1x)**
- **M6 Nut (2x)**
- **Rear Harness (1x)**
- **License Plate Harness (1x)**
- **License Plate Illuminator (1x)**
- **Dash Indicator Harness (2x)**
- **Dielectric Grease (1x)**
- **Heat Shrink (1x)**
- **Roll Bar Adaptor (2x)**
- **Strap (2x)**
- **M6 x 1.0 x 16mm Allen Screw (2x)**
- **Wire Ties (20x)**
- **Double Sided Tape Strip (2x)**
- **M6 Flat Washer (2x)**
- **M5 x 0.8 x 6mm Allen Screw (4x)**
- **M6 x 1.0 x 10mm Allen Screw (4x)**
- **Adhesive Promoter Wipe (1x)**
- **Rubbing Alcohol Wipe (1x)**

INSTALL VIDEO TUTORIAL

**CALL US WITH ANY
QUESTIONS: 855-617-2787**



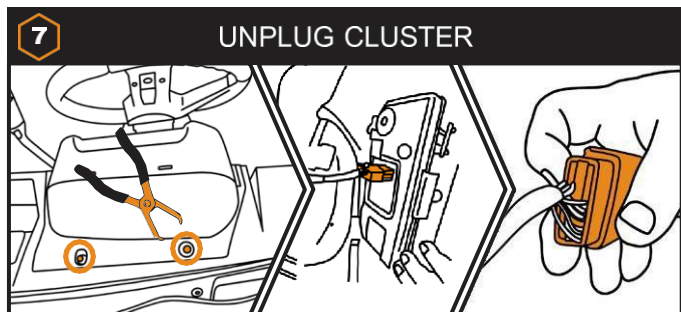
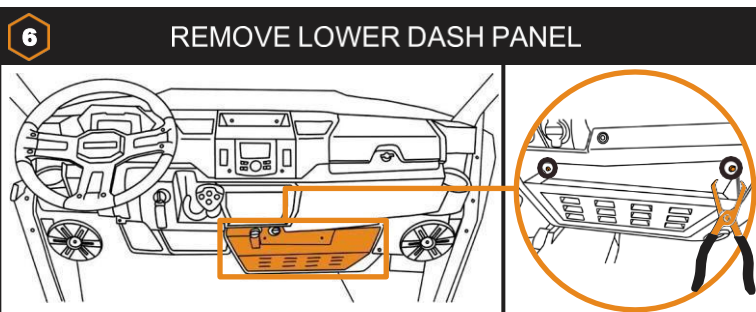
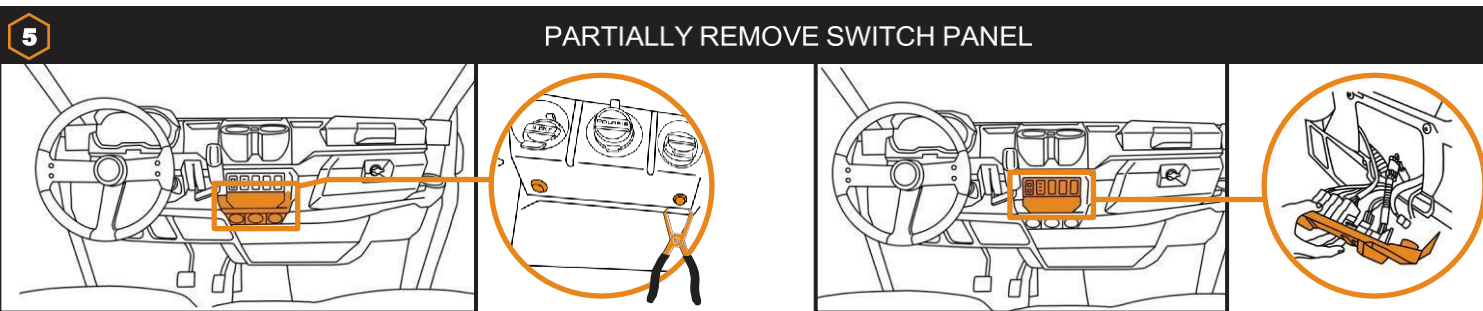
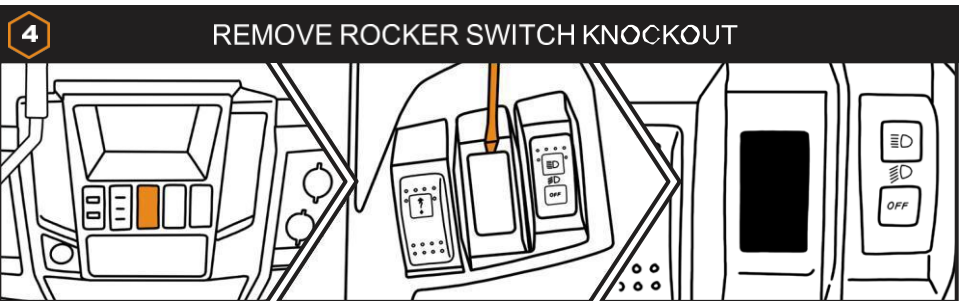
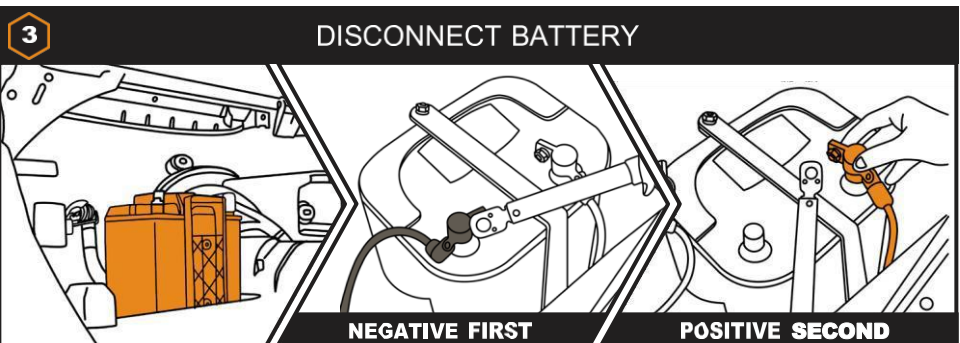
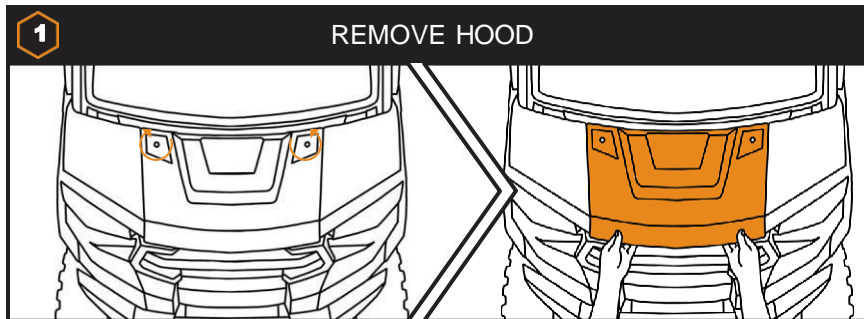

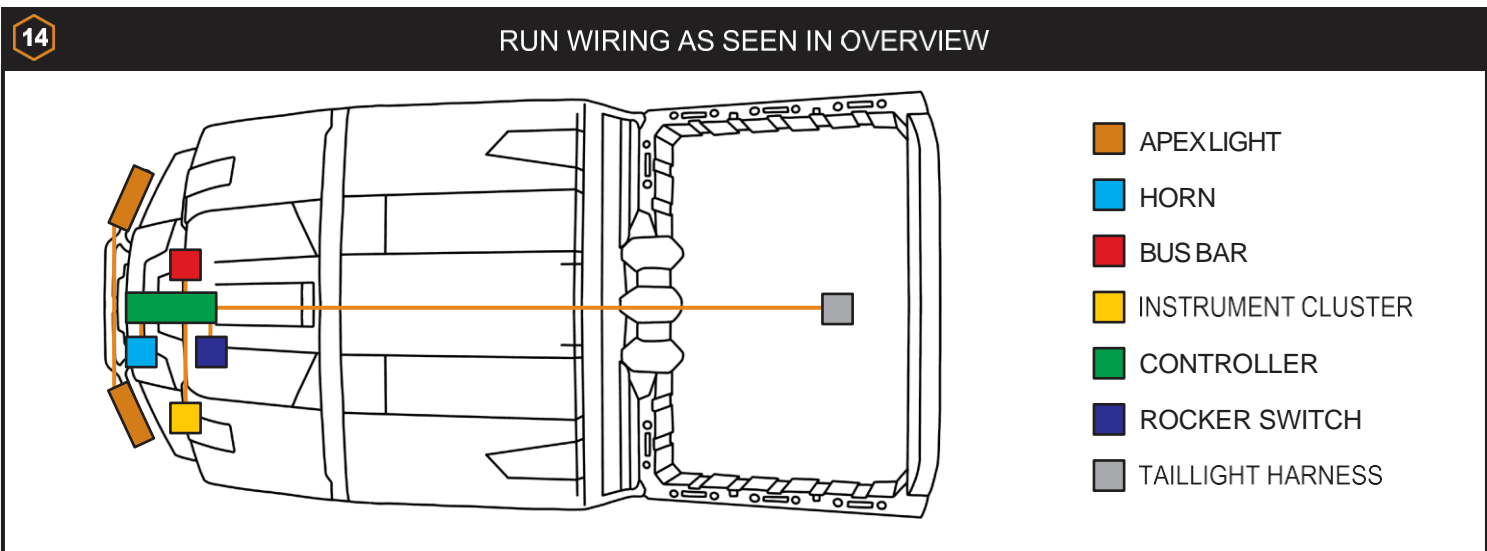
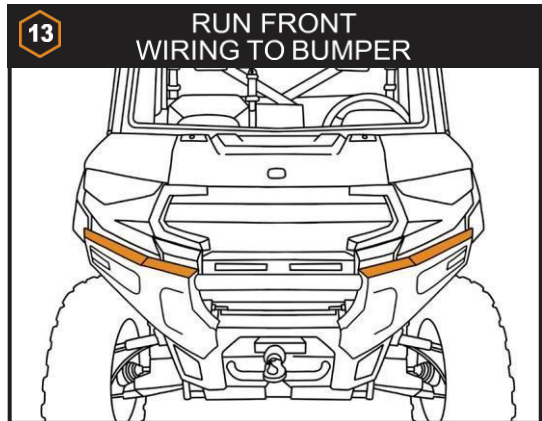
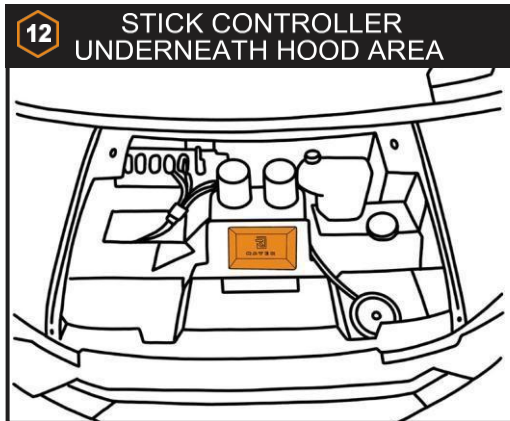
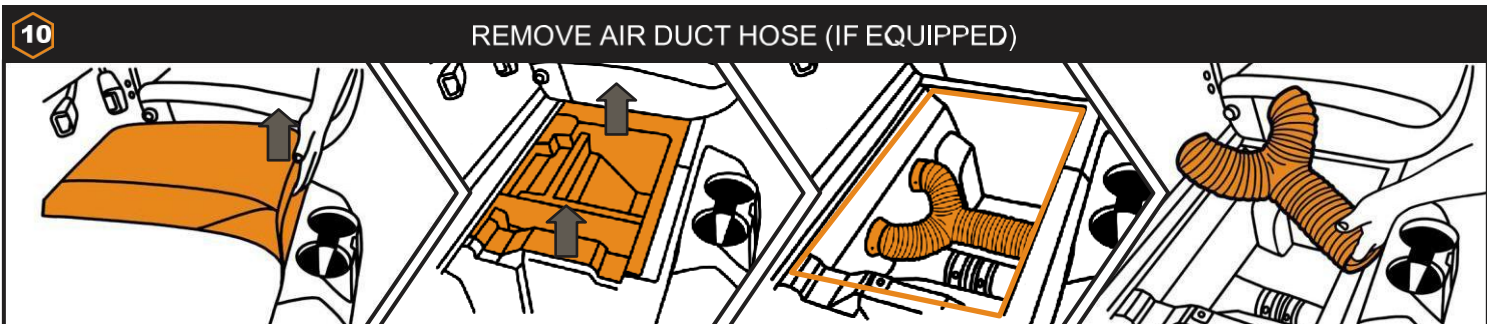
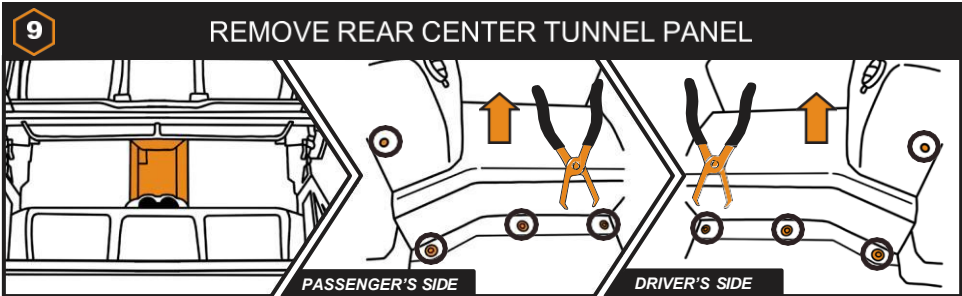
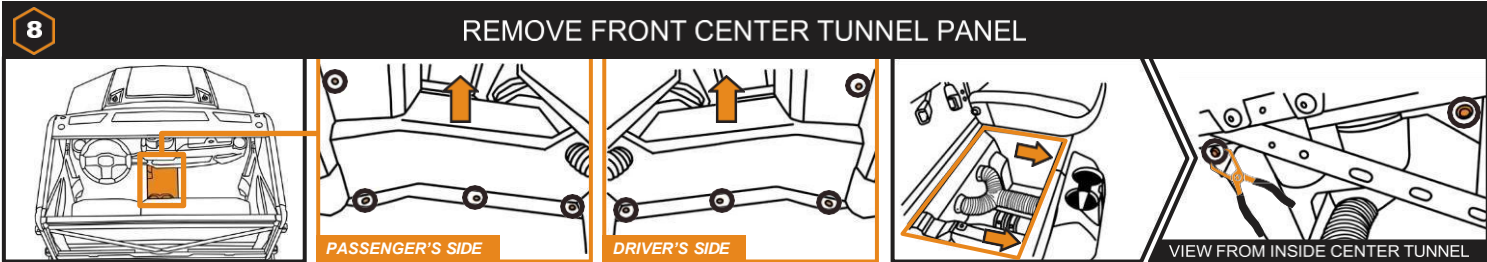

MOUNT APEX LIGHTS TO BUMPER

IDENTIFY BUMPER INSERTS WITH APEX LIGHTS

PASSENGER-SIDE

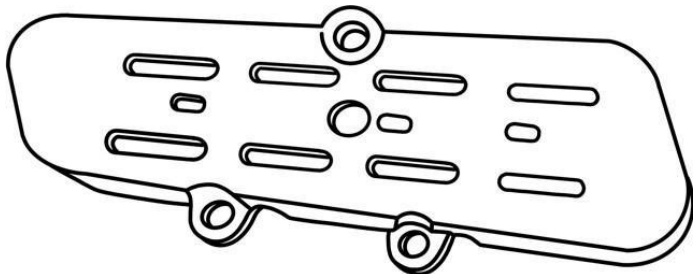

DRIVER-SIDE

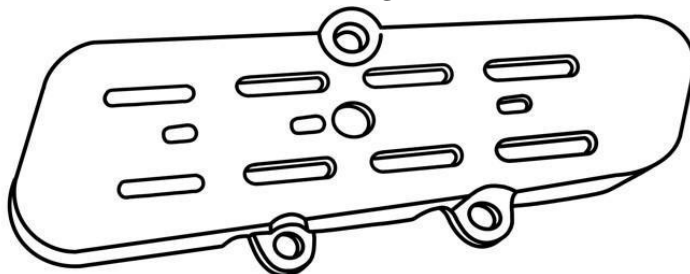

ALIGN INSERT TO BUMPER

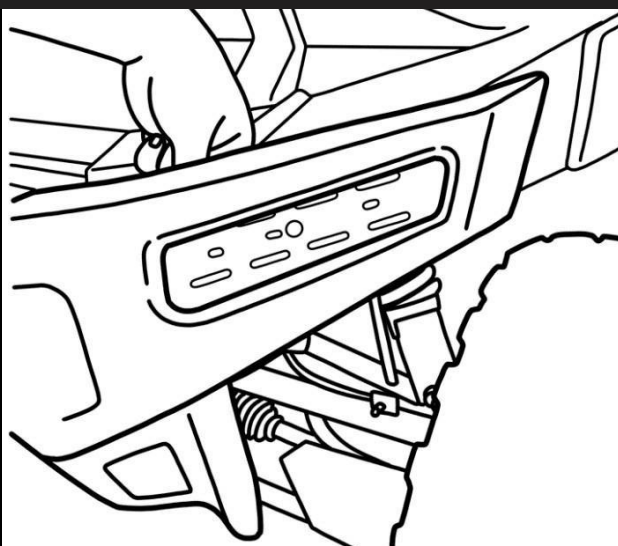
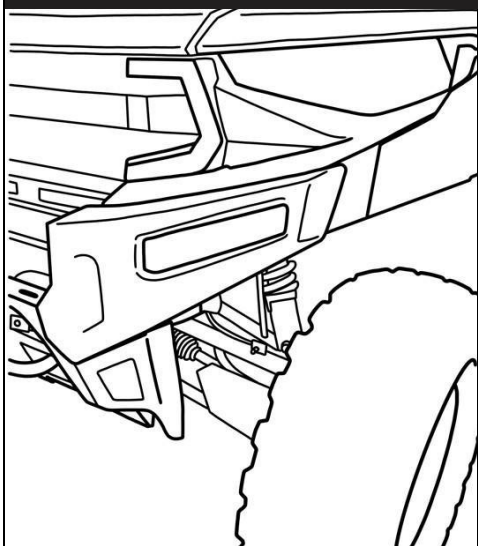

USING SCREW CLIPS AND SCREWS TIGHTEN THE HARDWARE TO MOUNT INSERT TO BUMPER

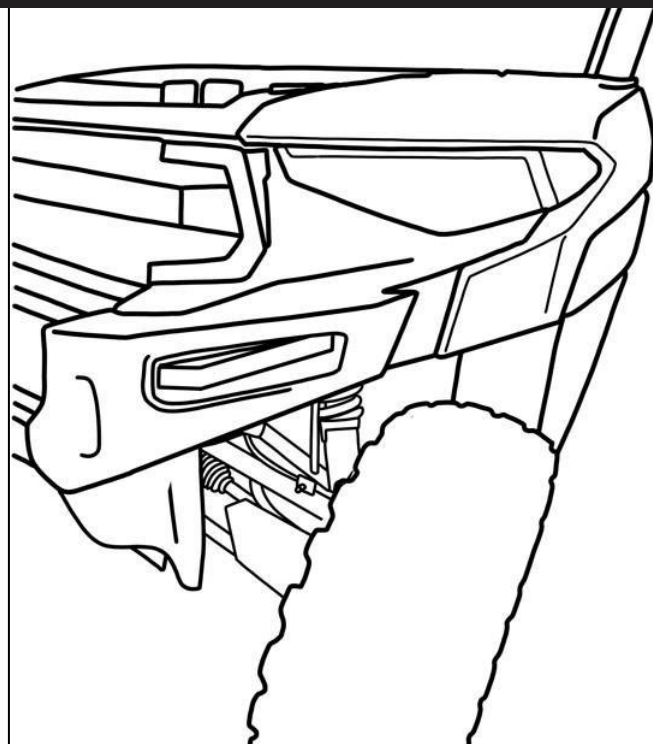
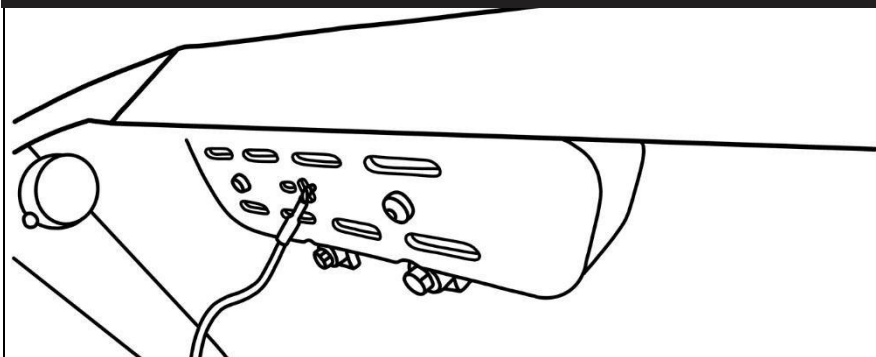

16

PLUG IN POWER HARNESS TO BUS BAR

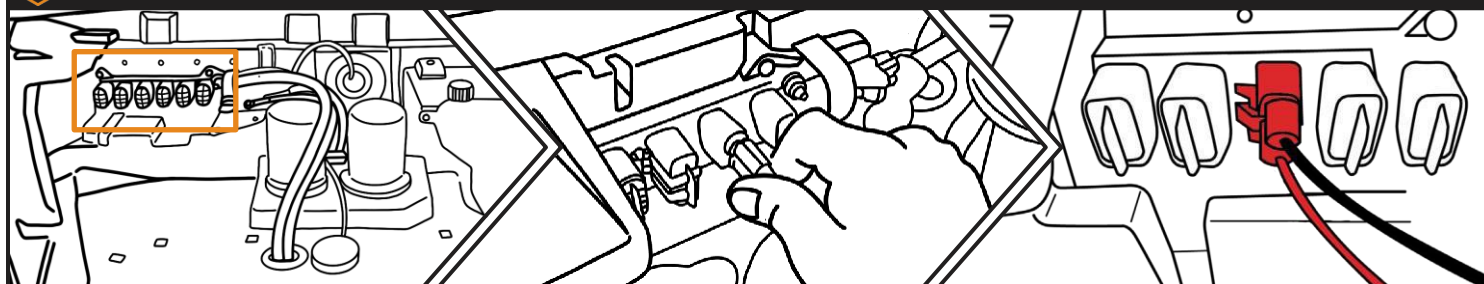

17

PLUG THE REAR HARNESS INLINE WITH CONNECTORS LOCATED UNDERNEATH THE BED

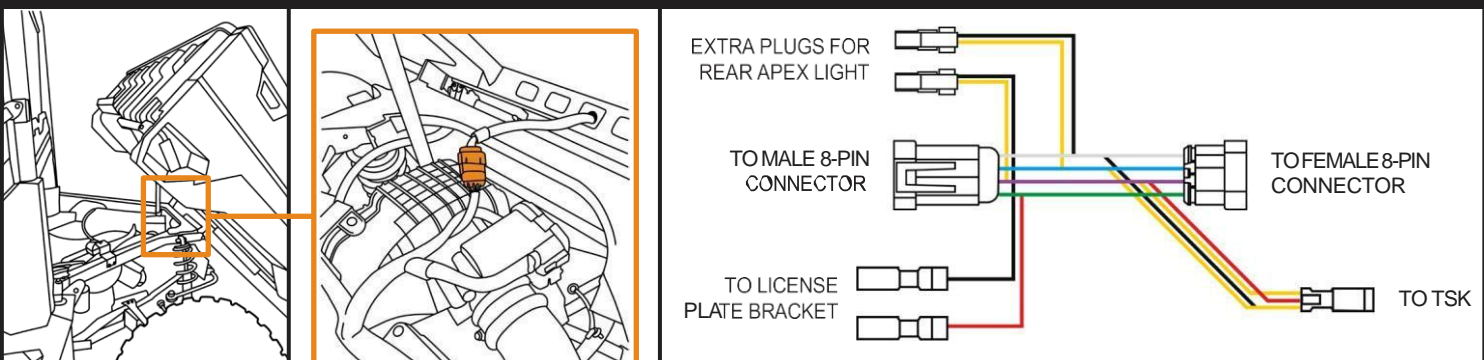

18

REMOVE CONNECTOR COVER

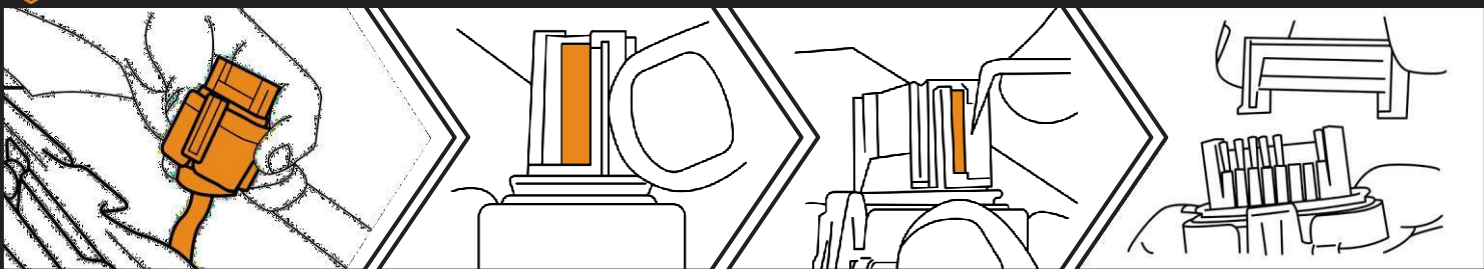

19

OPEN CONNECTOR HOUSING

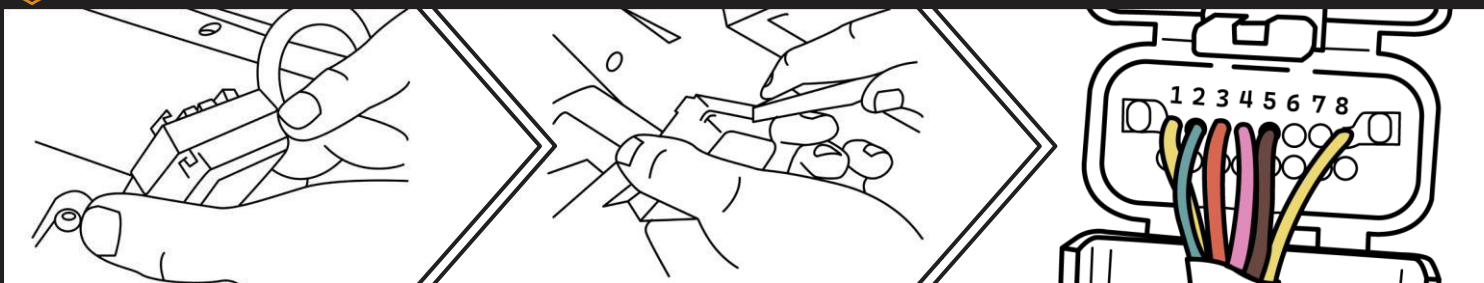

20

REMOVE PLASTIC PIN INSERTS

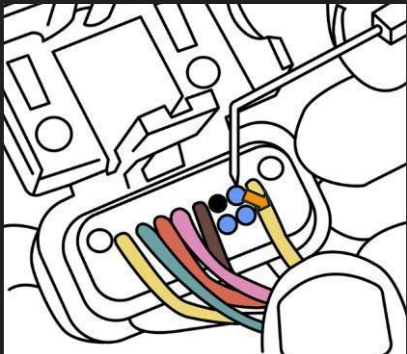

21

RIGHT DI > PIN 6, LEFT DI > PIN 7

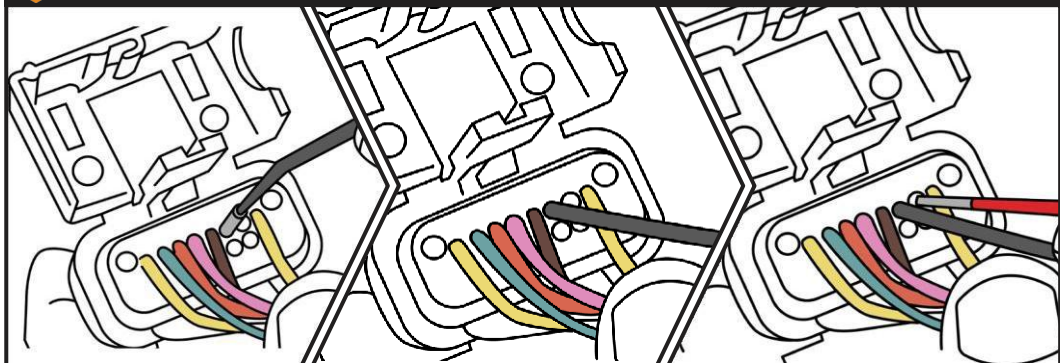

22

ALIGN PINS ON CONNECTOR

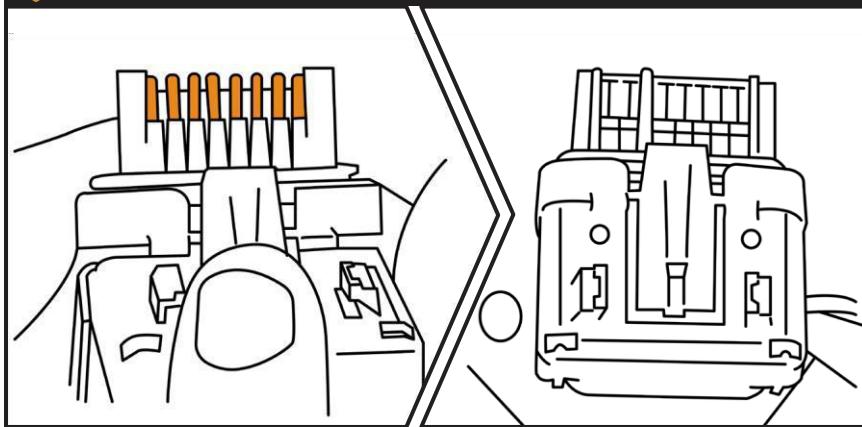

23

INSTALL HORN REUSING SCREW UNDERNEATH HOOD

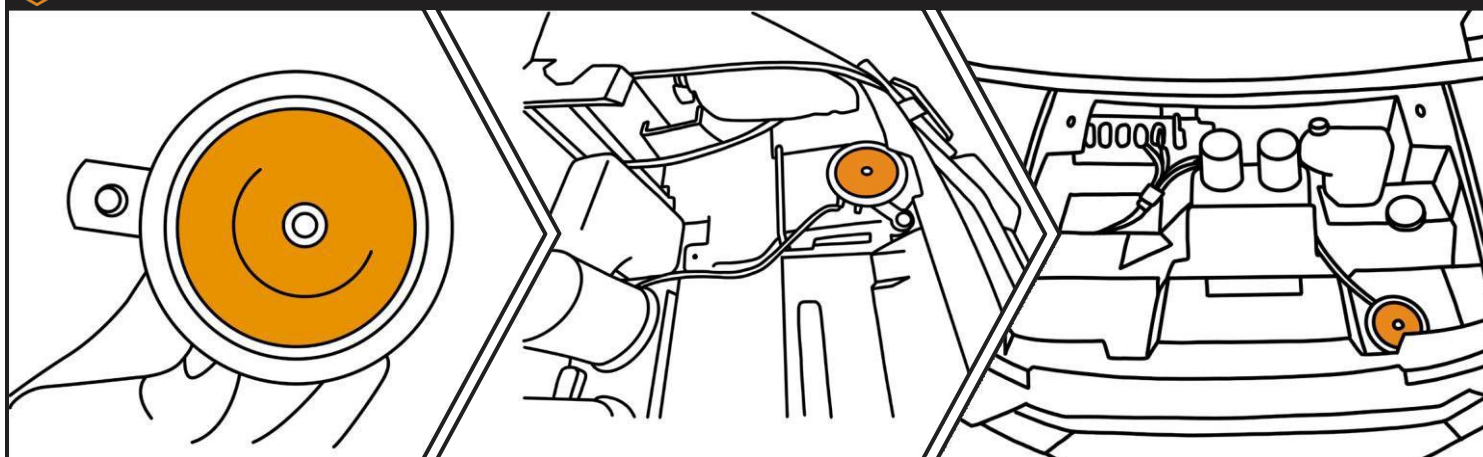

24

TEST YOUR TSK & TIDY UP YOUR MACHINE

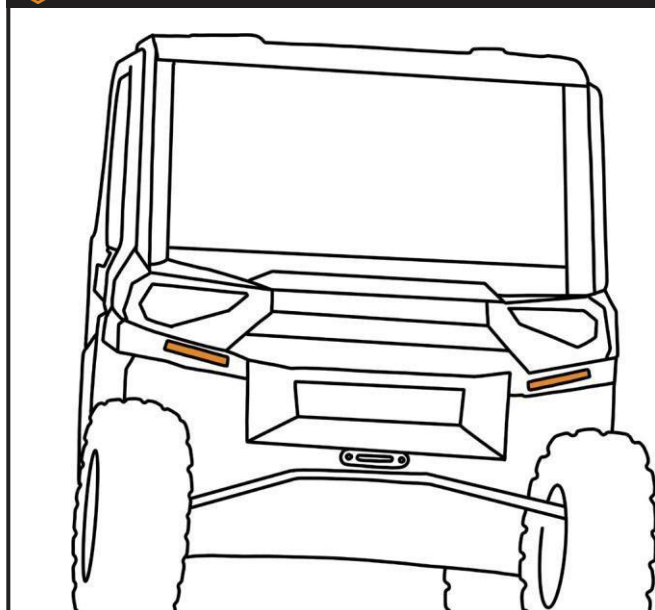

- Running brake lights
- Running white lights
- Brake light w/ pulse effect
- Left turn signal:
 - Push Once: Activates a 20-second auto-cancel timer.
 - Push Twice: Extends the timer to 40 seconds.
 - Push Three Times: Sets the timer to 90 seconds.
- Left turn signal dash indicator
- Right turn signal:
 - Push Once: Activates a 20-second auto-cancel timer.
 - Push Twice: Extends the timer to 40 seconds.
 - Push Three Times: Sets the timer to 90 seconds.
- Right turn signal dash indicator
- Hazards
- Horn

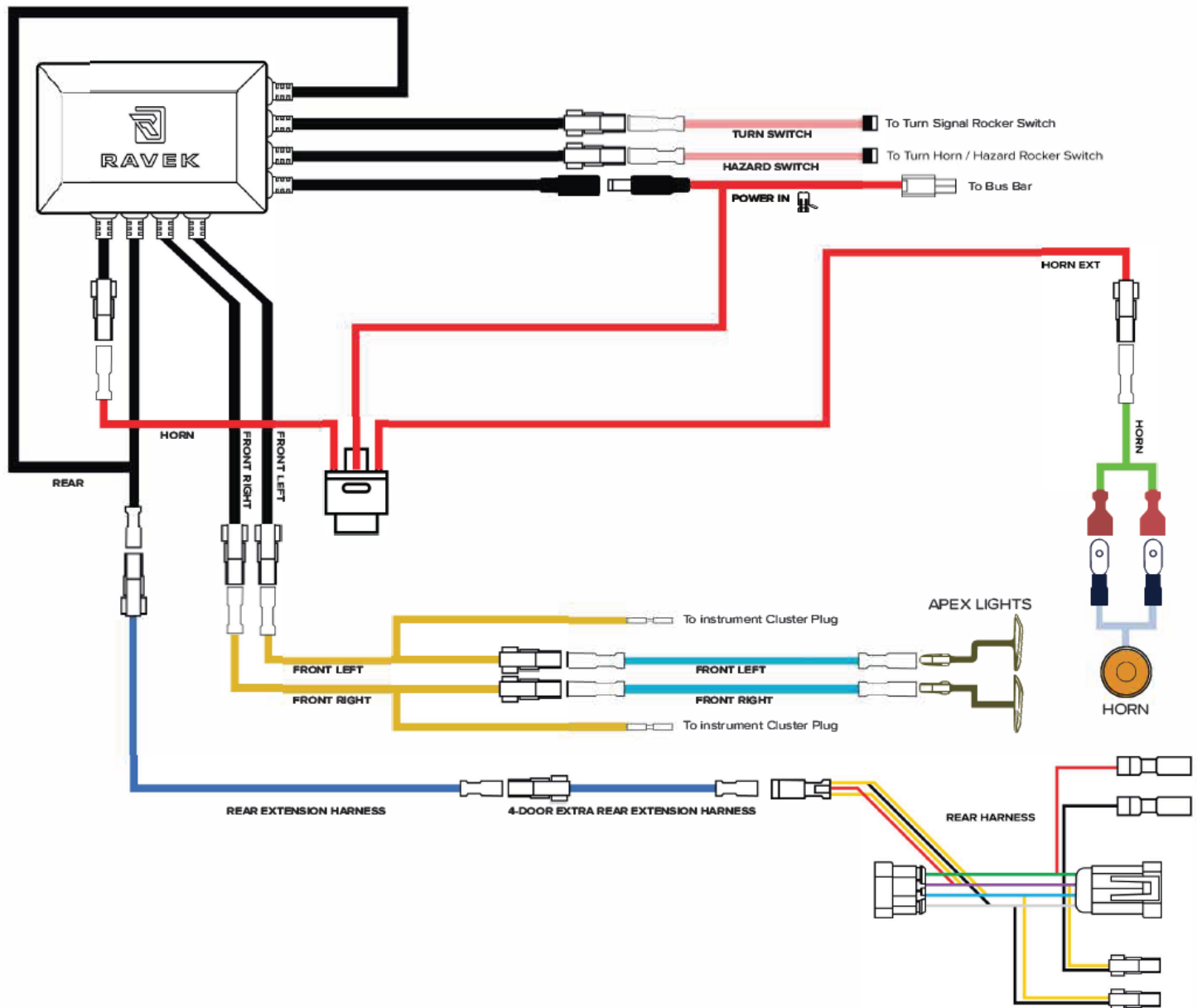



WHY RAVEK

Stock UTVs don't come with enough storage, lighting, comfort, and protection. That's why we started RAVEK.

We live to design, manufacture, and test innovative SxS upgrades that elevate the riding experience. Here's what you can expect from us:

- Durable products built to last (100% lifetime guarantee)
- UTV upgrades thoughtfully designed & tested by riders
- Outstanding installation support (videos & USA customer service)
- Constant flow of epic riding content (check out our social media)

We're confident your RAVEK product will earn its place on your machine. Please call or e-mail us if we can help.

- Harry & Ricky (Brothers & Owners)

MESSAGE FROM THE DESIGNER

All UTVs come without turn signals, and even though you can ride them on the road, people need to make hand signals to indicate to other riders that you are making a turn! Not only is it tiring, but not safe!

That is why I created this kit: you can easily install a turn signal kit to your UTV, add some personality to your ride, and make your ride safe at any time of the day.